



Removable terminal 3-pole, screw terminals up to maximal 2 x 1.5 mm² or 1 x 2.5 mm², For SIRIUS devices in industrial standard mounting rail enclosure

product brand name	SIRIUS
product category	Removable terminals
product designation	Terminal for control circuit/3-pole
design of the product	Screw terminal/up to 2 x 1.5 mm ² or 1 x 2.5 mm ²
General technical data	
protection class IP	IP20
Substance Prohibitance (Date)	01.03.2017
type of connectable conductor cross-sections	<ul style="list-style-type: none"> • solid 1x (0.5 ... 2.5 mm²), 2x (0.5 ... 1.5 mm²) • finely stranded with core end processing 1x (0.5 ... 2.5 mm²), 2x (0.5 ... 1.0 mm²) • at AWG cables solid 1x (20 ... 14), 2x (18 ... 16)
width	7.5 mm
Further information	

Information- and Downloadcenter (Catalogs, Brochures,...)

<https://www.siemens.com/ic10>

Industry Mall (Online ordering system)

<https://mall.industry.siemens.com/mall/en/en/Catalog/product?mlfb=3ZY1131-1BA00>

Cax online generator

<http://support.automation.siemens.com/WW/CAXorder/default.aspx?lang=en&mlfb=3ZY1131-1BA00>

Service&Support (Manuals, Certificates, Characteristics, FAQs,...)

<https://support.industry.siemens.com/cs/ww/en/ps/3ZY1131-1BA00>

Image database (product images, 2D dimension drawings, 3D models, device circuit diagrams, EPLAN macros, ...)

http://www.automation.siemens.com/bilddb/cax_de.aspx?mlfb=3ZY1131-1BA00&lang=en

Characteristic: Derating

<https://support.industry.siemens.com/cs/ww/en/ps/3ZY1131-1BA00/manual>

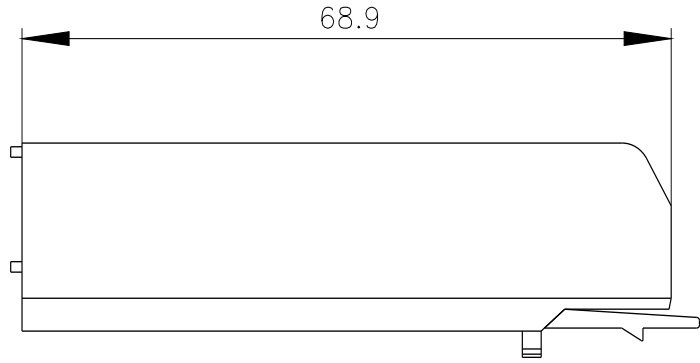
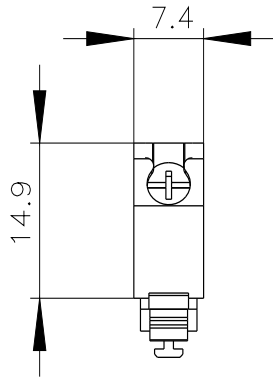

last modified:

1/28/2021 