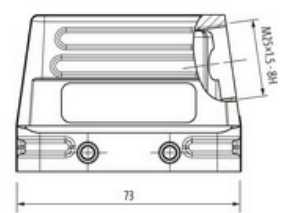
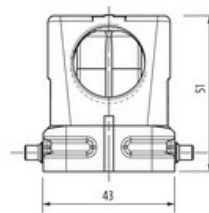

B10 Hood, low profile, IP65

Double locking lever, side entry M25

B10
Hood (low)
Double locking lever
Cable outlet (right angle)
IP65

Technical data will be only guaranteed with Murrelektronik components.

[Link to Product](#)**Illustration**

Product may differ from Image

Technical Data

| | |
|----------------------|--|
| Mating cycles | min. 500 |
| Locking of ports | Double locking lever |
| Protection (housing) | IP65 inserted and tightened (EN 60529), with gland |

General data

| | |
|----------------------------|------------------------|
| Temperature range | -40...+100 °C |
| Material (housing) | Aluminum die-cast |
| Housing type | Hood |
| Threaded hole | M25 |
| Size | B10 |
| Cable outlet | laterally |
| Locking material | Steel (galvanized) |
| Climatic category | 40/100/21 (EN 60068-1) |
| Material (housing surface) | powder-coated |
| Dimensions HxWxD | 51x43x73 mm |

Commercial data

| | |
|-----------------------|---------------|
| country of origin | CZ |
| customs tariff number | 85389099 |
| EAN | 4048879646352 |
| eClass | 27143424 |
| Packaging unit | 1.000 |