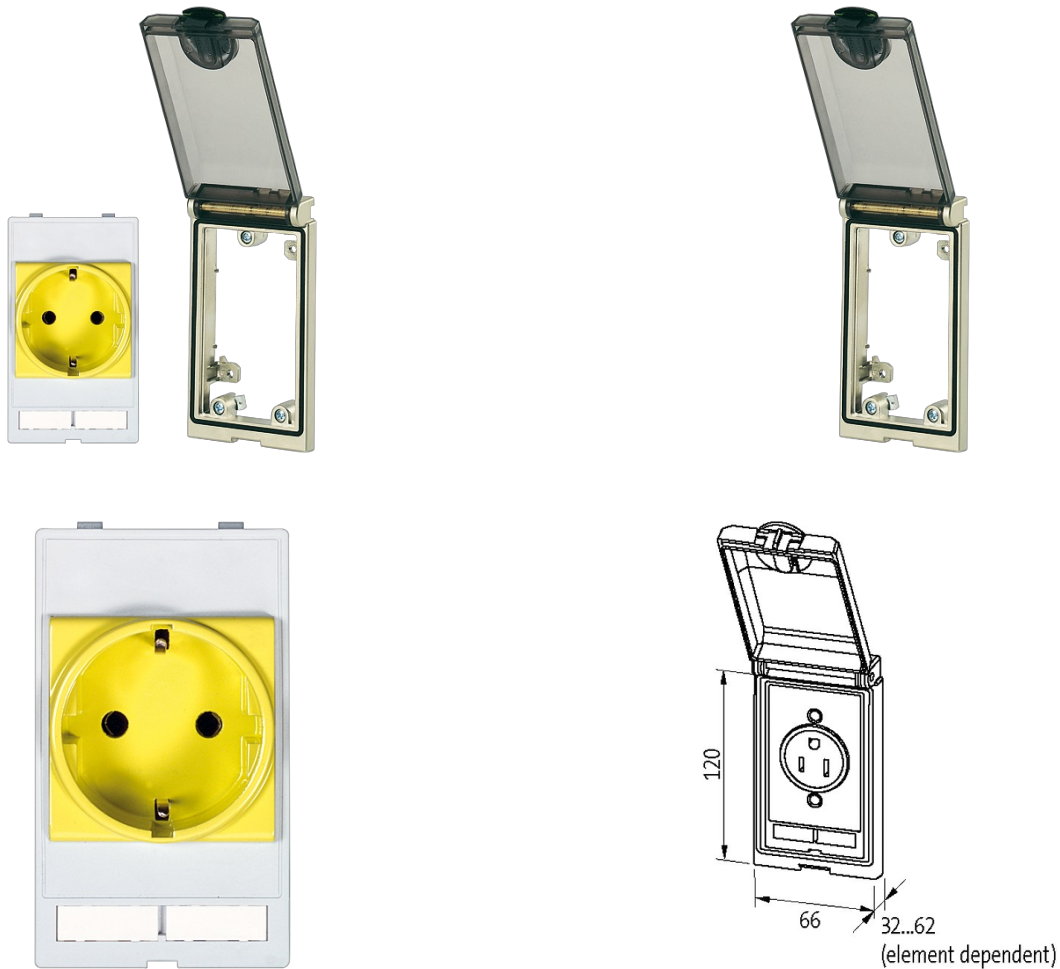

**Modlink MSDD-set: Frame 4000-68213-0000000,**

insert 4000-68000-0020000

[Link to Product](#)**Illustration**

Product may differ from Image

**Frame**

suitable for mounting with wall thickness	1...5 mm
Protection	IP65
Housing	Frame: zinc die-casting, with surface finishing, Lid: plastic, PC transparent
Temperature range	-10...+60 °C (storage temperature -25...+60 °C)

**Germany (VDE)**

Operating voltage	250 V AC
Operating current	16 A
No. of poles	2 + PE
Connection	Screw terminals: max. 2× 6 mm <sup>2</sup> (AWG 10)

**Commercial data**

country of origin	CZ
customs tariff number	85366990
EAN	4048879033541
eClass	27189217

Packaging unit

1