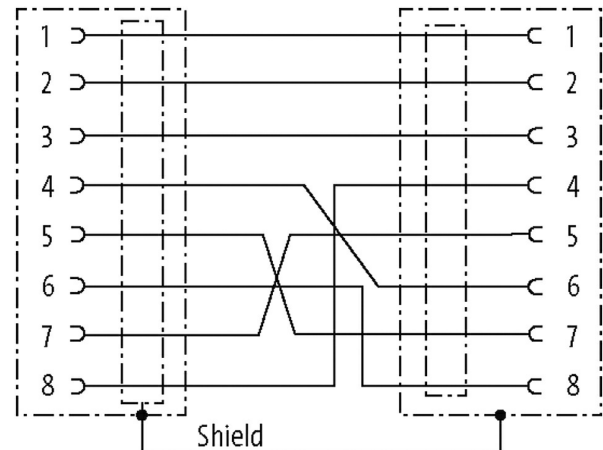
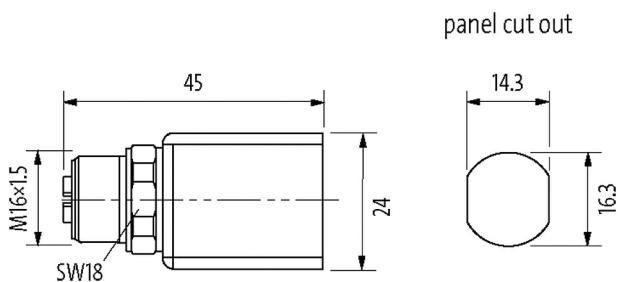
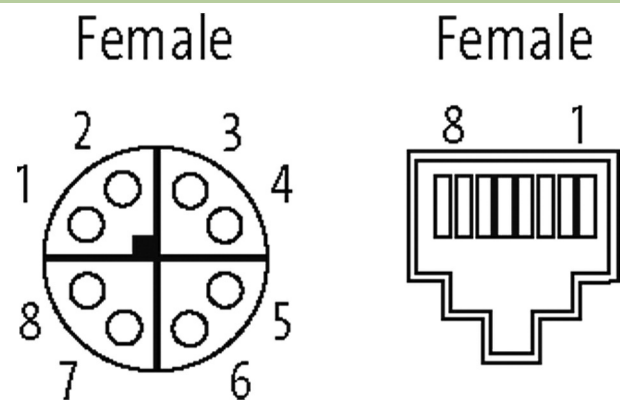

adaptor M12 female x-cod. / RJ45 male 0° Gigabit

Adapter
 M12 – RJ45
 Female straight – female straight
 8-pole
 X-coded
 Gigabit
 Ethernet CAT6A
 shielded
 Cap nut

[Link to Product](#)**Illustration**

Product may differ from Image

Form

Form 51531

Technical Data

Operating current	max. 1.75 A
Transfer parameters	Ethernet CAT6A
Coding	X-coded
Compression gland	M12 (SW18)

General data

Mounting plate thickness 2.1...4.5 mm

Commercial data

country of origin	RO
customs tariff number	85366990
EAN	4048879699402
eClass	27143423
Packaging unit	1