

## MOSA VALVE PLUG FORM CI 9.4 MM FIELD- WIREABLE IDC

Form CI (9.4 mm)

24 V AC/DC  $\pm 25\%$

LED and suppression

Cable outlet can be turned in 90° steps

IDC terminals

Plastic housings with good resistance against chemicals and oils.

The resistance to aggressive media should be individually tested for your application. Further details on request.

### [Link to Product](#)

#### Illustration

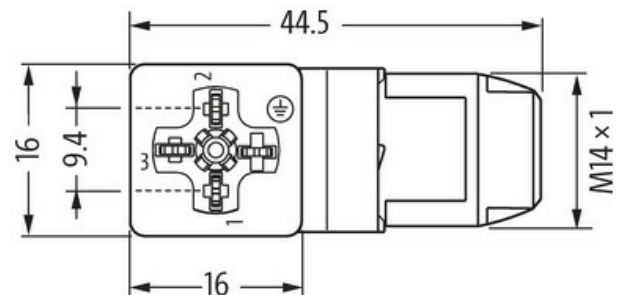
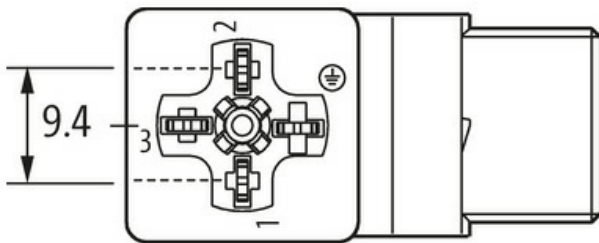
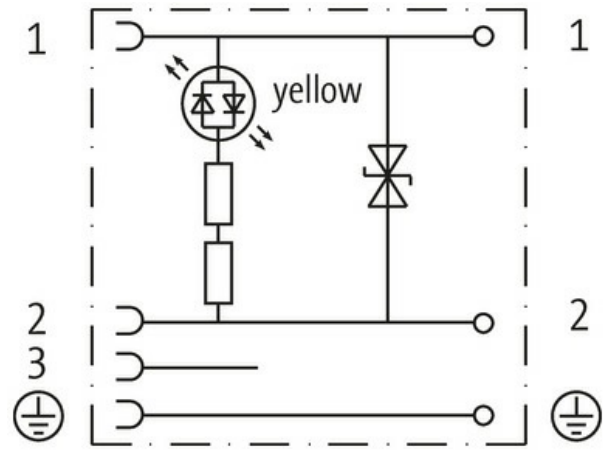

Height: 28 mm

Product may differ from Image

#### Form

Form 94081

#### Technical Data

Operating voltage	24 V AC/DC $\pm 25\%$
Operating current per contact	max. 3 A
Protection	IP65 inserted and tightened (EN 60529)
Configuration	3 contacts + PE

#### General data

Temperature range	-25...+85 °C
Mounting set	M14x1 mm
Dimensions HxWxD	28x16x44.5 mm

#### Commercial data

country of origin	CZ
customs tariff number	85366990
EAN	4048879114448
eClass	27279221
Packaging unit	1.000