



molded case switch 3VA4 UL frame 125 max short-circuit curr. rating 65kA @ 480 V 2-pole MCS110, In=100A without overload protection - self protection li=16 x In

Model	
product brand name	SENTRON
product designation	Molded-case circuit breaker
product designation / according to UL file	HEAB
design of the product	molded case switch
design of the load switch / according to UL 489 / Heating, Air Conditioning, and Refrigeration circuit breaker (HACR Type)	Yes
design of the load switch / according to UL 489 / High-Intensity-Discharge circuit breaker (HID Type)	No
design of the load switch / according to UL 489 / Switching Duty circuit breaker (SWD Type)	No
design of the overcurrent release	MCS110
protection function of the overcurrent release	I
number of poles	2
General technical data	
operating voltage / at AC / rated value	415 V
power loss [W] / maximum	12.3 W
power loss [W] / for rated value of the current / at AC / in hot operating state / per pole	6.2 W
mechanical service life (operating cycles) / typical	15 000
electrical endurance (operating cycles) / at 480 V	8 000
electrical endurance (operating cycles) / at 600 V	4 000
product feature / for neutral conductors / upgradable/retrofitable / short-circuit and overload proof	No
ground-fault monitoring version	Without
product function	
• communication function	No
• other measurement function	No
Net Weight	0.514 kg
Current	
marking / according to UL 489 / 100%-rated breaker	No
operational current	
• at 40 °C	100 A
• at 45 °C	100 A
• at 50 °C	100 A
• at 55 °C	100 A
• at 60 °C	100 A
• at 65 °C	97 A
• at 70 °C	94 A
Switching capacity according to IEC 60947	
design of short-circuit protection	For switching power values in DC networks, see the 3VA molded case circuit breaker device manual; link to be found under Service & Support in the last

chapter

Adjustable parameters

product function / grounding protection No

Mechanical Design

product component

- undervoltage release No
- voltage trigger No
- trip indicator No

height [in] 5.09 in

height 129.4 mm

width [in] 2 in

type of connectable conductor cross-sections / of the round conductor terminal / stranded 1 x (8 AWG - 3/0)

width 50.8 mm

depth [in] 2.96 in

depth 75.1 mm

Connections

arrangement of electrical connectors / for main current circuit output side: circular conductor connection

type of electrical connection / for main current circuit Infeed side: Low tab

design of the surface / of the connections / on the bottom of the switch (N, 2, 4, 6) Tin

Auxiliary circuit

number of CO contacts / for auxiliary contacts 0

Accessories

product extension / optional / motor drive No

Environmental conditions

protection class IP / on the front IP40

ambient temperature

- during operation / minimum -25 °C
- during operation / maximum 70 °C
- during storage / minimum -40 °C
- during storage / maximum 80 °C

Approvals / Certificates

General Product Approval EMV other

[Miscellaneous](#)



[Confirmation](#)

[Miscellaneous](#)

[Miscellaneous](#)

Further information

- Information on the packaging <https://support.industry.siemens.com/cs/ww/en/view/109813875>
- Information- and Downloadcenter (Catalogs, Brochures,...) <http://www.siemens.com/lowvoltage/catalogs>
- Industry Mall (Online ordering system) <https://mall.industry.siemens.com/mall/en/en/Catalog/product?mlfb=3VA4110-1BB24-3AA0>
- Service&Support (Manuals, Certificates, Characteristics, FAQs,...) <https://support.industry.siemens.com/cs/ww/en/ps/3VA4110-1BB24-3AA0>
- Image database (product images, 2D dimension drawings, 3D models, device circuit diagrams, ...) http://www.automation.siemens.com/bilddb/cax_en.aspx?mlfb=3VA4110-1BB24-3AA0
- CAx-Online-Generator <http://www.siemens.com/cax>
- Tender specifications <http://www.siemens.com/specifications>

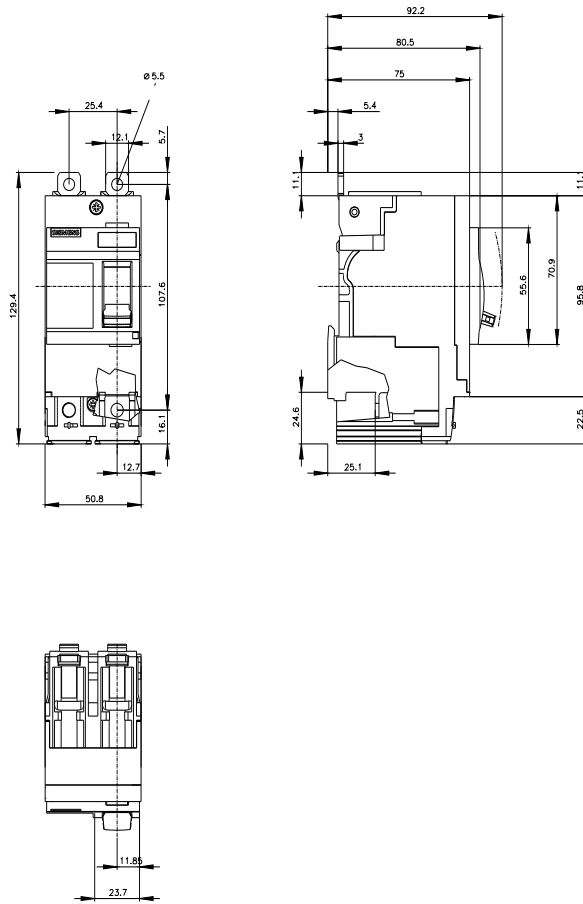

last modified:

4/20/2023 

