



Door-coupling rotary operating mechanism for circuit breaker size S00...S3, black only handle (without trip) and coupling driver

product category	Operating mechanisms		
product designation	door-coupling rotary operating mechanism		
suitability for use	Circuit breaker S00, S0, S2, S3		
General technical data			
certificate of suitability	CE / UL / CSA		
size of the circuit-breaker	S00, S0, S2, S3		
product feature can be locked into OFF position	Yes		
Weight	0.12 kg		
Actuator			
product feature interlock	Yes		
color of the actuating element	gray		
Installation/ mounting/ dimensions			
mounting position	any		
fastening method	screw fixing		
Approvals Certificates			
General Product Approval	Test Certificates	Maritime application	other



[Type Test Certificates/Test Report](#)



[Miscellaneous](#)

other	Environment
-------	-------------



[Confirmation](#)



[Environmental Confirmations](#)

Further information

Information on the packaging
<https://support.industry.siemens.com/cs/ww/en/view/109813875>
 Information- and Downloadcenter (Catalogs, Brochures,...)
<https://www.siemens.com/ic10>
 Industry Mall (Online ordering system)
<https://mall.industry.siemens.com/mall/en/en/Catalog/product?mlfb=3RV2926-1E>
 Cax online generator
<http://support.automation.siemens.com/WWW/CAXorder/default.aspx?lang=en&mlfb=3RV2926-1E>
 Service&Support (Manuals, Certificates, Characteristics, FAQs,...)
<https://support.industry.siemens.com/cs/ww/en/ps/3RV2926-1E>
 Image database (product images, 2D dimension drawings, 3D models, device circuit diagrams, EPLAN macros, ...)
http://www.automation.siemens.com/bilddb/cax_de.aspx?mlfb=3RV2926-1E&lang=en

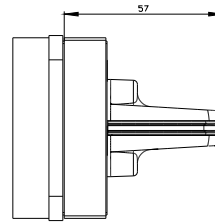
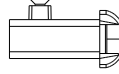
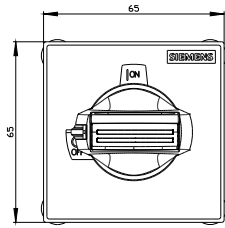

last modified:

4/11/2025 