

## Data sheet for SIMOTICS S-1FS2

Article No. : **1FS2104-6AF07-1MZ0**  
Q0D



Figure similar

Client order no. :  
Order no. :  
Offer no. :  
Remarks :

Item no. :  
Consignment no. :  
Project :

### Basic motor data

Motor type	Permanent-magnet synchronous motor, Natural cooling, IP66/67 IP69K
Static torque	3.10 Nm
Static current	2.75 A
Maximum torque	10.00 Nm
Maximum current	10.9 A
Maximum speed	7,200 rpm
Rotor moment of inertia	0.7200 kgcm <sup>2</sup>
Weight	7.2 kg

### Rated data

SINAMICS S210, 3AC 400V

Rated speed	3,000 rpm
Rated torque	2.55 Nm
Rated current	2.4 A
Rated power	0.80 kW

### Encoder system

Encoder system	Encoder AM22DQC: Absolute encoder 22 bit + 12 bit multitrurn
----------------	--

### Motor connection

Connection type	OCC for S210
Cable outlet	with open ends and direct inverter connection via IX connector
Cable length	2.0 m

### Mechanical data

Design acc. to Code I	IM B5 (IM V1, IM V3)
Vibration severity grade	Grade A
Shaft height	40
Centering ring (N)	70 mm
Hole circle (M)	90 mm
Screw-on hole (S)	6.50 mm
Overall length (LB)	215 mm
Total length (L)	265 mm
Diameter of shaft (D)	19 mm
Length of shaft (E)	40 mm
Flange diameter (P)	110 mm
Shaft end	Fitted key

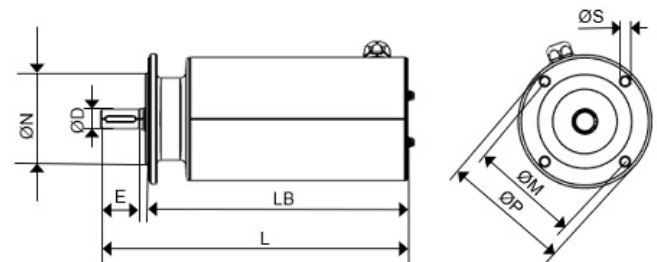

### Special design

Q0D Cable outlet with open ends and direct inverter connection via IX connector, 2.0 m