

## Data sheet for SIMOTICS S-1FS2

Article No. : **1FS2105-6AF17-0MZ0**  
Q1H



Figure similar

Client order no. :  
Order no. :  
Offer no. :  
Remarks :

Item no. :  
Consignment no. :  
Project :

### Basic motor data

Motor type	Permanent-magnet synchronous motor, Natural cooling, IP66/67 IP69K
Static torque	7.60 Nm
Static current	6.20 A
Maximum torque	24.00 Nm
Maximum current	24.0 A
Maximum speed	6,000 rpm
Rotor moment of inertia	3.5800 kgcm <sup>2</sup>
Weight	14.6 kg

### Rated data

SINAMICS S210, 3AC 400V

Rated speed	3,000 rpm
Rated torque	4.10 Nm
Rated current	3.7 A
Rated power	1.29 kW

### Encoder system

Encoder system	Encoder AM22DQC: Absolute encoder 22 bit + 12 bit multitrans
----------------	--

### Motor connection

Connection type	OCC for S210
Cable outlet	with M17 plug for increased chemical resistance
Cable length	4.0 m

### Mechanical data

Design acc. to Code I	IM B5 (IM V1, IM V3)
Vibration severity grade	Grade A
Shaft height	52
Centering ring (N)	95 mm
Hole circle (M)	115 mm
Screw-on hole (S)	9.00 mm
Overall length (LB)	299 mm
Total length (L)	349 mm
Diameter of shaft (D)	19 mm
Length of shaft (E)	40 mm
Flange diameter (P)	135 mm
Shaft end	Plain shaft

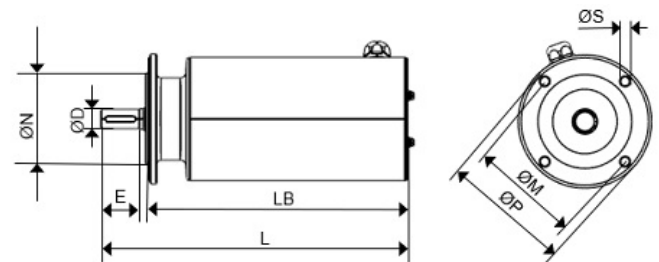

### Holding brake

Holding torque	8.00 Nm
Average dynamic torque	5.00 Nm
Opening time	35 ms
Closing time	15 ms
Maximum single switching energy <sup>1)</sup>	570.0 J
Service life, operating energy	284,000 J
Holding current <sup>2)</sup>	0.30 A
Break-induced current for 500 ms <sup>2)</sup>	1.10 A

### Special design

Q1H Cable outlet with plug for increased chemical resistance, 4.0 m

<sup>1)</sup>Up to three consecutive emergency stops and up to 25% of all emergency stops as a Wmax high energy stop possible.

<sup>2)</sup>Typical value for 20°C ambient temperature. At -15°C the break-induced currents can be increased by up to 30%.