

Data sheet for SIMOTICS S-1FS2

Article No. : **1FS2106-6AF07-0MZO**
Q1X



Figure similar

Client order no. :
Order no. :
Offer no. :
Remarks :

Item no. :
Consignment no. :
Project :

Basic motor data

Motor type	Permanent-magnet synchronous motor, Natural cooling, IP66/67 IP69K
Static torque	14.00 Nm
Static current	12.40 A
Maximum torque	42.00 Nm
Maximum current	44.0 A
Maximum speed	6,000 rpm
Rotor moment of inertia	9.0300 kgcm ²
Weight	18.6 kg

Rated data

SINAMICS S210, 3AC 400V

Rated speed	3,000 rpm
Rated torque	6.20 Nm
Rated current	6.0 A
Rated power	1.95 kW

Encoder system

Encoder system	Encoder AM22DQC: Absolute encoder 22 bit + 12 bit multiturn
----------------	---

Motor connection

Connection type	OCC for S210
Cable outlet	with M23 plug for increased chemical resistance
Cable length	11.0 m

Mechanical data

Design acc. to Code I	IM B5 (IM V1, IM V3)
Vibration severity grade	Grade A
Shaft height	63
Centering ring (N)	110 mm
Hole circle (M)	130 mm
Screw-on hole (S)	9.00 mm
Overall length (LB)	265 mm
Total length (L)	325 mm
Diameter of shaft (D)	24 mm
Length of shaft (E)	50 mm
Flange diameter (P)	158 mm
Shaft end	Plain shaft

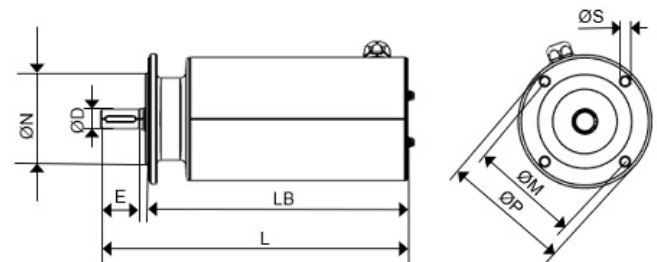

Special design

Q1X Cable outlet with plug for increased chemical resistance, 11.0 m