

Data sheet for SIMOTICS S-1FS2

Article No. : **1FS2104-6AF17-1MZ0**
Q0V



Figure similar

Client order no. :
Order no. :
Offer no. :
Remarks :

Item no. :
Consignment no. :
Project :

Basic motor data

Motor type	Permanent-magnet synchronous motor, Natural cooling, IP66/67 IP69K
Static torque	3.10 Nm
Static current	2.75 A
Maximum torque	10.00 Nm
Maximum current	10.9 A
Maximum speed	7,200 rpm
Rotor moment of inertia	0.8000 kgcm ²
Weight	8.7 kg

Rated data

SINAMICS S210, 3AC 400V

Rated speed	3,000 rpm
Rated torque	2.55 Nm
Rated current	2.4 A
Rated power	0.80 kW

Encoder system

Encoder system	Encoder AM22DQC: Absolute encoder 22 bit + 12 bit multitrans
----------------	--

Motor connection

Connection type	OCC for S210
Cable outlet	with open ends and direct inverter connection via IX connector
Cable length	10.0 m

Mechanical data

Design acc. to Code I	IM B5 (IM V1, IM V3)
Vibration severity grade	Grade A
Shaft height	40
Centering ring (N)	70 mm
Hole circle (M)	90 mm
Screw-on hole (S)	6.50 mm
Overall length (LB)	259 mm
Total length (L)	309 mm
Diameter of shaft (D)	19 mm
Length of shaft (E)	40 mm
Flange diameter (P)	110 mm
Shaft end	Fitted key

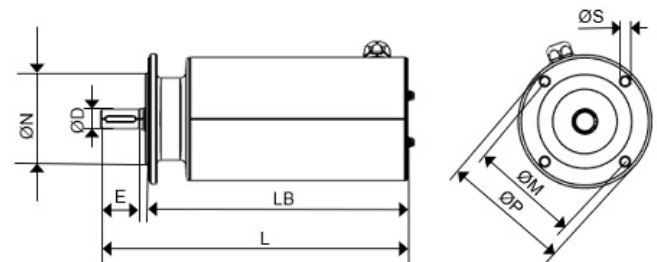

Holding brake

Holding torque	3.30 Nm
Average dynamic torque	3.30 Nm
Opening time	50 ms
Closing time	40 ms
Maximum single switching energy ¹⁾	270.0 J
Service life, operating energy	120,000 J
Holding current ²⁾	0.20 A
Break-induced current for 500 ms ²⁾	1.20 A

Special design

Q0V Cable outlet with open ends and direct inverter connection via IX connector, 10.0 m

¹⁾Up to three consecutive emergency stops and up to 25% of all emergency stops as a Wmax high energy stop possible.

²⁾Typical value for 20°C ambient temperature. At -15°C the break-induced currents can be increased by up to 30%.