

Accessory 3WA/3WL Closing coil (CC) 5% OP, 24-30 V DC momentary duty, with cut-off switch, not for continuous duty

Model	
product brand name	SENTRON
product designation	Closing coil
design of the product	closing coil (CC) 5% OP, 24 to 30 V DC for momentary duty, with cut-off switch, no continuous duty possible
design of the fuse link	fuse gG: 10 A, miniature circuit breaker C characteristic: 10 A
closing active power [W]	300 W
minimum command time at Us = 100%	60 ms
make time (electrical) of circuit breaker at Us = 100%	50 ms
Net Weight	900 g
ambient temperature during operation	
• minimum	-40 °C
• maximum	70 °C
ambient temperature during storage	
• minimum	-40 °C
• maximum	80 °C

Approvals Certificates		
General Product Approval	EMV	Test Certificates



[Miscellaneous](#)

Test Certificates	Maritime application	other
-------------------	----------------------	-------

[Type Test Certificates/Test Report](#)

[Special Test Certificate](#)



[Confirmation](#)

Further information

Information on the packaging

<https://support.industry.siemens.com/cs/ww/en/view/109813875>

Information- and Downloadcenter (Catalogs, Brochures,...)

<http://www.siemens.com/lowvoltage/catalogs>

Industry Mall (Online ordering system)

<https://mall.industry.siemens.com/mall/en/en/Catalog/product?mlfb=3WA9111-0AD12>

Service&Support (Manuals, Certificates, Characteristics, FAQs,...)

<https://support.industry.siemens.com/cs/ww/en/ps/3WA9111-0AD12>

Image database (product images, 2D dimension drawings, 3D models, device circuit diagrams, ...)

http://www.automation.siemens.com/bilddb/cax_en.aspx?mlfb=3WA9111-0AD12

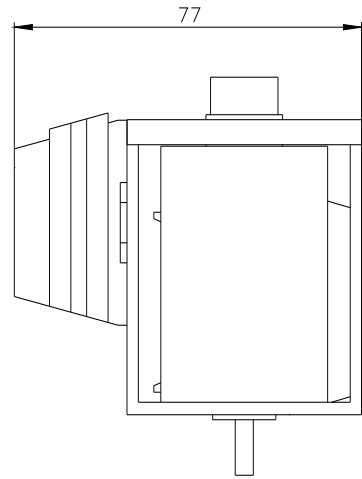
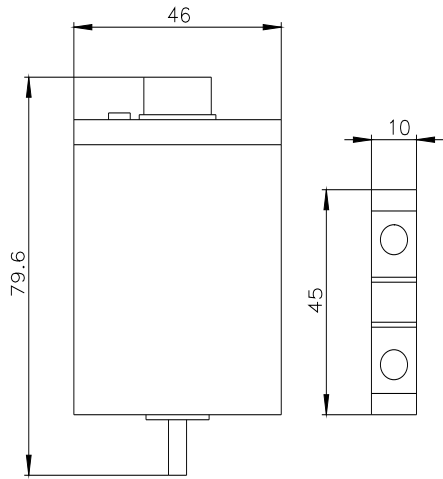

last modified:

8/5/2025 

