

Siemens
EcoTech

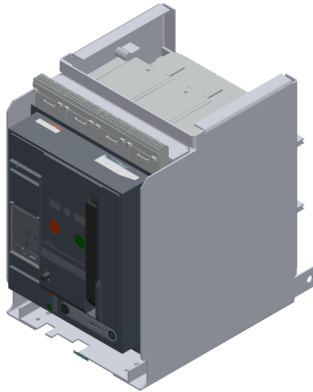

Withdrawable circuit breaker with guide frame, IEC 60947-2, frame size 1, 3-poles, In=800A up to 690V AC 50/60Hz, breaking capacity S Icu=66/50kA at 500/690V, Trip unit ETU300 LSIG optimized for standard applications, without display Protection LT, ST, INST, GF, N-protection required an external N-sensor, incl. trip alarm switch (1xCO), rear connection horizontal, guide frame with shutter and w/o position signalling switch, without Com & metering function Manual operating mechanism with mechanical closing, without Spring charging motor, Ready-to-close signal. switch, Auxiliary switches 2NO+2NC, without Closing coil (CC), manual operating mechanism with mechanical closing, without Remote trip alarm reset coil (RR), without 2nd shunt trip, without 1st Shunt trip



Model	
product brand name	SENTRON
product designation	Air circuit breaker
suitability for use	circuit breaker
size of the circuit-breaker	I
number of poles	3
position / of neutral conductor	no internal N-conductor
fastening method	withdrawable circuit breaker
design of the product	AC application
type of the driving mechanism	manual operating mechanism with mechanical or electrical closing
design of the electronic trip unit	ETU300 LSIG
Weight	75.873 kg
Net Weight	62.873 kg
General technical data	
insulation voltage / rated value	1000 V
operating voltage / at AC / at 50/60 Hz / rated value	690 V
power loss [W] / maximum	85 W
Current	
continuous current / rated value / maximum	800 A
continuous current / rated value	800 A
operational current	
• at 40 °C / rated value	800 A
• at 45 °C / rated value	800 A
• at 50 °C / rated value	800 A
• at 55 °C / rated value	800 A
• at 60 °C / rated value	800 A
• at 65 °C / rated value	800 A
• at 70 °C / rated value	800 A
Switching capacity and short-time withstand current, according to IEC 60947-2	
switching capacity class of the circuit breaker	S
maximum short-circuit current breaking capacity (Icu)	
• at 500 V / rated value	66 kA
• at 690 V / rated value	50 kA
operating short-circuit current breaking capacity (Ics)	
• at 500 V / rated value	66 kA
• at 690 V / rated value	50 kA
short-circuit current making capacity (Icm)	

<ul style="list-style-type: none"> • at 500 V / rated value • at 690 V / rated value 	<p>145 kA 105 kA</p>
<p>short-time withstand current (I_{cw}) / at 500 V AC</p> <ul style="list-style-type: none"> • for 0.5 s / rated value • for 1 s / rated value • for 2 s / rated value • for 3 s / rated value 	<p>66 kA 66 kA 45 kA 35 kA</p>
<p>short-time withstand current (I_{cw}) / at 690 V AC</p> <ul style="list-style-type: none"> • for 0.5 s / rated value • for 1 s / rated value • for 2 s / rated value • for 3 s / rated value 	<p>50 kA 50 kA 45 kA 35 kA</p>

Electronic release unit

product feature	
<ul style="list-style-type: none"> • upgradable • Bluetooth and USB interface • decoder for basic protection functions • display and function keys • SENTRON powerconfig configuration software 	<p>No No Yes No No</p>

Basic protection functions

product feature / for L-tripping	
<ul style="list-style-type: none"> • can be switched on/off • selectable characteristic function • decoder and infinite adjustability are selectable with eSet 	<p>No No No</p>
set values setting current (I _r) / for L-tripping / with I _{2t} characteristic	0.4;0.5;0.6;0.7;0.75;0.8;0.85;0.9;0.95;1.0
reference value setting current (I _r) / for L-tripping / with I _{2t} characteristic	x I _n
set values delay time (t _r) / for L-tripping / with I _{2t} characteristic	0.75;1;2;5;8;10;14;17;21;25
reference value delay time (t _r) / for L-tripping / with I _{2t} characteristic	s
L: Overload protection N-conductor	
product feature / with neutral conductor protection / can be switched on/off	No
setting values setting current (I _{nN}) / for N-tripping	1
reference value setting current (I _{nN}) / for N-tripping	x I _n
S: delayed short-circuit protection ST	
product feature / for S-tripping	
<ul style="list-style-type: none"> • independent of direction / can be switched on/off • independent of direction / selectable characteristic function • decoder and infinite adjustability are selectable with eSet 	<p>Yes Yes No</p>
S: delayed short-circuit protection ST, settings values I_{0t}	
set values setting current (I _{sd}) / for S-tripping / with I _{0t} characteristic	1.5;2;2.5;3;4;5;6;8;10
reference value setting current (I _{sd}) / for S-tripping / with I _{0t} characteristic	x I _r
set values delay time (t _{sd}) / for S-tripping / with I _{0t} characteristic	0.08;0.15;0.22;0.3;0.4
reference value delay time (t _{sd}) / for S-tripping / with I _{0t} characteristic	s
S: delayed short-circuit protection ST, settings values I_{2t}	
set values setting current (I _{sd}) / for S-tripping / with I _{2t} characteristic	1.5;2;2.5;3;4;5;6;8;10
reference value setting current (I _{sd}) / for S-tripping / with I _{2t} characteristic	x I _r
set values delay time (t _{sd}) / for S-tripping / with I _{2t} characteristic	0.08;0.15;0.22;0.3;0.4
product feature / for I-tripping	
<ul style="list-style-type: none"> • can be switched on/off • decoder and infinite adjustability are selectable (with eSet) 	<p>No No</p>
set values setting current (I _i) / for I-tripping	1.5;2;3;4;5;6;8;10;12;15
reference value setting current (I _i) / for I-tripping	x I _n
G: ground fault GF	
product feature / for G-tripping	

<ul style="list-style-type: none"> • can be switched on/off 	No		
<ul style="list-style-type: none"> • selectable characteristic function 	No		
set values setting current (I _g) / for G-tripping / with I0t characteristic	0,2		
reference value setting current (I _g) / for G-tripping / with I0t characteristic	x I _n		
set values delay time (t _g) / for G-tripping / with I0t characteristic	0.2		
reference value delay time (t _g) / for G-tripping / with I0t characteristic	s		
Further protective functions			
protection function			
<ul style="list-style-type: none"> • maintenance mode DAS+ 	Yes		
Measuring functions			
measurement function			
<ul style="list-style-type: none"> • current measurement 	Yes		
Communication			
communication function	No		
Service Life			
mechanical service life (operating cycles)			
<ul style="list-style-type: none"> • without support / typical 	15000		
<ul style="list-style-type: none"> • with support / typical 	30000		
electrical endurance (operating cycles)			
<ul style="list-style-type: none"> • at 690 V / without support / typical 	10000		
<ul style="list-style-type: none"> • at 690 V / with support / typical 	30000		
Dimensions			
height	468 mm		
width	320 mm		
depth	471 mm		
Main connection			
arrangement of electrical connectors / for main current circuit	main connection on the rear, horizontal		
Auxiliary circuit			
design of the auxiliary switch	2 NO + 2 NC		
number of NC contacts / for auxiliary contacts	2		
number of NO contacts / for auxiliary contacts	2		
number of CO contacts / for auxiliary contacts	0		
Internal accessories			
product component			
<ul style="list-style-type: none"> • undervoltage release 	No		
<ul style="list-style-type: none"> • voltage trigger 	No		
<ul style="list-style-type: none"> • trip indicator 	Yes		
<ul style="list-style-type: none"> • motor drive 	No		
Environmental conditions			
protection class IP / on the front	IP20		
ambient temperature / during operation			
<ul style="list-style-type: none"> • minimum 	-40 °C		
<ul style="list-style-type: none"> • maximum 	70 °C		
ambient temperature / during storage			
<ul style="list-style-type: none"> • minimum 	-40 °C		
<ul style="list-style-type: none"> • maximum 	80 °C		
Environmental footprint			
Siemens Eco Profile (SEP)	Siemens EcoTech		
Certificates			
reference code			
<ul style="list-style-type: none"> • according to IEC 81346-2 	Q		
General Product Approval		EMV	Radio Equipment Type Approval Certificate



[Miscellaneous](#)

Test Certificates	Marine / Shipping	other
-------------------	-------------------	-------

[Special Test Certificate](#)

[Miscellaneous](#)



[Confirmation](#)

other	Dangerous goods	Environment
-------	-----------------	-------------

[Manufacturer Declaration](#)

[Transport Information](#)



Further information

Information on the packaging

<https://support.industry.siemens.com/cs/ww/en/view/109813875>

Industry Mall (Online ordering system)

<https://mall.industry.siemens.com/mall/en/en/Catalog/product?mlfb=3WA1108-3AC32-0AA0>

Service&Support (Manuals, Certificates, Characteristics, FAQs,...)

<https://support.industry.siemens.com/cs/ww/en/ps/3WA1108-3AC32-0AA0>

Image database (product images, 2D dimension drawings, 3D models, device circuit diagrams, ...)

http://www.automation.siemens.com/bilddb/cax_en.aspx?mlfb=3WA1108-3AC32-0AA0

CAx-Online-Generator

<http://www.siemens.com/cax>

Information- and Downloadcenter (catalogues, leaflets,...)

<http://www.siemens.com/energy-automation>

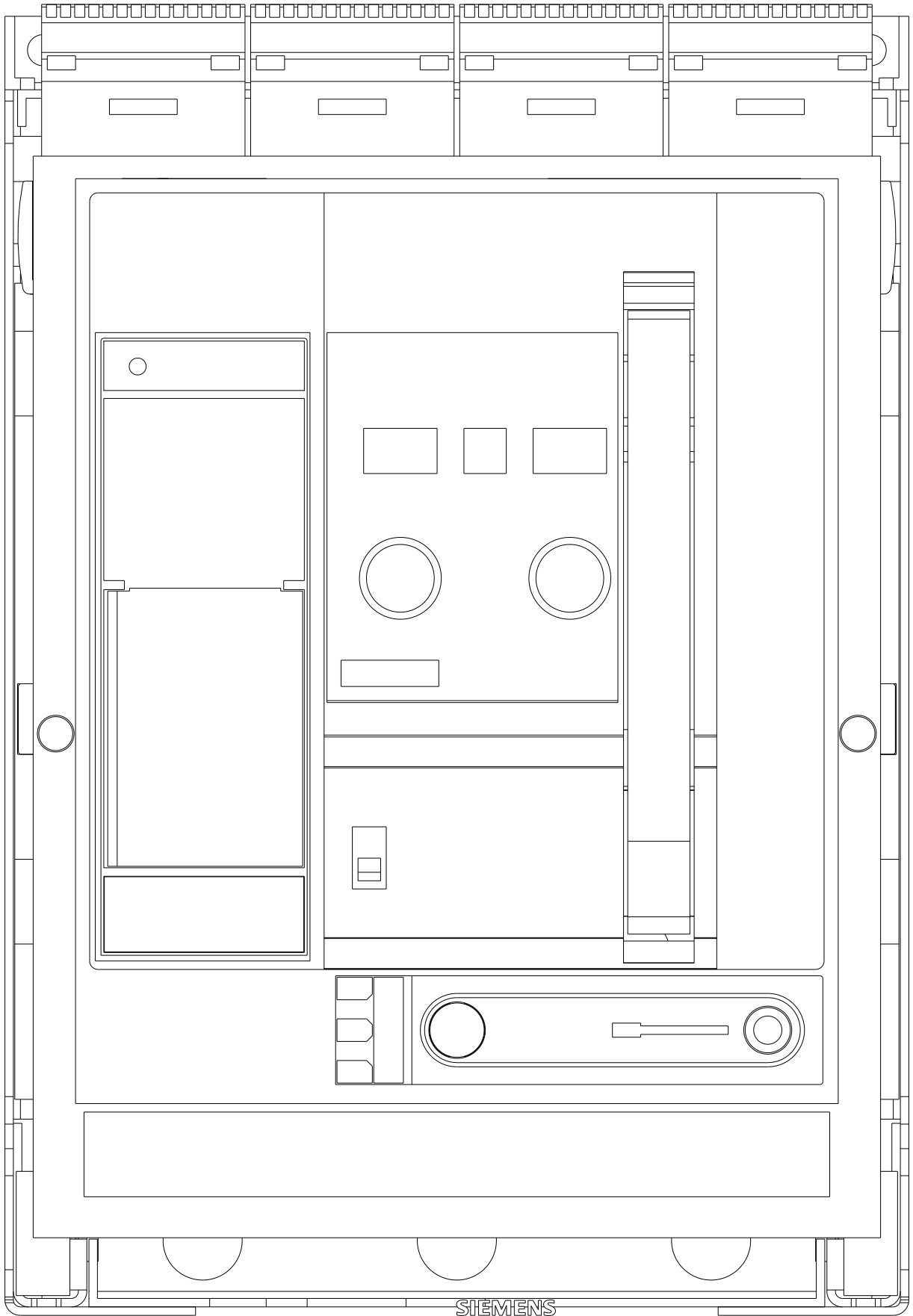

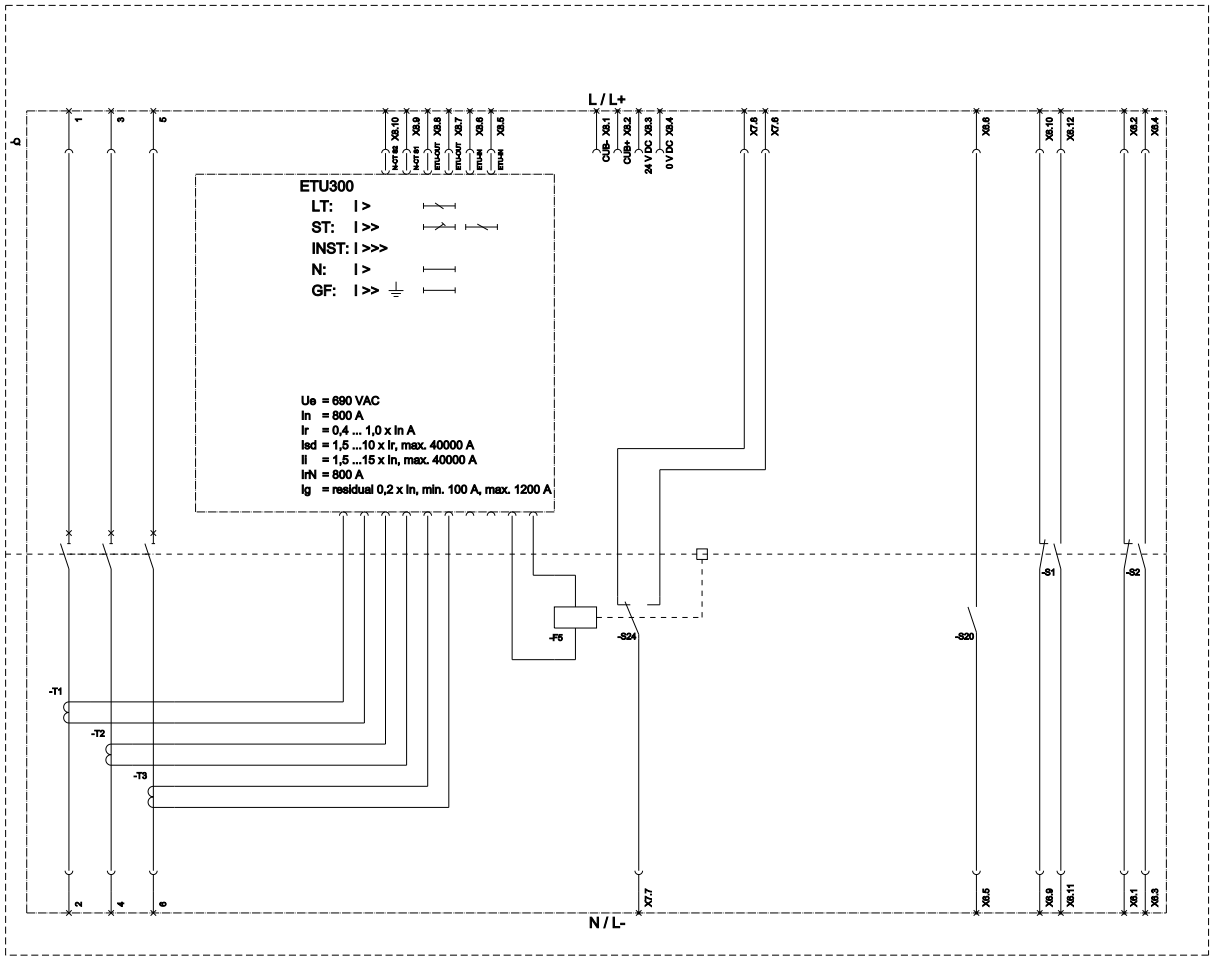

O (Ground Fault Protection / Erdschlussschutz), LT (Long Time Delay / Dichtzeitverzögerung), ST (Short Time Delay / Kurzzeitverzögerung), INST (Instantaneous / Kurzzeitverzögerung), N (Neutral Protection / Neutralleiterchutz),
 GF (Ground Fault Protection / Erdschlusschutz), F5 (Fuse for trip unit / Auslöseorgan), S24 (TAS: last trip alarm switch (Reset Position) / Letzter Auslöseorganrückmeldung (Reset Position)), S1-S8 (AUX: Auxiliary switch / Hilfskontakt),
 S20 (RTCC: Ready to close signalling switch / Bereitschaftsschaltkontakt), T23: position signalling switch module / Positionsmeldemodul.

last modified:

5/5/2025

