



output coupler with plug-in relay, 24 V AC/DC, 1 change-over contact, screw terminal, width 6.2 mm, thermal current 6 A

product brand name	SIRIUS
product category	SIRIUS 3RQ4 coupling relay, narrow design
product designation	Coupling relay with plug-in relay
design of the product	output coupling link
product type designation	3RQ4
manufacturer's article number of coupling relay usable	3RQ4914-7BM00
General technical data	
display version LED	Yes
product feature protective coating on printed-circuit board	No
product component	
• relay output	Yes
• semi-conductor output	No
power loss [W] maximum	0.25 W
consumed active power	0.3 W
insulation voltage for overvoltage category III according to IEC 60664 with degree of pollution 3 rated value	300 V
surge voltage resistance rated value	4 kV
maximum permissible voltage for protective separation	
• between control and auxiliary circuit	300 V
• between control and auxiliary circuit according to IEC 60947-1	300 V
percental drop-out voltage related to the input voltage	10 %
protection class IP	IP20
flammability class of enclosure material	UL94 V-0
shock resistance	
• according to IEC 60068-2-27	sinusoidal half-wave 15g / 11 ms
vibration resistance	
• according to IEC 60068-2-6	6 ... 150 Hz: 2 g
operating frequency maximum	72 000 1/h
switching behavior	monostable
mechanical service life (operating cycles) typical	10 000 000
electrical endurance (operating cycles)	
• at AC-15 at 250 V typical	100 000
thermal current	6 A
reference code according to IEC 81346-2	K
Substance Prohibitance (Date)	09/26/2024
Weight	0.04 kg
Control circuit/ Control	
control supply voltage at AC	
• at 50 Hz rated value	24 V
• at 50 Hz rated value	110 ... 230 V

<ul style="list-style-type: none"> • at 60 Hz rated value 	24 V
<ul style="list-style-type: none"> • at 60 Hz rated value 	110 ... 230 V
control supply voltage frequency	
<ul style="list-style-type: none"> • 1 rated value 	50 Hz
<ul style="list-style-type: none"> • 2 rated value 	60 Hz
control supply voltage at DC rated value	24 V
control supply voltage at DC rated value	110 ... 230 V
operating range factor control supply voltage rated value at DC	
<ul style="list-style-type: none"> • initial value 	0.85
<ul style="list-style-type: none"> • full-scale value 	1.25
operating range factor control supply voltage rated value at AC at 50 Hz	
<ul style="list-style-type: none"> • initial value 	0.8
<ul style="list-style-type: none"> • full-scale value 	1.25
operating range factor control supply voltage rated value at AC at 60 Hz	
<ul style="list-style-type: none"> • initial value 	0.8
<ul style="list-style-type: none"> • full-scale value 	1.25
inrush current maximum	6 A
ON-delay time	
<ul style="list-style-type: none"> • at AC maximum 	10 ms
<ul style="list-style-type: none"> • at DC maximum 	10 ms
OFF-delay time maximum	10 ms
Switching Function	
design of the switching function positively driven	No
Digital Outputs	
property of the output short-circuit proof	No
Mechanical data	
product component plug-in socket	Yes
design of the relay operating mechanism	poled
Short-circuit protection	
design of the fuse link for short-circuit protection of the auxiliary switch required	fuse gG: 4 A
Auxiliary circuit	
material of contact coating	other
material of switching contacts	Silver tin oxide (AgSnO ₂)
material of the contact insert	Thermoplastic
number of NC contacts for auxiliary contacts	0
number of NO contacts for auxiliary contacts	0
number of CO contacts for auxiliary contacts	1
operational current of auxiliary contacts at AC-15	
<ul style="list-style-type: none"> • at 24 V 	3 A
<ul style="list-style-type: none"> • at 250 V 	3 A
operational current of auxiliary contacts at DC-13	
<ul style="list-style-type: none"> • at 24 V 	1 A
<ul style="list-style-type: none"> • at 125 V 	0.2 A
<ul style="list-style-type: none"> • at 250 V 	0.1 A
contact reliability of auxiliary contacts	one incorrect switching operation of 100 million switching operations (17 V, 5 mA)
Main circuit	
type of voltage	AC/DC
ampacity of the output relay at AC-15 at 250 V at 50/60 Hz	3 A
ampacity of the output relay at DC-13	
<ul style="list-style-type: none"> • at 24 V 	1 A
<ul style="list-style-type: none"> • at 125 V 	0.2 A
<ul style="list-style-type: none"> • at 250 V 	0.1 A
Electromagnetic compatibility	
electromagnetic compatibility	acc. to EN 60947-5-1
EMC emitted interference according to IEC 60947-1	ambience A (industrial sector)
EMC immunity according to IEC 60947-1	corresponds to degree of severity 3
conducted interference	



[Confirmation](#)

Environment



Further information

Information on the packaging

<https://support.industry.siemens.com/cs/ww/en/view/109813875>

Information for data generation and storage

<https://support.industry.siemens.com/cs/ww/en/view/109995012>

Information- and Downloadcenter (Catalogs, Brochures,...)

<https://www.siemens.com/ic10>

Industry Mall (Online ordering system)

<https://mall.industry.siemens.com/mall/en/en/Catalog/product?mlfb=3RQ4118-1AB00>

Cax online generator

<http://support.automation.siemens.com/WW/CAXorder/default.aspx?lang=en&mlfb=3RQ4118-1AB00>

Service&Support (Manuals, Certificates, Characteristics, FAQs,...)

<https://support.industry.siemens.com/cs/ww/en/ps/3RQ4118-1AB00>

Image database (product images, 2D dimension drawings, 3D models, device circuit diagrams, EPLAN macros, ...)

http://www.automation.siemens.com/bilddb/cax_de.aspx?mlfb=3RQ4118-1AB00&lang=en

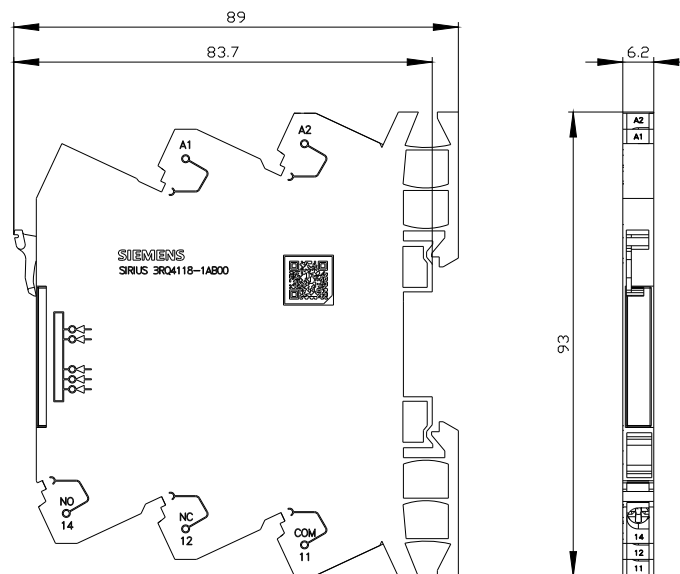

last modified:

10/7/2025