

AC1005



AS-Interface PROFIBUS DP gateway with PLC

Contr 1MSTR 1RS232C 1DP

Article no longer available - archive entry

Alternative articles: AC1027

When selecting an alternative article and accessories please note that technical data may differ!

Replacement units for Krones systems should be obtained directly from the company Krones.

This unit is not directly compatible.

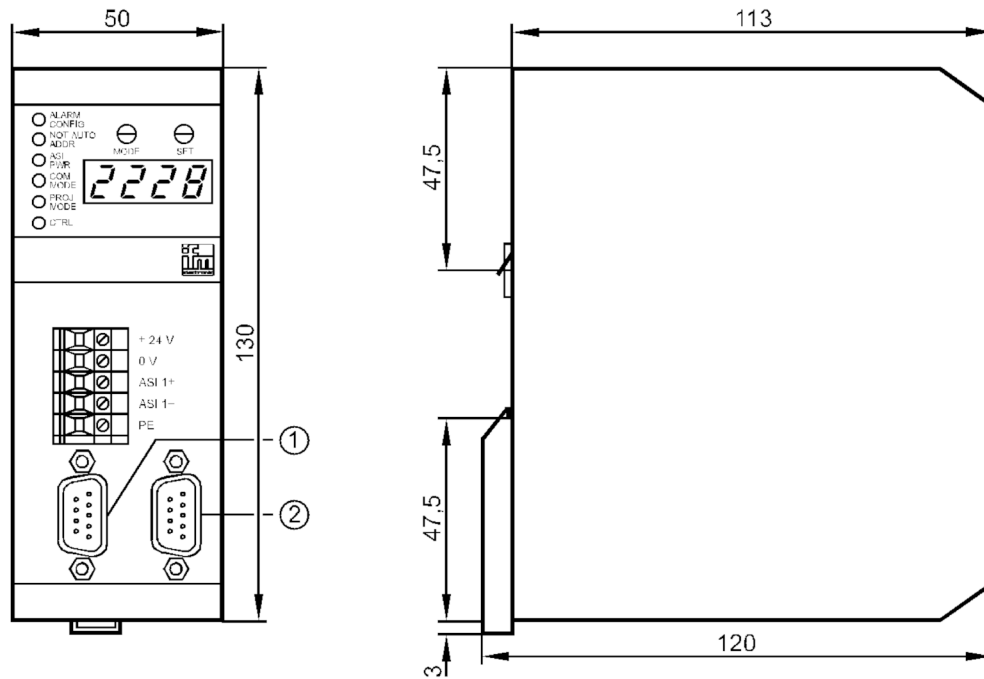

- 1 serial interface RS232C
- 2 PROFIBUS DP interface



Application	
Design	housing for DIN rail mounting
Application	use as minicontroller and gateway
Electrical data	
Operating voltage [V]	22...30 DC; (24 DC ; to PELV)
Insulation rating [V]	500
Max. current consumption from AS-i [mA]	80
Max. power consumption [VA]	10
Electrical separation	yes
Outputs	
Electrical design	AS-i
Interfaces	
Communication interface	RS232
RS232	
Number of R232 interfaces	1

AC1005



AS-Interface PROFIBUS DP gateway with PLC

Contr 1MSTR 1RS232C 1DP

Transmission rate	4800...62400 Baud
Connector type	SUB-D
Usage type	programming

Operating conditions

Ambient temperature [°C]	0...60
Storage temperature [°C]	-20...70
Max. relative air humidity [%]	95
Protection	IP 20

AS-i classification

AS-i master profile	M1
AS-i certificate	22501

Mechanical data

Housing	rectangular
Type of mounting	mounting on DIN rail; (TH35 (EN 60715))
Dimensions [mm]	130 x 50 x 120
Materials	aluminium

Displays / operating elements

Display	function check	2 x LED, red
		2 x LED, green
		2 x LED, yellow

Remarks

Remarks	Replacement units for Krones systems should be obtained directly from the company Krones. This unit is not directly compatible.
Notes	Replacement units for Krones systems should be obtained directly from the company Krones.; This unit is not directly compatible.
Pack quantity	1 pcs.

Electrical connection

screw terminals: 5 x

Connection

5	+ 24 V
4	0 V
3	AS-i 1+
2	AS-i 1-
1	PE