



Figure similar

Overcurrent time protection 7SR51 4 curr. trans., 8 BI, 6 BO Standard interface: 1 x USB (front), RS 485 (rear) + 2 x optical LC interf. S6 enclosure , including conformal coating

Product details	
number of function keys	7
number of LEDs	28
Product Functions	
type of measured value detection / of operational measured value / standard	Yes
type of measured value detection / expanded / min./max. values, mean values	Yes
switching statistics	Yes
circuit breaker monitoring	Yes
product feature / logic editor	Yes
control	Yes
fault recording for analog and digital signals	Yes
sequence-of-events recorder	Yes
monitoring	Yes
number of parameter sets	4
parameter set switchover	Yes
circuit breaker test	Yes
Protection Functions	
three-pole tripping	Yes
synchrocheck (ANSI 25)	No
undervoltage protection (ANSI 27)	No
directional power monitoring (ANSI 32)	No
forward power supervision (ANSI 32F)	No
reverse power protection (ANSI 32R)	No
undercurrent protection (ANSI 37)	Yes
unbalance protection (ANSI 46)	Yes
overcurrent-time protection negative sequence system (ANSI 46)	Yes
phase-rotation supervision (ANSI 47)	No
overvoltage protection negative-sequence system (ANSI 47)	No
thermal overload protection (ANSI 49)	Yes
definite overcurrent-time protection (ANSI 50/50N)	Yes
Switch On To Fault (ANSI SOTF)	Yes
arc protection (ANSI AFD)	Yes
sensitive ground current protection (ANSI 50Ns)	Yes
circuit breaker failure protection (ANSI 50BF)	Yes
dependent overcurrent-time protection (ANSI 51/51N)	Yes
dynamic response value changeover (ANSI 51C)	Yes
voltage-dependent overcurrent-time protection (ANSI 51V)	No

power factor (ANSI 55)	No
overvoltage protection (ANSI 59)	No
overvoltage protection zero-sequence system (ANSI 59N)	No
directional overcurrent-time protection, phases (ANSI 67)	No
directional ground fault protection (ANSI 67N)	No
directional sensitive ground-fault detection for resonant-grounded systems and isolated systems (ANSI 67Ns)	No
trip-circuit supervision (ANSI 74TC)	Yes
automatic reclosing (ANSI 79)	Yes
frequency protection (ANSI 81)	No
frequency variation protection (ANSI 81R)	No
vector step protection	No
closing lock-out (ANSI 86)	Yes
ground fault differential protection (ANSI 87N)	Yes
fault locator (ANSI FL)	No
inrush current detection	Yes
external trip initiation	Yes
Supply voltage	
supply voltage / at AC	100 ... 230 V
supply voltage / at DC	24 ... 250 V
type of voltage / of the supply voltage	AC/DC
Inputs / Outputs	
number of digital inputs / maximum	8
number of digital outputs / incl. signaling contact / maximum	6
number of voltage inputs / maximum	0
number of current inputs / maximum	4
Communication	
product component / operating interface (on the front)	Yes
protocol / is supported / Modbus TCP	Yes
protocol / is supported / IEC 60870-5-103	Yes
protocol / is supported / IEC 61850-8-1	Yes
protocol / is supported / Modbus RTU slave	Yes
protocol / is supported / DNP 3, serial	Yes
protocol / is supported / DNP 3.0 TCP as server	Yes
protocol / is supported / PRP	Yes
protocol / is supported / RSTP	Yes
protocol / is supported / HSR	Yes
Time synchronization	
type of time synchronization	Data comms or Digital input
Mechanical Design	
width	153 mm
height	177 mm
depth	217.5 mm
frame size of enclosure	S6
product function / hardware configuration expandable	No
Environmental conditions	
ambient temperature / during operation	-10 ... +55 °C
Further information	
Siemens is working on the renewal of the current EAC certificates.	
Please contact your local Siemens office on the status of validity of the EAC certification if you intend to import or offer to supply these products to an EAC relevant market (other than the sanctioned EAEU member states Russia or Belarus).	
Information- and Downloadcenter (catalogues, leaflets,...)	
http://www.siemens.com/energy-automation	
Industry Mall (Online ordering system)	
https://mall.industry.siemens.com/mall/en/en/Catalog/product?mlfb=7SR5110-1AA21-1AA0	
Service&Support (Manuals, Certificates, Characteristics, FAQs,...)	
https://support.industry.siemens.com/cs/ww/en/ps/7SR5110-1AA21-1AA0	
Image database (product images, 2D dimension drawings, 3D models, device circuit diagrams, ...)	
http://www.automation.siemens.com/bilddb/cax_en.aspx?mlfb=7SR5110-1AA21-1AA0	
Tender specifications	
http://www.siemens.com/specifications	
Power Academy - Your training and consulting partner in the area of power transmission and distribution	
https://www.siemens.com/poweracademy	

FRONT/VORNE

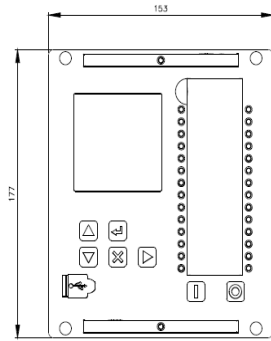

PANEL OUT-OUT/SCHALTAFELAUSSCHNITT

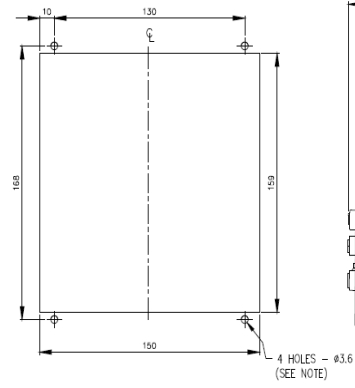

RIGHT/RECHTS

