



HRC fuse base ceramic Sz.00 1-pole 160A 690V (1000V) flat terminal

| Model  |                         |       |
|--|-------------------------|-------|
| product brand name   | SENTRON                 |       |
| product designation  | LV HRC fuse base        |       |
| design of the thread of the nut                                    | M8                      |       |
| design of the thread of the connection screw                       | M8                      |       |
| General technical data   |                         |       |
| number of poles  | 1                       |       |
| size of fuse system according to EN 60269-1                        | NH00                    |       |
| utilization category   | Without                 |       |
| Supply voltage   |                         |       |
| supply voltage   |                         |       |
| • at AC  | 690 V                   |       |
| • at DC  | 690 V                   |       |
| Product details  |                         |       |
| product component swivel-in mechanism                              | No                      |       |
| maximum short-circuit current breaking capacity (I <sub>cu</sub> ) |                         |       |
| • at AC rated value  | 120 kA                  |       |
| • at DC rated value  | 120 kA                  |       |
| Connections  |                         |       |
| connectable conductor cross-section on terminal strip              |                         |       |
| • minimum  | 6 mm <sup>2</sup>       |       |
| • maximum  | 95 mm <sup>2</sup>      |       |
| tightening torque of the screw for securing the equipment maximum  | 6 N·m                   |       |
| tightening torque with screw-type terminals maximum                | 32 N·m                  |       |
| type of electrical connection                                      | With flat-type terminal |       |
| • for main current circuit   | with flat-type terminal |       |
| Mechanical Design  |                         |       |
| height   | 120 mm                  |       |
| width  | 30 mm                   |       |
| depth  | 58.5 mm                 |       |
| fastening method   | fixed mounting          |       |
| fastening method bus-mounting                                      | No                      |       |
| Net Weight   | 189.3 g                 |       |
| Approvals Certificates   |                         |       |
| General Product Approval   | Maritime application    | other |



[Confirmation](#)



[Confirmation](#)

other

Environment



[Environmental Confirmations](#)

Further information

Information on the packaging

<https://support.industry.siemens.com/cs/ww/en/view/109813875>

Information for data generation and storage

<https://support.industry.siemens.com/cs/ww/en/view/109995012>

Information- and Downloadcenter (Catalogs, Brochures,...)

<https://www.siemens.com/lowvoltage/catalogs>

Industry Mall (Online ordering system)

<https://mall.industry.siemens.com/mall/en/en/Catalog/product?mlfb=3NH6030>

Service&Support (Manuals, Certificates, Characteristics, FAQs,...)

<https://support.industry.siemens.com/cs/ww/en/ps/3NH6030>

Image database (product images, 2D dimension drawings, 3D models, device circuit diagrams, ...)

[https://www.automation.siemens.com/bilddb/cax\\_en.aspx?mlfb=3NH6030](https://www.automation.siemens.com/bilddb/cax_en.aspx?mlfb=3NH6030)

CAX-Online-Generator

<https://www.siemens.com/cax>

Tender specifications

<https://www.siemens.com/specifications>

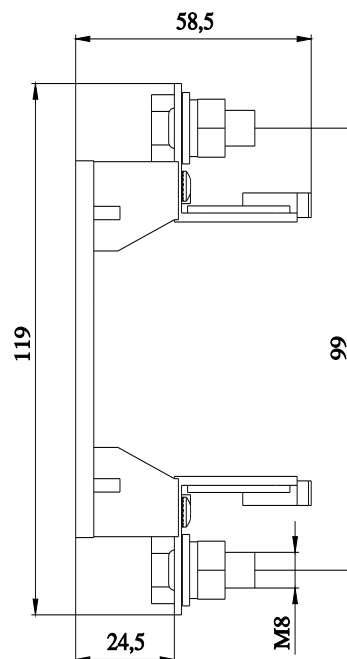
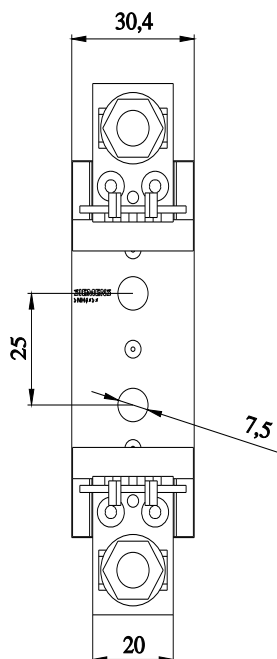

last modified:

8/8/2025



