





---

 PRODUCT-DETAILS

# DCA0012007P0001

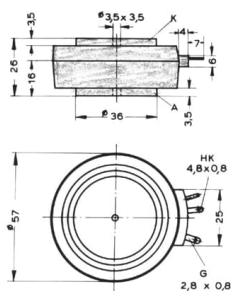
## TYPE: T 459 N 24 TOF; THYRISTOR



---

**General Information**

|                      |                                 |
|----------------------|---------------------------------|
| Product ID           | DCA0012007P0001                 |
| ABB Type Designation | TYPE: T 459 N 24 TOF            |
| Catalog Description  | TYPE: T 459 N 24 TOF; THYRISTOR |
| Long Description     | TYPE: T 459 N 24 TOF            |

---

**Additional Information**

|                                |                      |
|--------------------------------|----------------------|
| ABB Type Designation           | TYPE: T 459 N 24 TOF |
| CN8                            | 85413000             |
| Core Credit                    | 0.00                 |
| Country or Territory of Origin | Hungary<br>Germany   |
| Customs Tariff Number          | 85413000             |
| Frame Size                     | Spare_Parts          |
| Gross Weight                   | 0.3 kg               |
| Invoice Description            | THYRISTOR            |
| Made To Order                  | No                   |
| Minimum Order Quantity         | 1 piece              |

|                              |   |
|------------------------------|---|
| Order Multiple               | 1 piece   |
| Package Level 1 Gross Weight | 0.3 kg  |
| Package Level 1 Units        | 1 piece   |
| Part Type                    | New   |
| Product Name                 | THYRISTOR   |
| Product Net Weight           | 0.3 kg  |
| Product Type                 | Spare_Parts   |
| Quote Only                   | No  |
| Replaced Product ID (OLD)    | 3ADC340008P0003   |
| Selling Unit of Measure      | piece   |
| Stocked At (Warehouses)      | Finland<br>Menden, Germany<br>New Berlin, Wisconsin, United States<br>Beijing, China<br>Singapore, Singapore<br>Tokyo, Japan<br>Baden, Switzerland<br>Finland<br>Bangalore, India |
| Temperature Class Default    | --  |
| Two Speed Motor              | No  |
| UNSPSC                       | 32111700  |
| WEEE Category                | Product Not in WEEE Scope   |

**Where Used (as a spare part for "Products")**

| Identifier         | Description              | Quantity | Unit Of Measure |
|--------------------|--------------------------|----------|-----------------|
| DCS601-0903-61     | No Description Available | 1        | piece           |
| DCS601-0903-71     | No Description Available | 1        | piece           |
| DCS602-0903-61     | No Description Available | 1        | piece           |
| DCS602-0903-71     | No Description Available | 1        | piece           |
| DCS501B0903-61     | No Description Available | 1        | piece           |
| DCS501B0903-71     | No Description Available | 1        | piece           |
| DCS502B0903-61     | No Description Available | 1        | piece           |
| DCS502B0903-71     | No Description Available | 1        | piece           |
| DCS800-S01-0900-06 | No Description Available | 1        | piece           |
| DCS800-S01-0900-07 | No Description Available | 1        | piece           |
| DCS800-S02-0900-06 | No Description Available | 1        | piece           |
| DCS800-S02-0900-07 | No Description Available | 1        | piece           |

**Product specific part data**

| Product            | Drive Part Category               | Category |
|--------------------|-----------------------------------|----------|
| DCS601-0903-61     | Power Semiconductors (IGBTs etc.) |          |
| DCS601-0903-71     | Power Semiconductors (IGBTs etc.) |          |
| DCS602-0903-61     | Power Semiconductors (IGBTs etc.) |          |
| DCS602-0903-71     | Power Semiconductors (IGBTs etc.) |          |
| DCS501B0903-61     | Power Semiconductors (IGBTs etc.) |          |
| DCS501B0903-71     | Power Semiconductors (IGBTs etc.) |          |
| DCS502B0903-61     | Power Semiconductors (IGBTs etc.) |          |
| DCS502B0903-71     | Power Semiconductors (IGBTs etc.) |          |
| DCS800-S01-0900-06 | Power Semiconductors (IGBTs etc.) | DCS800-S |
| DCS800-S01-0900-07 | Power Semiconductors (IGBTs etc.) | DCS800-S |
| DCS800-S02-0900-06 | Power Semiconductors (IGBTs etc.) | DCS800-S |
| DCS800-S02-0900-07 | Power Semiconductors (IGBTs etc.) | DCS800-S |

### Categories

- Drives → DC Drives → Industrial Drives → Modules → DCS800-S
- Drives → DC Drives → Legacy DC Drives → DCS500B
- Drives → DC Drives → Legacy DC Drives → DCS600 CraneDrive
- Drives → DC Drives → Legacy DC Drives → DCS600 MultiDrive
- Drives → Services → Spares and Consumables → Parts

