

Siemens
EcoTech



output optocoupler, 24 V DC, 1 NO contact, screw terminal, width 6.2 mm, thermal current 6 A



| | |
|---------------------------------------------------------------------------------------------------------------|--------------------------------------------------------------------------------------------------------------------------|
| product brand name | SIRIUS |
| product category | SIRIUS 3RQ4 coupling relay, narrow design |
| product designation | Coupling relay with integrated semiconductor output |
| design of the product | output coupling link |
| product type designation | 3RQ4 |
| General technical data | |
| display version LED | Yes |
| product feature protective coating on printed-circuit board | No |
| product component | |
| • relay output | No |
| • semi-conductor output | Yes |
| power loss [W] maximum | 0.15 W |
| consumed active power | 0.2 W |
| insulation voltage for overvoltage category III according to IEC 60664 with degree of pollution 3 rated value | 300 V |
| surge voltage resistance rated value | 3 kV |
| maximum permissible voltage for protective separation | |
| • between control and auxiliary circuit | 300 V |
| • between control and auxiliary circuit according to IEC 60947-1 | 50 V |
| protection class IP | IP20 |
| flammability class of enclosure material | UL94 V-0 |
| shock resistance | |
| • according to IEC 60068-2-27 | sinusoidal half-wave 15g / 11 ms |
| vibration resistance | |
| • according to IEC 60068-2-6 | 6 ... 150 Hz: 2 g |
| switching behavior | monostable |
| switching frequency | 100 Hz |
| thermal current | 6 A |
| short-time withstand current (I _{cw}) limited to 10 ms | 8 A |
| reference code according to IEC 81346-2 | K |
| Substance Prohibitance (Date) | 09/26/2024 |
| SVHC substance name | Lead - 7439-92-1 Lead monoxide (lead oxide) - 1317-36-8 2,2',6,6'-tetrabromo-4,4'-isopropylidenediphenol - 79-94-7 |
| Net Weight | 0.035 kg |
| Control circuit/ Control | |

| | |
|---------------------------------------------------------------------------------------|---------------------------------------------|
| control supply voltage at DC rated value | 11 ... 30 V |
| operating range factor control supply voltage rated value at DC | |
| • initial value | 0.7 |
| • full-scale value | 1 |
| design of the surge suppressor at output | Suppressor diode |
| inrush current maximum | 6 A |
| minimum switching voltage when switching on | 11 V |
| maximum switching voltage when switching off | 5 V |
| ON-delay time | |
| • at DC maximum | 2 ms |
| OFF-delay time maximum | 2 ms |
| leakage current of the electronics for control with signal <0> | 0.02 mA |
| Switching Function | |
| design of the switching function positively driven | No |
| Digital Outputs | |
| property of the output short-circuit proof | Yes |
| Mechanical data | |
| product component plug-in socket | No |
| design of the relay operating mechanism | Non-polarized |
| Short-circuit protection | |
| design of the fuse link for short-circuit protection of the auxiliary switch required | fuse gG: 4 A |
| Auxiliary circuit | |
| type of switching contact | double contact |
| material of contact coating | other |
| material of switching contacts | Silver tin oxide (AgSnO ₂) |
| material of the contact insert | Thermoplastic |
| number of NC contacts for auxiliary contacts | 0 |
| number of NO contacts for auxiliary contacts | 1 |
| number of CO contacts for auxiliary contacts | 0 |
| Main circuit | |
| type of voltage | DC |
| Inputs/ Outputs | |
| switching current of semiconductor outputs | 6 A |
| type of voltage of the output voltage | DC |
| voltage drop when switched-through maximum | 80 mV |
| switching voltage of the semiconductor output at DC | 10 ... 30 V |
| ampacity of the semiconductor output at DC | 1 mA ... 6 A |
| Electromagnetic compatibility | |
| electromagnetic compatibility | acc. to EN 60947-5-1 |
| EMC emitted interference according to IEC 60947-1 | ambience A (industrial sector) |
| EMC immunity according to IEC 60947-1 | corresponds to degree of severity 3 |
| conducted interference | |
| • due to burst according to IEC 61000-4-4 | 2 kV |
| • due to conductor-earth surge according to IEC 61000-4-5 | 2 kV |
| • due to conductor-conductor surge according to IEC 61000-4-5 | 1 kV |
| field-based interference according to IEC 61000-4-3 | 10 V/m |
| electrostatic discharge according to IEC 61000-4-2 | 6 kV contact discharge / 8 kV air discharge |
| Display | |
| display version as status display by LED | LED green |
| Connections/ Terminals | |
| product function removable terminal | No |
| type of electrical connection | screw terminal |
| • for auxiliary and control circuit | screw-type terminals |
| type of connection technology | 3-wire technology |
| type of connectable conductor cross-sections | |

| | |
|----------------------------------------------------------------------------------------------------------------------------------------------------------|------------------------------------------------------------------------------------------------------------------------------------------------|
| <ul style="list-style-type: none"> • solid • finely stranded with core end processing • for AWG cables solid | 1x (0.25 ... 2.5 mm ²) 1x (0.25 ... 2.5 mm ²), 2x (0.25 ... 1.5 mm ²) 1x (20 ... 14), 2x (20 ... 16) |
| connectable conductor cross-section <ul style="list-style-type: none"> • solid • finely stranded with core end processing | 0.25 ... 2.5 mm ² 0.25 ... 2.5 mm ² |
| AWG number as coded connectable conductor cross section <ul style="list-style-type: none"> • solid | 20 ... 14 |
| tightening torque with screw-type terminals | 0.5 ... 0.6 N·m |
| size of the screwdriver tip | 3,0 x 0,5 mm |
| stripped length | 10 mm |

Installation/ mounting/ dimensions

| | |
|-------------------------------------------------------------------------------------------------------------------------------------------------------------------------------------------------------------------------------------------------------------------------------------------------------------------------------------------------------------------------------------------------------------------------------------------------------------------------------------------------------------------------------------------------------------------------------------------------------------------------------------------------------------------------------------------------------------------------------|------------------|
| mounting position | any |
| fastening method | snap-on mounting |
| height | 93 mm |
| width | 6.2 mm |
| depth | 84.5 mm |
| required spacing <ul style="list-style-type: none"> • with side-by-side mounting <ul style="list-style-type: none"> — forwards 0 mm — backwards 0 mm — upwards 0 mm — downwards 0 mm — at the side 0 mm • for grounded parts <ul style="list-style-type: none"> — forwards 0 mm — backwards 0 mm — upwards 0 mm — at the side 0 mm — downwards 0 mm • for live parts <ul style="list-style-type: none"> — forwards 0 mm — backwards 0 mm — upwards 0 mm — downwards 0 mm — at the side 0 mm | |

Ambient conditions

| | |
|----------------------------------------------------------------------------------------------------------------------------------------------------------------------------------------------------|-------------|
| installation altitude at height above sea level maximum | 2 000 m |
| ambient temperature <ul style="list-style-type: none"> • during operation -25 ... +60 °C • during storage -40 ... +85 °C • during transport -40 ... +85 °C | |
| relative humidity during operation | 10 ... 95 % |

Approvals Certificates

| | |
|--------------------|---------------------------------|
| Environment | General Product Approval |
|--------------------|---------------------------------|



| | | |
|---------------------------------|------------|--------------|
| General Product Approval | EMV | other |
|---------------------------------|------------|--------------|



[Confirmation](#)

Further information

Information on the packaging

<https://support.industry.siemens.com/cs/ww/en/view/109813875>

Information for data generation and storage

<https://support.industry.siemens.com/cs/ww/en/view/109995012>

Information- and Downloadcenter (Catalogs, Brochures,...)

<https://www.siemens.com/ic10>

Industry Mall (Online ordering system)

<https://mall.industry.siemens.com/mall/en/en/Catalog/product?mlfb=3RQ4052-1SM30>

Cax online generator

<https://support.automation.siemens.com/WW/CAXorder/default.aspx?lang=en&mlfb=3RQ4052-1SM30>

Service&Support (Manuals, Certificates, Characteristics, FAQs,...)

<https://support.industry.siemens.com/cs/ww/en/ps/3RQ4052-1SM30>

Image database (product images, 2D dimension drawings, 3D models, device circuit diagrams, EPLAN macros, ...)

https://www.automation.siemens.com/bilddb/cax_de.aspx?mlfb=3RQ4052-1SM30&lang=en

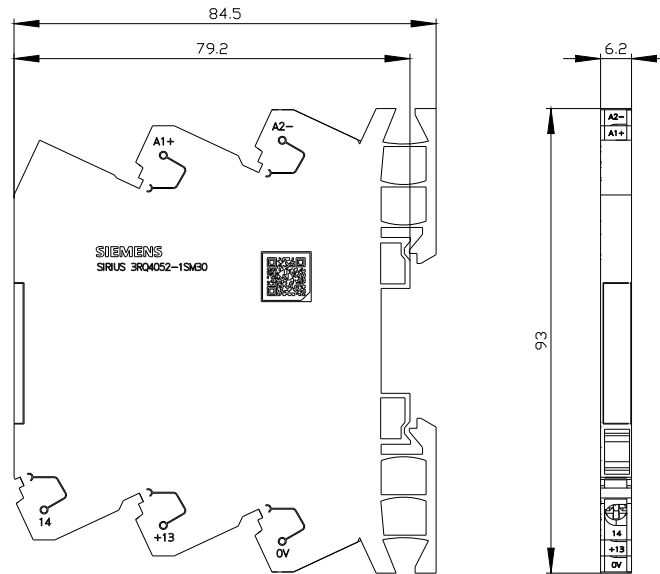

last modified:

12/7/2025