

Product datasheet

Specifications

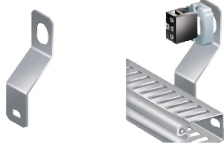

Cable ducting support to be used with 22mm-diameter products

Local distributor code:
392868387

NSYSPCP

EAN Code: 3606480184482

Main

Accessory / separate part category	Cable management accessory
Product or component type	Support
Product destination	Cable duct
Range compatibility	PanelSeT PLA PanelSeT PLS PanelSeT PLM PanelSeT SBM PanelSeT S3D PanelSeT S3CM PanelSeT CRN
Anwendung	Multi-purpose
Mounting support	Door
Device composition	1 support
Quantity per set	Set of 10

Complementary

Material	Galvanised steel
Fixing mode	By screws on 22 mm equipment
Height	100 mm
Width	30 mm
Depth	11.5 mm
Diameter	22.5 mm 0 mm

Packing Units

Unit Type of Package 1	PCE
Number of Units in Package 1	1
Package 1 Height	2.000 cm
Package 1 Width	0.700 cm
Package 1 Length	10.500 cm
Package 1 Weight	29.000 g
Unit Type of Package 2	BB1
Number of Units in Package 2	10
Package 2 Height	2.000 cm
Package 2 Width	7.000 cm

Package 2 Length	10.500 cm
Package 2 Weight	290.000 g
Unit Type of Package 3	CAR
Number of Units in Package 3	160
Package 3 Height	20.000 cm
Package 3 Width	21.000 cm
Package 3 Length	31.000 cm
Package 3 Weight	4.834 kg

Logistical informations

Country of origin FR

Contractual warranty

Warranty (in months) 18



Environmental Data

Schneider Electric aims to achieve Net Zero status by 2050 through supply chain partnerships, lower impact materials, and circularity via our ongoing “Use Better, Use Longer, Use Again” campaign to extend product lifetimes and recyclability.

[Environmental Data explained >](#)

[How we assess product sustainability >](#)



Environmental footprint

[Environmental Disclosure](#)

[Product Environmental Profile](#)

Use Better



Materials and Substances

Packaging made with recycled cardboard

No

Packaging without single use plastic

No

[EU RoHS Directive](#)

Pro-active compliance (Product out of EU RoHS legal scope)

REACH Regulation

[REACH Declaration](#)

Use Longer



Lifetime extension

Repair

No

Use Again



Repack and remanufacture

End of life manual availability

No need of specific recycling operations

Take-back

No