

SISM 45 - Mounting panel

2942865

<https://www.phoenixcontact.com/gb/products/2942865>



Please be informed that the data shown in this PDF document is generated from our online catalog. Please find the complete data in the user documentation. Our general terms of use for downloads are valid.

Mounting panel for screwing on switching devices, low version

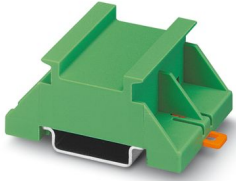

Commercial data

| | |
|--------------------------------------|---------------|
| Item number | 2942865 |
| Packing unit | 10 pc |
| Minimum order quantity | 10 pc |
| Sales key | ACGEAC |
| Product key | ACGEAC |
| GTIN | 4017918131128 |
| Weight per piece (including packing) | 15.48 g |
| Weight per piece (excluding packing) | 15.48 g |
| Customs tariff number | 39269097 |
| Country of origin | DE |

SISM 45 - Mounting panel

2942865

<https://www.phoenixcontact.com/gb/products/2942865>



Technical data

Product properties

| | |
|--------------|---------------------|
| Housing type | DIN rail adapter |
| Type | closed version, low |

Dimensions

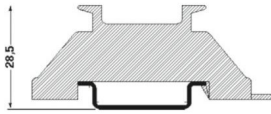
| | |
|---------------------|--|
| Dimensional drawing |  |
| Width | 45 mm |
| Length | 60 mm |

Material specifications

| | |
|-------------------------|-----------------------|
| Color (Housing) | green (RAL 6021) |
| Material Housing | PC (fiber-reinforced) |
| Surface characteristics | untreated |

Environmental and real-life conditions

Ambient conditions

| | |
|---------------------------------|-------------------|
| Ambient temperature (operation) | -40 °C ... 105 °C |
|---------------------------------|-------------------|

SISM 45 - Mounting panel

2942865

<https://www.phoenixcontact.com/gb/products/2942865>



Drawings

Dimensional drawing

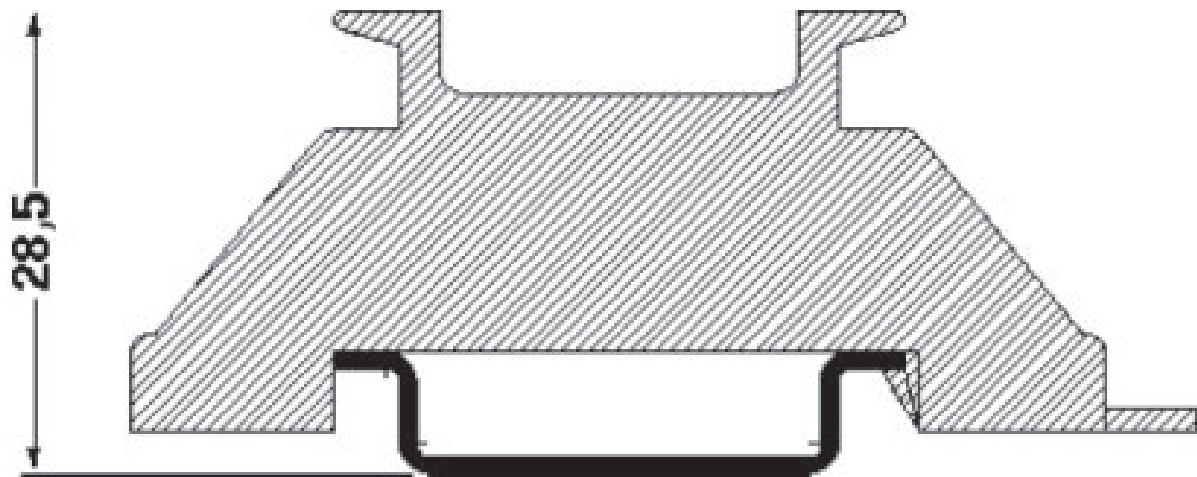

SISM 45 - Mounting panel

2942865

<https://www.phoenixcontact.com/gb/products/2942865>



Dimensional drawing

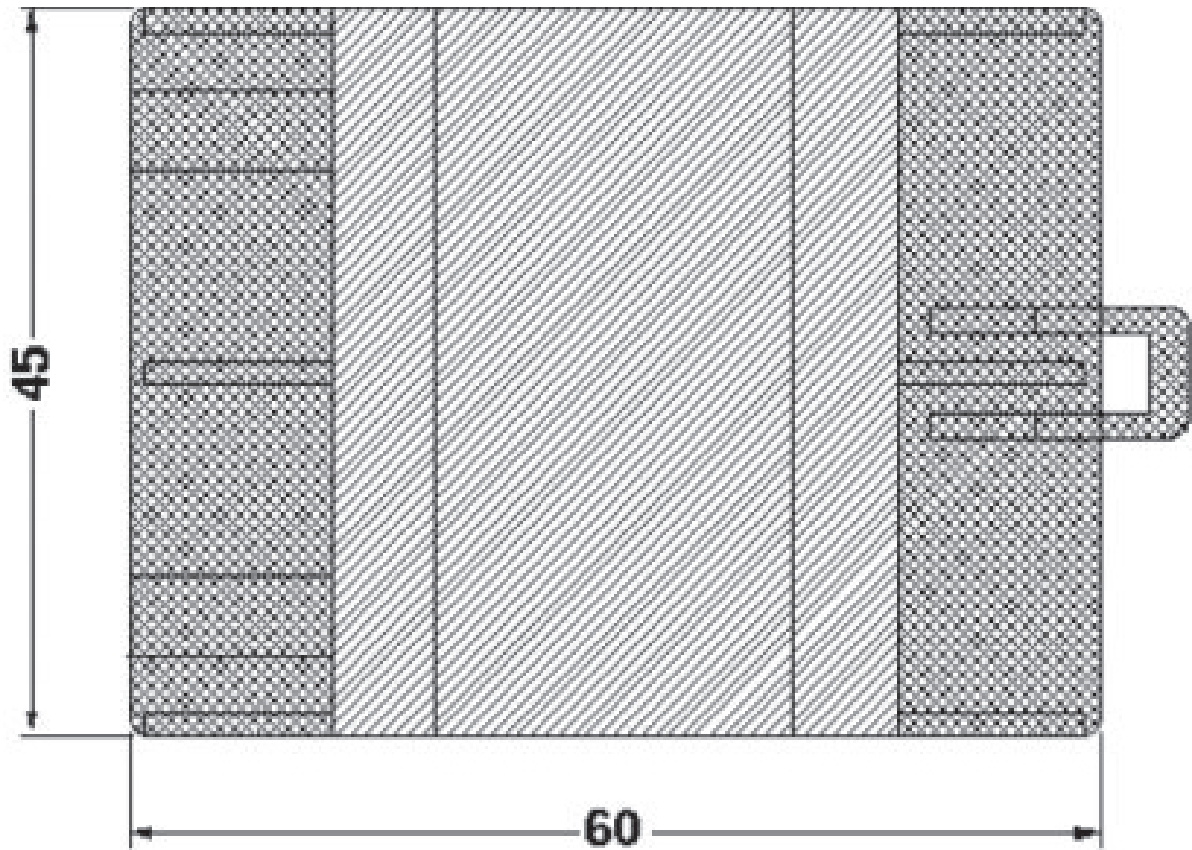

SISM 45 - Mounting panel

2942865

<https://www.phoenixcontact.com/gb/products/2942865>



Classifications

ECLASS

| | |
|-------------|----------|
| ECLASS-13.0 | 27190605 |
| ECLASS-15.0 | 27190605 |

ETIM

| | |
|-----------|----------|
| ETIM 10.0 | EC002779 |
|-----------|----------|

UNSPSC

| | |
|-------------|----------|
| UNSPSC 21.0 | 31261500 |
|-------------|----------|

SISM 45 - Mounting panel

2942865

<https://www.phoenixcontact.com/gb/products/2942865>



Environmental product compliance

EU RoHS

| | |
|---|--------------------|
| Fulfills EU RoHS substance requirements | Yes, No exemptions |
|---|--------------------|

China RoHS

| | |
|--|--|
| Environment friendly use period (EFUP) | EFUP-E |
| | No hazardous substances above the limits |

EU REACH SVHC

| | |
|-------------------------------------|----------------------------|
| REACH candidate substance (CAS No.) | No substance above 0.1 wt% |
|-------------------------------------|----------------------------|

Phoenix Contact 2026 © - all rights reserved
<https://www.phoenixcontact.com>

PHOENIX CONTACT Ltd
Halesfield 13, Telford
Shropshire, TF7 4PG
01952 681700
info@phoenixcontact.co.uk