

# Product datasheet

Specifications

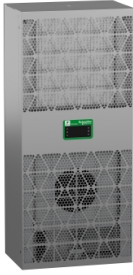

## Side Connected Cooling Unit, Climasys CU, Stainless Steel, 1kW, 230V, 50/60Hz, IP55

NSYCUX1KDG

EAN Code: 3606486055045

### Main

Range	ClimaSys
Product name	CU
mounting type	Side
Product or component type	Cooling unit
Installation	Indoor side
Product destination	For enclosure
Mounting mode	By screws
Supply Voltage	220...240 V 1 phase 50 Hz EN/IEC 230 V +/- 6 % 1 phase 50 Hz UL
Rated Power	1000 W
Cooling power	1000 W 50/60 Hz L35-L35 870 W 50/60 Hz L35-L50

### Complementary

Height	780 mm
Width	345 mm
Depth	215 mm
[In] rated current	3.0 A
Inrush current	6 A
Power consumption in W	480 W at 50/60 Hz, L35-L35 530 W at 50/60 Hz, L35-L50
Energy efficiency ratio	2.1
Control type	Electronic controller
Temperature setting range	20...50 °C at 50/60 Hz
Ambient air temperature for operation	20...50 °C at 50/60 Hz inside the enclosure: 5...55 °C at 50/60 Hz outside the enclosure:
Noise level	70 dB
Pressure	30 bar
Flow rate	Internal circuit: 550 m3/h at 50/60 Hz External circuit: 850 m3/h at 50/60 Hz
Net weight	22.4 kg
Cooling gas type	R134a (0.145 kg)
Type of filter	Optional external circuit filter
Recommended circuit breaker protection	M9F23116

<b>Thermal protection Recommended (fuse)</b>	15 A (T)
<b>Material</b>	Stainless steel
<b>Colour</b>	Stainless steel

## Environment

<b>Product certifications</b>	UL IEC EN
<b>Directives</b>	2006/42/EC - machinery 2014/30/EU - electromagnetic compatibility 2011/65/EU - RoHS
<b>Standards</b>	EN/ISO 12100 EN 60335-1 EN 60335-2-40 EN 61000-3-2 EN 61000-3-3 EN 61000-6-2 EN 61000-6-3 EN/IEC 63000:2018 EN 14511
<b>IP degree of protection</b>	IP55 conforming to IEC 60529 (on the internal circuit) IP24 conforming to IEC 60529 (on the external circuit)

## Packing Units

<b>Unit Type of Package 1</b>	PCE
<b>Number of Units in Package 1</b>	1
<b>Package 1 Height</b>	87.500 cm
<b>Package 1 Width</b>	25.500 cm
<b>Package 1 Length</b>	42.500 cm
<b>Package 1 Weight</b>	24.400 kg
<b>Unit Type of Package 2</b>	P12
<b>Number of Units in Package 2</b>	7
<b>Package 2 Height</b>	102.000 cm
<b>Package 2 Width</b>	80.000 cm
<b>Package 2 Length</b>	120.000 cm
<b>Package 2 Weight</b>	182.000 kg

## Contractual warranty

<b>Warranty (in months)</b>	18
-----------------------------	----



## Environmental Data

Schneider Electric aims to achieve Net Zero status by 2050 through supply chain partnerships, lower impact materials, and circularity via our ongoing “Use Better, Use Longer, Use Again” campaign to extend product lifetimes and recyclability.

[Environmental Data explained >](#)

[How we assess product sustainability >](#)



### Environmental footprint

Total lifecycle Carbon footprint	3 179 kg CO2 eq.
Carbon footprint of the manufacturing phase [A1 to A3]	92 kg CO2 eq.
Carbon footprint of the distribution phase [A4]	2 kg CO2 eq.
Carbon footprint of the installation phase [A5]	4 kg CO2 eq.
Carbon footprint of the use phase [B2, B3, B4, B6]	3 034 kg CO2 eq.
Carbon footprint of the end-of-life phase [C1 to C4]	47 kg CO2 eq.

## Use Better



### Materials and Substances

Packaging made with recycled cardboard	Yes
Packaging without single use plastic	Yes
EU RoHS Directive	<a href="#">Compliant</a>
REACH Regulation	<a href="#">Free of Substances of Very High Concern above the threshold</a>

## Use Longer



### Lifetime extension

Repair	No
--------	----

## Use Again



### Repack and remanufacture

Recyclability potential, in %	89
End of life manual availability	<a href="#">End of Life Information</a>
Take-back	Nej
WEEE Label	 The product must be disposed on European Union markets following specific waste collection and never end up in rubbish bins

Technical Illustration

Dimensions

---

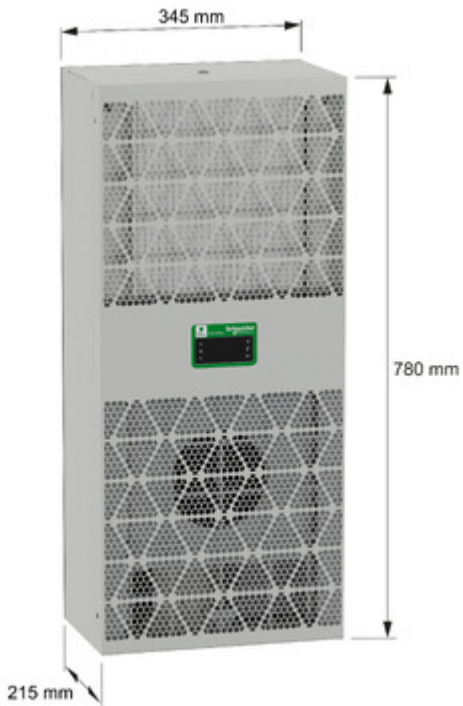

Technical Illustration

Wiring diagram

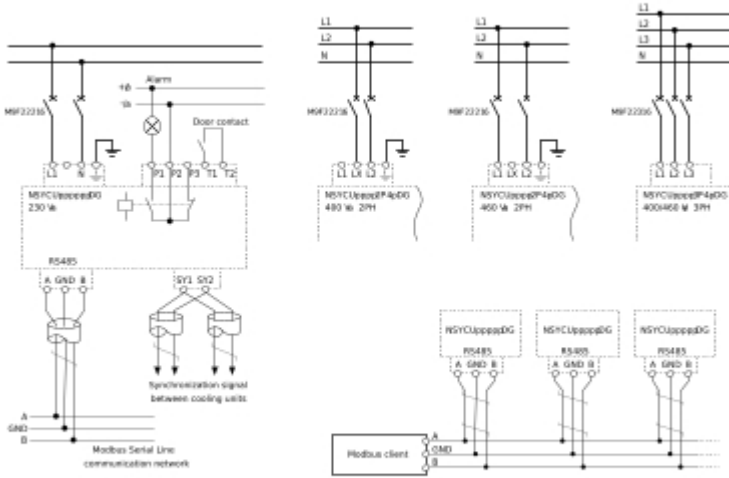

Offer Marketing Illustration

Product benefits / Features

---

The illustration features a central image of three different models of cooling units: a tall rack-mounted unit, a medium-sized rack-mounted unit, and a smaller floor-standing unit. Surrounding these units are six circular icons, each with a corresponding text description of a product benefit or feature.

- Connected with alarming and setting data**: Represented by an icon of a signal tower.
- Easy selection with 40 references IEC & UL**: Represented by an icon of a checklist with four items.
- 3 redundant modes for critical application**: Represented by an icon of a three-way branching structure.
- Recycled packaging, good energy efficiency ratio**: Represented by a circular icon with a recycling symbol and a leaf.
- 30% Smaller and lighter Cooling Units**: Represented by an icon of a square with a diagonal line and a smaller square.
- Easy mounting with 3 positions, easy spare parts replacement**: Represented by an icon of a clock with a checkmark.

Offer Marketing Illustration

Energy Label

---

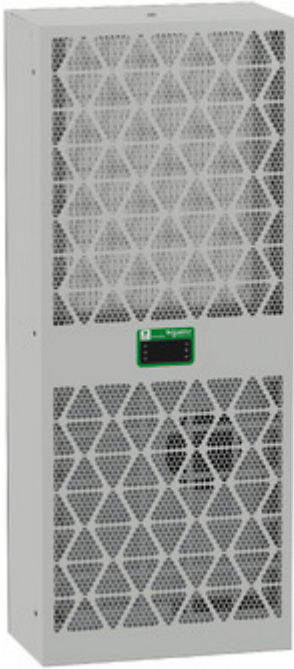

Technical Illustration

Exploded view

---

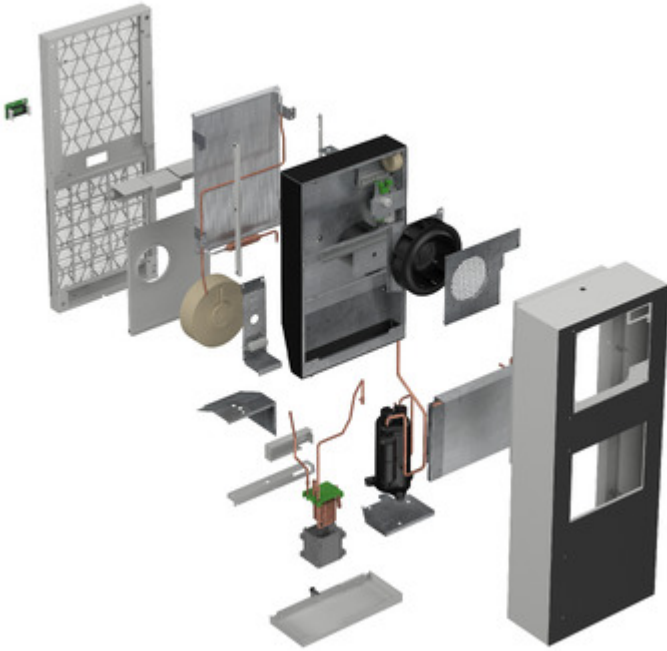

Technical Illustration

Exploded view

---

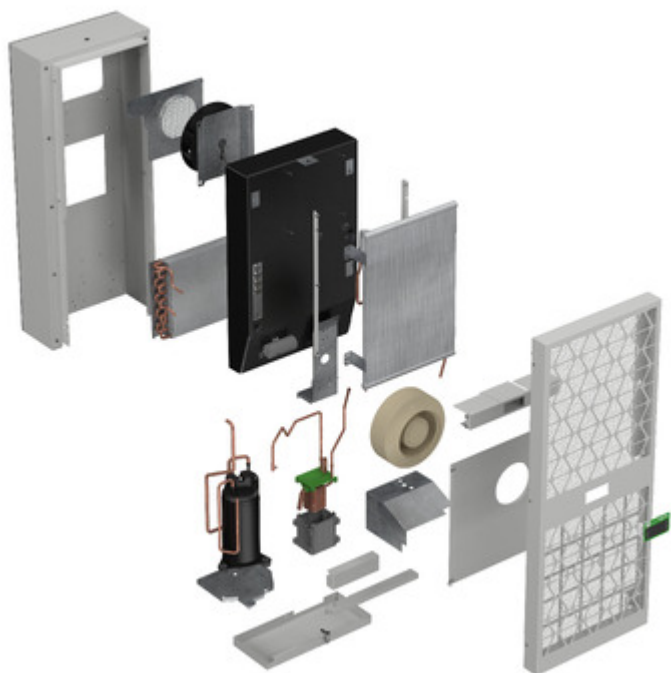

Technical Illustration

Exploded view

---

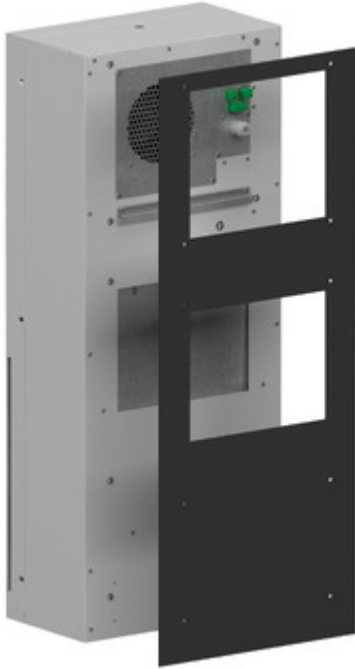

Image of product / Alternate images

Alternative

---

