

# Product datasheet

Specifications

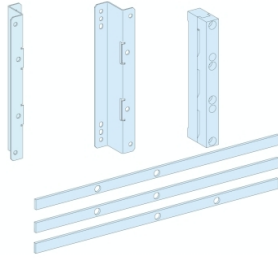

## MOUNTING PLATE BUSBAR ISFT 100N/160 VERTICAL

LVS03122

EAN Code: 3606481871176

### Main

Range	PrismaSeT
Range of product	PrismaSeT G
Product or component type	Mounting plate
Accessory / separate part category	Installation accessory
Range compatibility	PrismaSeT PrismaSeT G enclosure
installation description	Floor-standing enclosure - width 600 mm Wall-mounted enclosure - width 600 mm
Installed device	FuPact: fixed ISFT160 - control: fuse carriers handle - vertical installation FuPact: fixed ISFT100N - control: fuse carriers handle - vertical installation
Poles description	4 x 3P: fixed ISFT160 vertical installation 6 x 3P: fixed ISFT100N vertical installation
Number of vertical modules [50 mm]	8 module(s): ISFT100N, rear connection on busbar in 600 mm Widefloor-standing enclosure 8 module(s): ISFT100N, rear connection on busbar in 600 mm Widewall-mounted enclosure 8 module(s): ISFT160, rear connection on busbar in 600 mm Widefloor-standing enclosure 8 module(s): ISFT160, rear connection on busbar in 600 mm Widewall-mounted enclosure
Standards	IEC 61439-2
Product certifications	ASTA

### Complementary

Material	Sheet steel
Protective treatment	Electrophoresis treatment and hot-polymerised polyester epoxy powder
Surface finish	Textured Matt
Colour	White (RAL 9003)
Width	600 mm
Height	250 mm
Net weight	4.26 kg
Functional unit	600 mm PrismaSeT G floor-standing enclosure FuPact ISFT100N fixed fuse carriers handle vertical 3P 6 rear connection on busbar 8 100 mm 600 mm PrismaSeT G wall-mounted enclosure FuPact ISFT100N fixed fuse carriers handle vertical 3P 6 rear connection on busbar 8 100 mm 600 mm PrismaSeT G floor-standing enclosure FuPact ISFT160 fixed fuse carriers handle vertical 3P 4 rear connection on busbar 8 75 mm 600 mm PrismaSeT G wall-mounted enclosure FuPact ISFT160 fixed fuse carriers handle vertical 3P 4 rear connection on busbar 8 75 mm

### Packing Units

<b>Unit Type of Package 1</b>	PCE
<b>Number of Units in Package 1</b>	1
<b>Package 1 Height</b>	6.500 cm
<b>Package 1 Width</b>	10.500 cm
<b>Package 1 Length</b>	45.500 cm
<b>Package 1 Weight</b>	4.178 kg
<b>Unit Type of Package 2</b>	P12
<b>Number of Units in Package 2</b>	16
<b>Package 2 Height</b>	21.000 cm
<b>Package 2 Width</b>	80.000 cm
<b>Package 2 Length</b>	120.000 cm
<b>Package 2 Weight</b>	80.848 kg

## Contractual warranty

<b>Warranty (in months)</b>	18
-----------------------------	----



## Environmental Data

Schneider Electric aims to achieve Net Zero status by 2050 through supply chain partnerships, lower impact materials, and circularity via our ongoing “Use Better, Use Longer, Use Again” campaign to extend product lifetimes and recyclability.

[Environmental Data explained >](#)

[How we assess product sustainability >](#)



### Environmental footprint

[Environmental Disclosure](#)

[Product Environmental Profile](#)

## Use Better



### Materials and Substances

Packaging made with recycled cardboard

Yes

Packaging without single use plastic

Yes

EU RoHS Directive

[Compliant](#)

REACH Regulation

[Free of Substances of Very High Concern above the threshold](#)

Halogen-free status

Halogen free plastic parts product

PVC free

Yes

Silicone-free

Yes

## Use Longer



### Lifetime extension

Repair

No

## Use Again



### Repack and remanufacture

End of life manual availability

No need of specific recycling operations

Take-back

Nej

Technical Illustration

Dimensions

---

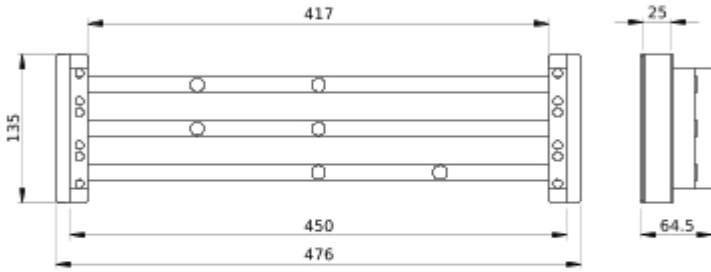

- All dimensions are approximate and are in  
- Also see technical documentation.