



Washer for EMERGENCY STOP, yellow, with inscription: NOT-HALT, outer diameter 75 mm, Inside diameter 22.5 mm, Thickness 2 mm

product brand name	SIRIUS ACT
product designation	EMERGENCY STOP plate
product type designation	3SU1

General technical data	
shock resistance for railway applications according to EN 61373	Category 1, Class B
vibration resistance for railway applications according to EN 61373	Category 1, Class B
Substance Prohibitation (Date)	10/01/2014
Net Weight	7 g

Ambient conditions	
ambient temperature	
<ul style="list-style-type: none"> during operation 	70 ... -25 °C
<ul style="list-style-type: none"> during storage and transport 	80 ... -40 °C

Accessories	
material of accessory	Plastic
fastening method of label	without
marking of backing plate	NOT-HALT
shape of backing plate	Round
color of backing plate	yellow (plate); black (text)
product function illuminated backing plate	No

Approvals Certificates	
Environmental Product Declaration	
<ul style="list-style-type: none"> global warming potential [CO2 eq] / during manufacturing 	0.566 kg
<ul style="list-style-type: none"> global warming potential [CO2 eq] / during operation 	0.235 kg
<ul style="list-style-type: none"> global warming potential [CO2 eq] / after end of life 	-0.0145 kg
<ul style="list-style-type: none"> global warming potential [CO2 eq] / total 	0.787 kg

Environment	General Product Approval
-------------	--------------------------



[Environmental Con-
firmations](#)



General Product Ap- proval	Test Certificates	Maritime application
-------------------------------	-------------------	----------------------



[Type Test Certificates/Test Report](#)

[Special Test Certificate](#)



Maritime application other



[Confirmation](#)

Further information

Information on the packaging

<https://support.industry.siemens.com/cs/ww/en/view/109813875>

Information for data generation and storage

<https://support.industry.siemens.com/cs/ww/en/view/109995012>

Information- and Downloadcenter (Catalogs, Brochures,...)

<https://www.siemens.com/ic10>

Industry Mall (Online ordering system)

<https://mall.industry.siemens.com/mall/en/en/Catalog/product?mlfb=3SU1900-0BB31-0AT0>

Cax online generator

<https://support.automation.siemens.com/WW/CAXorder/default.aspx?lang=en&mlfb=3SU1900-0BB31-0AT0>

Service&Support (Manuals, Certificates, Characteristics, FAQs,...)

<https://support.industry.siemens.com/cs/ww/en/ps/3SU1900-0BB31-0AT0>

Image database (product images, 2D dimension drawings, 3D models, device circuit diagrams, EPLAN macros, ...)

https://www.automation.siemens.com/bilddb/cax_de.aspx?mlfb=3SU1900-0BB31-0AT0&lang=en

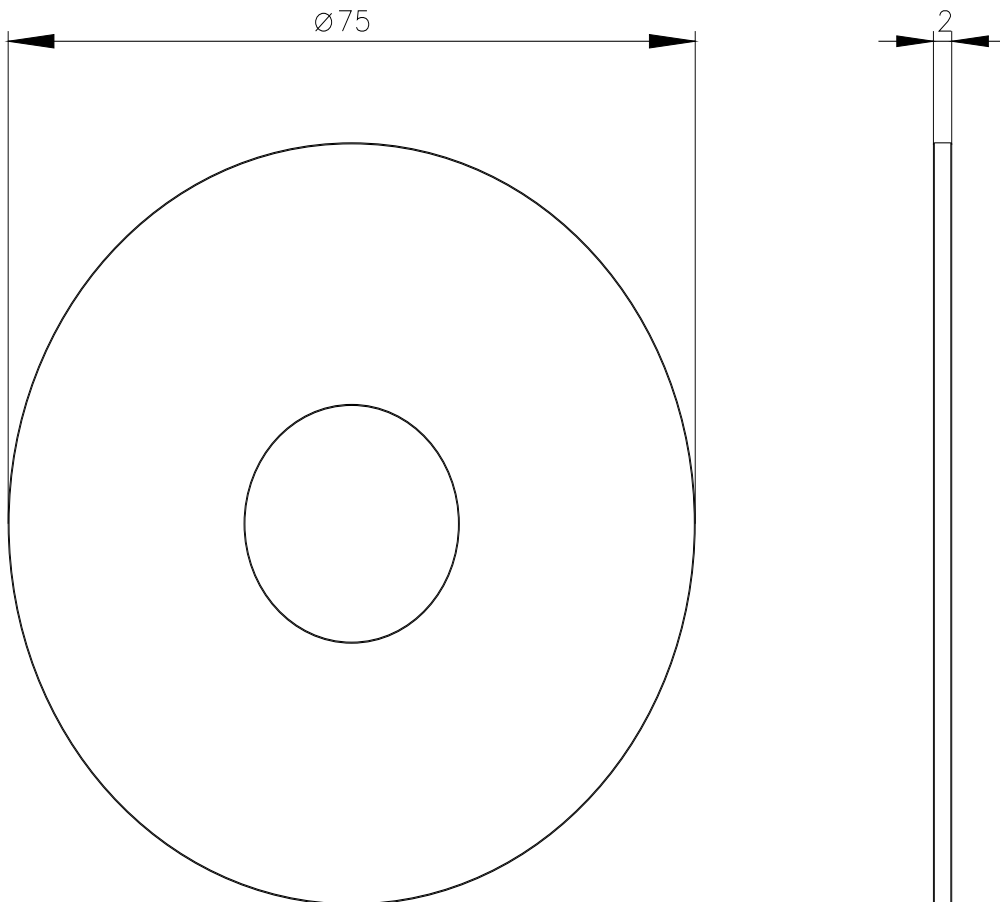

last modified:

4/2/2025