

# O5S700

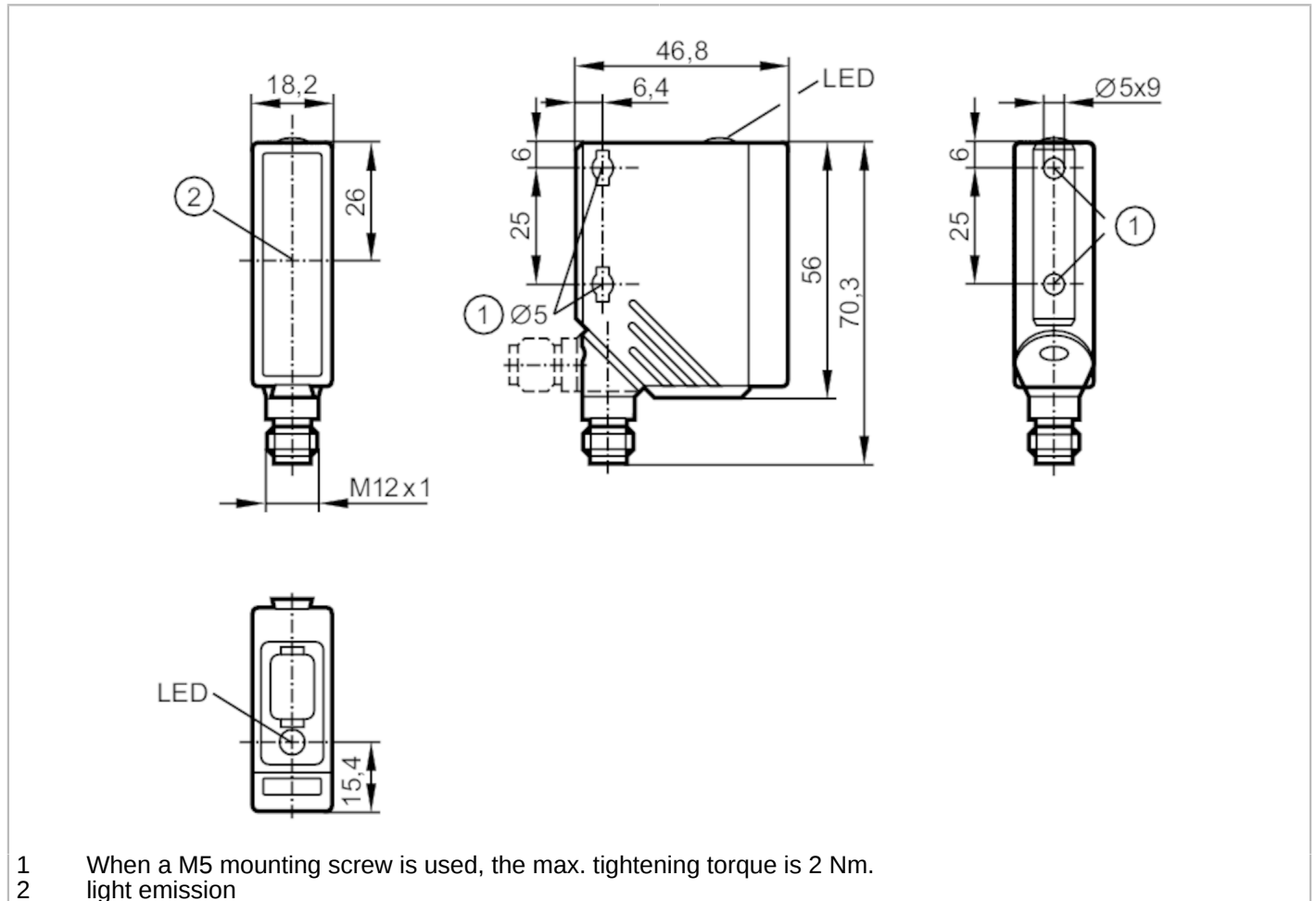

## Through-beam laser sensor transmitter

O5SLOOKG/US100



Application	
Function principle	Through-beam sensor
Electrical data	
Operating voltage [V]	10...36 DC
Current consumption [mA]	13
Protection class	II
Reverse polarity protection	yes
Type of light	red light
Wave length [nm]	655
Detection zone	
Transmitter / receiver	transmitter
Range [m]	< 60
Range adjustable	no
Max. light spot diameter [mm]	150
Light spot dimensions refer to	at maximum range
Operating conditions	
Ambient temperature [°C]	-10...60
Protection	IP 67

# O5S700



## Through-beam laser sensor transmitter

O5SLOOKG/US100

Tests / approvals		
EMC	EN 60947-5-2	
Laser protection class	1; (IEC 60825-1 : 2007; Complies with 21 CFR 1040 except for deviations pursuant to Laser Notice No. 50, dated June 2007.)	
MTTF [years]	1038	
Mechanical data		
Weight [g]	66.6	
Housing	rectangular	
Dimensions [mm]	56 x 18.2 x 46.8	
Materials	housing: PA; bezel: stainless steel; operator interface: TPU	
Lens material	PMMA	
Lens alignment	side lens	
Displays / operating elements		
Display	operation	1 x LED, green
Remarks		
Remarks	operating voltage "supply class 2" according to cULus	
Pack quantity	1 pcs.	
Electrical connection		

Connector: 1 x M12



### Connection

