

TA3237



Temperature transmitter

TA-123CLDD06-A-ZVG/US/

Status Archive

TA2247/TD2237

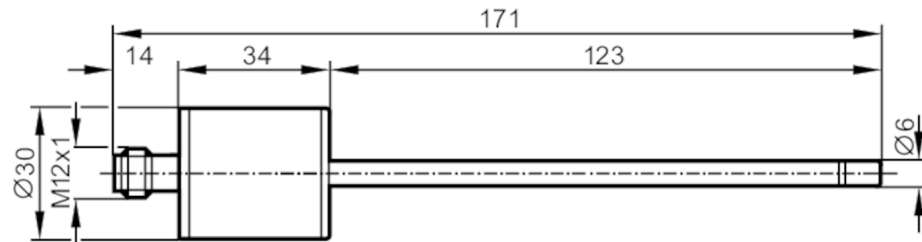

Application

Measuring element	1 x Pt 1000; (to DIN EN 60751, class A)	
Media	liquids and gases	
Medium temperature	< 150; (< 40 min) °C	< 302; (< 40 min) °F
Pressure rating [bar]	50	
Note on pressure rating	sensor	
Minimum installation depth [mm]	When mounted in adapters the specifications of the adapter data sheet apply. 15	

Electrical data

Operating voltage [V]	10...30 DC
Protection class	III
Reverse polarity protection	yes

Outputs

Total number of outputs	1
Output signal	analogue signal
Number of analogue outputs	1
Analogue current output [mA]	4...20
Max. load [Ω]	500
Overload protection	yes

Measuring/setting range

Probe length L [mm]	123
Measuring range	0...100 °C 32...212 °F

Resolution

Resolution of analogue output [K]	0.02
-----------------------------------	------

Accuracy / deviations

Precision analogue output [K]	± 0,3
Temperature coefficient [% of the span / 10 K]	< ± 0,1; (in case of deviation from the reference condition 25 ± 5 °C)

Response times

Dynamic response T05 / T09 [s]	1 / 3; (to DIN EN 60751)
--------------------------------	--------------------------

TA3237



Temperature transmitter

TA-123CLDD06-A-ZVG/US/

Operating conditions		
Ambient temperature	[°C]	-25...70
Storage temperature	[°C]	-40...100
Protection		IP 68; IP 69K

Tests / approvals		
EMC	DIN EN 61000-4-2 ESD	4 kV CD / 8 kV AD
	EN 61000-4-3 HF radiated	10 V/m
	DIN EN 61000-4-4 Burst	2 kV
	DIN EN 61000-4-5 Surge	1 kV
	EN 61000-4-6 HF conducted	10 V
Shock resistance	DIN EN 60068-2-27	50 g (11 ms)
Vibration resistance	DIN EN 60068-2-6	10 g (10...2000 Hz)
MTTF	[years]	1119

Mechanical data		
Weight	[g]	162.4
Dimensions	[mm]	Ø 30 / L = 171
Materials		stainless steel (1.4404 / 316L); stainless steel (1.4301 / 304); stainless steel (1.4305 / 303); PA
Materials (wetted parts)		stainless steel (1.4404 / 316L)
Process connection		diameter Ø 6 mm
Probe diameter	[mm]	6
Installation length EL	[mm]	123

Remarks		
Remarks		operating voltage "supply class 2" according to cULus The values for accuracy apply to flowing water.
Notes		discontinued article
Pack quantity		1 pcs.

Electrical connection

Connector: 1 x M12; Contacts: gold-plated



TA3237



Temperature transmitter

TA-123CLDD06-A-ZVG/US/

Connection

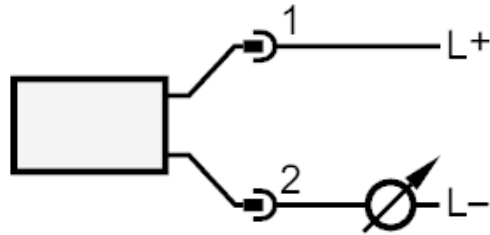

Status Archive

TA2247/TD2237