

O6S314

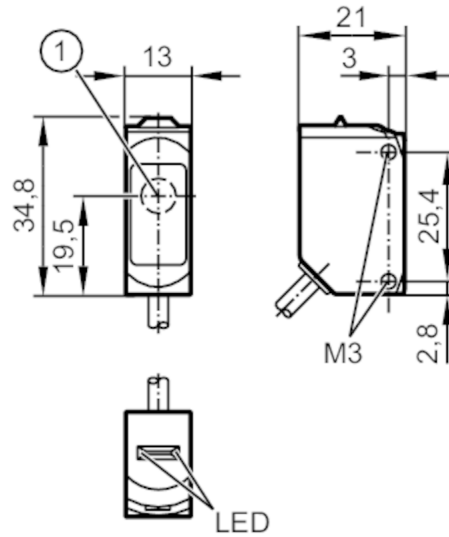

Through-beam sensor transmitter

O6S-OOKG/0,30M/US



1 light emission



Application

Function principle Through-beam sensor

Electrical data

Operating voltage [V]	10...30 DC
Current consumption [mA]	11; ((24 V))
Protection class	III
Type of light	red light
Wave length [nm]	633

Detection zone

Transmitter / receiver	transmitter
Range [m]	< 10
Max. light spot diameter [mm]	300
Light spot dimensions refer to	at maximum range

Interfaces

Communication interface	IO-Link
Transmission type	COM2 (38,4kBaud)
IO-Link revision	1.1
SDCI standard	IEC 61131-9 CDV
IO-Link device ID	420 d / 00 01 A4 h
Profiles	Smart Sensor: Device Identification
SIO mode	yes
Required master port type	A

Operating conditions

Ambient temperature [°C]	-25...80
Protection	IP 65; IP 67; IP 68; IP 69K

O6S314



Through-beam sensor transmitter

O6S-OOKG/0,30M/US

Tests / approvals

EMC	EN 60947-5-2
-----	--------------

Mechanical data

Weight	[g]	52.6
Housing		rectangular
Dimensions	[mm]	34.8 x 13 x 21
Materials		housing: stainless steel (1.4404 / 316L); plastics: PPSU; Sealing: EPDM
Lens material		PMMA
Lens alignment		side lens

Displays / operating elements

Display	operation	1 x LED, green
---------	-----------	----------------

Remarks

Pack quantity	1 pcs.
---------------	--------

Electrical connection

Cable: 0.3 m, PVC; 3 x 0.25 mm²

Connector: 1 x M12



Connection

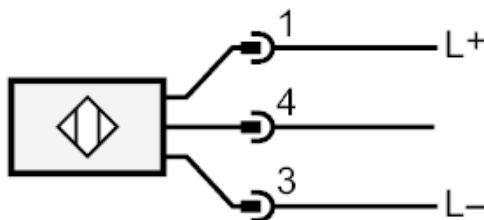



Through-beam sensor transmitter

O6S-OOKG/0,30M/US

Diagrams and graphs

excess gain graph

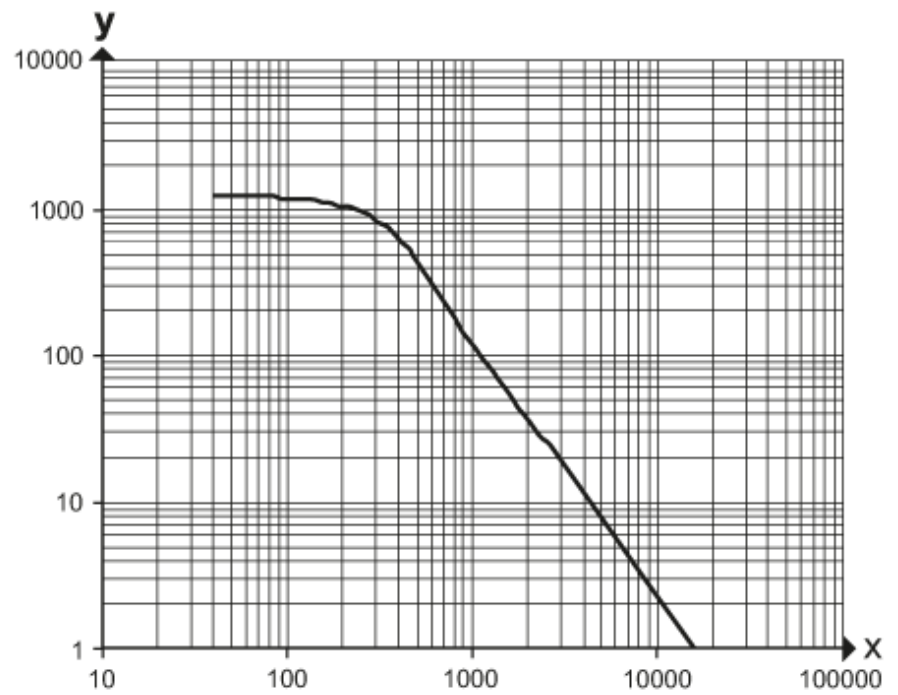

x: Abstand [mm]

y: Funktionsreservfaktor