

RU1033

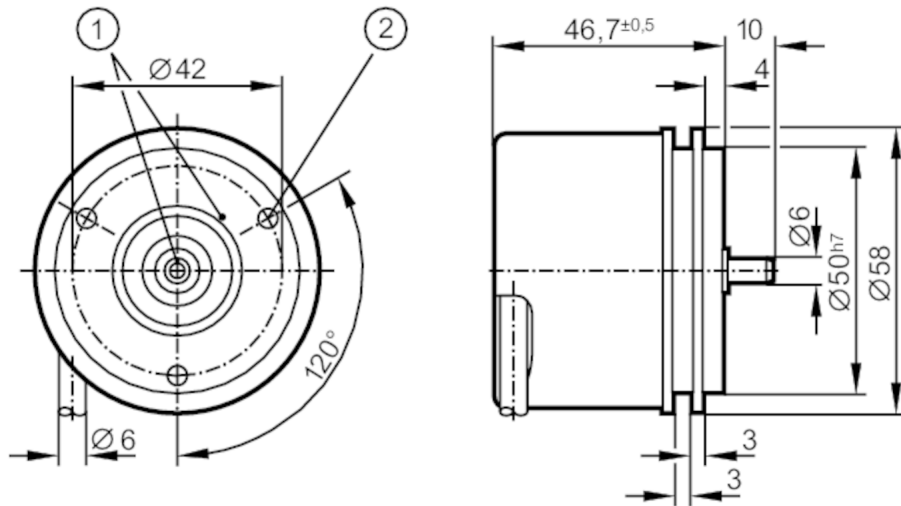

Incremental encoder with solid shaft

RU-2000-I05/L2



- 1 reference mark
2 M4 Depth 5 mm



Application

Function principle incremental

Electrical data

Operating voltage tolerance [%]	10
Operating voltage [V]	5 DC
Current consumption [mA]	< 120

Outputs

Electrical design	TTL
Max. current load per output [mA]	20
Switching frequency [kHz]	300
Phase difference A und B [°]	90

Measuring/setting range

Resolution 2000 resolution

Operating conditions

Ambient temperature [°C]	-40...100
Note on ambient temperature	for firmly laid cable: -40 °C
Max. relative air humidity [%]	98
Protection	IP 64; (on the housing: IP 67; on the shaft: IP 64)

Tests / approvals

Shock resistance	200 g
Vibration resistance	30 g
MTTF [years]	190

RU1033



Incremental encoder with solid shaft

RU-2000-I05/L2

Mechanical data		
Weight	[g]	492
Dimensions	[mm]	Ø 58 / L = 46.7
Materials		aluminium
Max. revolution, mechanical	[U/min]	16000
Max. starting torque	[Nm]	1
Reference temperature torque	[°C]	20
Shaft design		solid shaft
Shaft diameter	[mm]	6
Shaft material		steel (1.4104)
Max. shaft load axial (at the shaft end)	[N]	10
Max. shaft load radial (at the shaft end)	[N]	20
Fixing flange		synchro-flange

Remarks	
Notes	discontinued article

Electrical connection
 Cable: 2 m, PUR; Maximum cable length: 100 m; radial, can also be used axially

brown	A
green	A inverted
grey	B
pink	B inverted
red	0 index
black	0 index inverted
blue	L+ sensor
white	0V sensor
brown/green	L+ (Up)
white/green	0V (Un)
lilac	failure inverted
screen	housing

Diagrams and graphs

Pulse diagram	<p>The diagram shows three digital signals over time. The top signal is a square wave labeled 'Output A'. The middle signal is a square wave labeled 'Output B', which is phase-shifted by 180 degrees relative to Output A. The bottom signal is a single narrow pulse labeled '0 index', which occurs at a specific point in the cycle.</p>
	<p>Output A</p> <p>Output B</p> <p>0 index</p>