

# OGH280

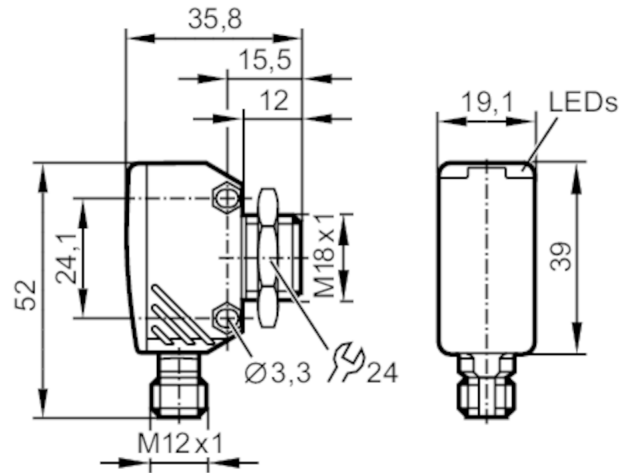

## Diffuse reflection sensor with background suppression

OGH-HPKG/US/CUBE/100MM



transmitter in lower lens  
receiver in upper lens



### Application

Function principle Diffuse reflection sensor

### Electrical data

Operating voltage [V]	10...30 DC
Current consumption [mA]	30
Protection class	III
Reverse polarity protection	yes
Type of light	red light
Wave length [nm]	624

### Outputs

Electrical design	PNP
Output function	light-on mode
Max. voltage drop switching output DC [V]	2.5
Permanent current rating of switching output DC [mA]	200
Switching frequency DC [Hz]	1000
Short-circuit protection	yes
Type of short-circuit protection	pulsed
Overload protection	yes

# OGH280



## Diffuse reflection sensor with background suppression

OGH-HPKG/US/CUBE/100MM

Detection zone	
Range [mm]	< 100; (white paper 200 x 200 mm 90 % remission)
Range on white object (90 % remission) [mm]	< 100
Range on grey object (18 % remission) [mm]	< 100
Range on black object (6 % remission) [mm]	< 100
Range adjustable	no
Max. light spot diameter [mm]	7
Light spot dimensions refer to	at maximum range
Background suppression available	yes

Operating conditions	
Ambient temperature [°C]	-25...60
Protection	IP 67

Tests / approvals	
EMC	EN 60947-5-2
MTTF [years]	368

Mechanical data	
Weight [g]	59.5
Housing	rectangular
Materials	diecast zinc; PEI
Lens material	PEI
Lens alignment	side lens

Displays / operating elements		
Display	switching status	1 x LED, yellow
	operation	1 x LED, green

Accessories	
Accessories (supplied)	lock nut: 1 x

Remarks	
Remarks	operating voltage "supply class 2" according to cULus
Pack quantity	1 pcs.

### Electrical connection

Connector: 1 x M12



# OGH280



## Diffuse reflection sensor with background suppression

OGH-HPKG/US/CUBE/100MM

### Connection

