



Model Number

NMB10-18GH50-E2-V1

Features

- 10 mm flush
- Active surface metal
- One-piece housing with stainless steel (V4A; 1.4435)

Accessories

BF 18

Mounting flange, 18 mm

V1-G

Female connector, M12, 4-pin, field attachable

V1-W

Female connector, M12, 4-pin, field attachable

V1-G-2M-PUR

Female cordset, M12, 4-pin, PUR cable

V1-W-2M-PUR

Female cordset, M12, 4-pin, PUR cable

Technical Data

General specifications

Switching function	Normally open (NO)
Output type	PNP
Rated operating distance	s_n 10 mm
Installation	flush in mild steel
Output polarity	DC
Assured operating distance	s_a 0 ... 8.1 mm
Reduction factor r_{AI}	0.4
Reduction factor r_{CU}	0.25
Reduction factor r_{304}	0.5 (0.9 of material thickness 2 mm)
Reduction factor r_{Si37}	1
Output type	3-wire

Nominal ratings

Installation conditions	
A	0 mm
B	16 mm
C	30 mm
F	60 mm
Operating voltage	U_B 10 ... 30 V
Switching frequency	f 0 ... 300 Hz
Hysteresis	H 3 ... 15 typ. 5 %
Reverse polarity protection	yes
Short-circuit protection	yes
Voltage drop	U_d \leq 2 V
Operating current	I_L 0 ... 200 mA
Off-state current	I_r \leq 0.1 mA
No-load supply current	I_0 \leq 10 mA
Time delay before availability	t_v \leq 40 ms
Switching state indicator	LED, yellow

Limit data

Operating pressure statically	60 bar (870.2 psi) max.
-------------------------------	-------------------------

Functional safety related parameters

MTTF _d	655 a
Mission Time (T _M)	20 a
Diagnostic Coverage (DC)	0 %

Ambient conditions

Ambient temperature	-25 ... 85 °C (-13 ... 185 °F)
---------------------	--------------------------------

Mechanical specifications

Connection type	Connector plug M12 x 1, 4-pin
Housing material	Stainless steel 1.4435 / AISI 316L
Sensing face	Stainless steel 1.4435 / AISI 316L
Degree of protection	IP68 / IP69K
Mass	24 g

General information

Assembly dimensions	x: 18 mm y: \geq 4 mm
---------------------	----------------------------

Compliance with standards and directives

Standard conformity	
Standards	EN 60947-5-2:2007 EN 60947-5-2/A1:2012 IEC 60947-5-2:2007 IEC 60947-5-2 AMD 1:2012

Approvals and certificates

UL approval	cULus Listed, General Purpose
CCC approval	CCC approval / marking not required for products rated \leq 36 V

Dimensions

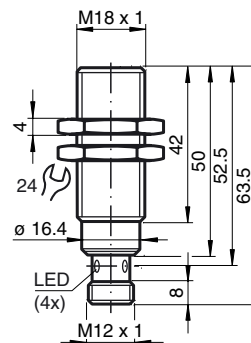

Electrical Connection

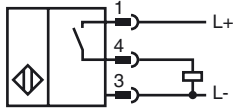

Pinout



Wire colors in accordance with EN 60947-5-2

1	BN	(brown)
2	WH	(white)
3	BU	(blue)
4	BK	(black)

Installation Conditions

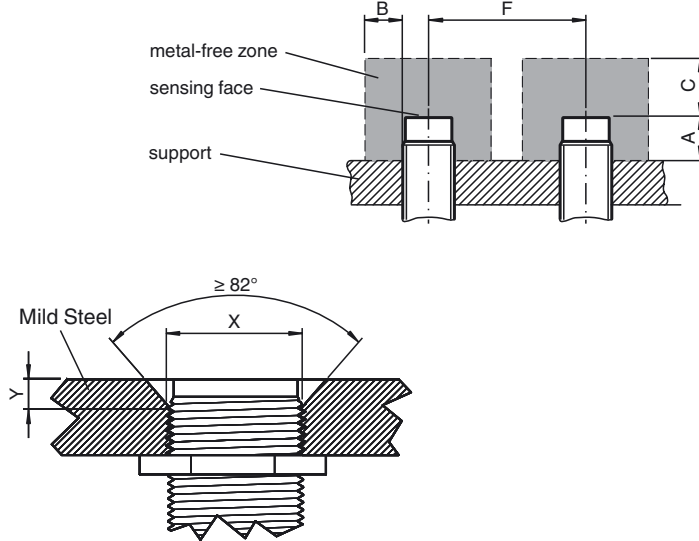

Sensor face is flush with mounting surface.

Release date: 2017-12-20 14:02 Date of issue: 2017-12-20 288265_eng.xml