



Mounting aid ICZ-MH30-25-T10

- For temperatures up to 250 °C (482 °F)
- Free from substances that impair paint wetting
- All edges deburred/chamfered

Spacers for code/data carrier

Dimensions

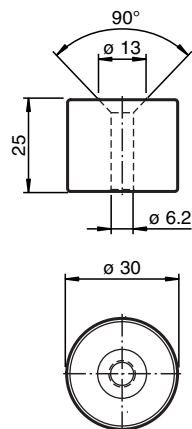

Technical Data

Ambient conditions	
Storage temperature	-40 ... 250 °C (-40 ... 482 °F)
Mechanical specifications	
Material	PTFE

Release date: 2020-03-23 Date of issue: 2020-03-27 Filename: 199282_eng.pdf

Refer to "General Notes Relating to Pepperl+Fuchs Product Information".

Pepperl+Fuchs Group
www.pepperl-fuchs.com

USA: +1 330 486 0001
fa-info@us.pepperl-fuchs.com

Germany: +49 621 776 1111
fa-info@de.pepperl-fuchs.com

Singapore: +65 6779 9091
fa-info@sg.pepperl-fuchs.com

PF PEPPERL+FUCHS