

Inductive slot sensor

SJ3,5-N-Y37091

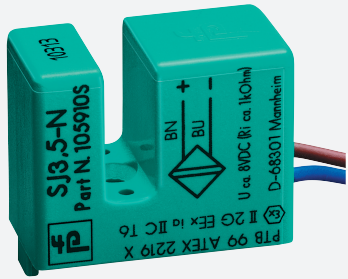

- Special version
- Calibration to B+R segment disc
- 2. actual frequency



Dimensions

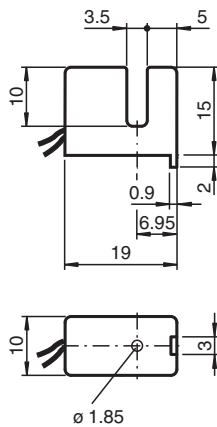

Technical Data

General specifications	
Switching function	Normally closed (NC)
Output type	NAMUR
Slot width	3.5 mm
Depth of immersion (lateral)	5 ... 7 typ. 6 mm
Installation	
Output type	2-wire
Nominal ratings	
Nominal voltage	U_o 8 V
Operating voltage	U_B 5 ... 25 V
Switching frequency	f 0 ... 3000 Hz
Current consumption	
Measuring plate not detected	≥ 3 mA at nominal voltage
Measuring plate detected	≤ 1 mA at nominal voltage
Compliance with standards and directives	
Standard conformity	

Release date: 2020-03-25 Date of issue: 2020-03-30 Filename: 106600_eng.pdf

Refer to "General Notes Relating to Pepperl+Fuchs Product Information".

Pepperl+Fuchs Group
www.pepperl-fuchs.com

USA: +1 330 486 0001
fa-info@us.pepperl-fuchs.com

Germany: +49 621 776 1111
fa-info@de.pepperl-fuchs.com

Singapore: +65 6779 9091
fa-info@sg.pepperl-fuchs.com

PEPPERL+FUCHS

Technical Data

NAMUR		EN 60947-5-6:2000 IEC 60947-5-6:1999
Standards		EN 60947-5-2:2007 EN 60947-5-2/A1:2012 IEC 60947-5-2:2007 IEC 60947-5-2 AMD 1:2012
Approvals and certificates		
UL approval		cULus Listed, General Purpose
CSA approval		cCSAus Listed, General Purpose
Ambient conditions		
Ambient temperature		-25 ... 100 °C (-13 ... 212 °F)
Mechanical specifications		
Connection type		flexible leads LiY , 220 mm
Core cross-section		0.14 mm ²
Housing material		PBT/PPS
Degree of protection		IP67
Equipment protection level Gb		
CE marking		[*PD-Z02585A*]
ATEX marking		⊕ II 2G Ex ia IIC T6...T1 Gb The Ex-related marking can also be printed on the enclosed label.
Standards		EN 60079-0:2012+A11:2013, EN 60079-11:2012 Ignition protection "Intrinsic safety" Use is restricted to the following stated conditions
Appropriate type		SJ3,5-...-N...
Effective internal capacitance	C_i	max. 50 nF ; a cable length of 10 m is considered.
Effective internal inductance	L_i	max. 250 μH ; a cable length of 10 m is considered.
Maximum permissible ambient temperature	T_{amb}	Details of the correlation between the type of circuit connected, the maximum permissible ambient temperature, the temperature class, and the effective internal reactance values can be found on the EU-type examination certificate.
Equipment protection level Da		
CE marking		[*PD-Z02585A*]
ATEX marking		⊕ II 1D Ex ia IIIC T135°C Da The Ex-related marking can also be printed on the enclosed label.
Standards		EN 60079-0:2012+A11:2013, EN 60079-11:2012 Ignition protection "Intrinsic safety" Use is restricted to the following stated conditions
Appropriate type		SJ3,5-...-N...
Effective internal capacitance	C_i	max. 50 μF A cable length of 10 m is considered.
Effective internal inductance	L_i	max. 250 μH A cable length of 10 m is considered.
General information		
Use in the hazardous area		see instruction manuals
Category		2G

Connection

