



**Model Number**

**LC20-DT**

Diagnostic unit for loop detector  
24 V

**Features**

- Compact, easy-to-operate Bluetooth device
- Generation of a full installation report in case of site sign-off
- Performance checks on loop and installation
- Compatible with all LC20 loop detectors
- Operating range of up to 17 m
- Diagnostics via app with integrated diagnostic tools

**Product information**

The easy-to-operate, low-energy Bluetooth diagnostic unit is compatible with LC20 loop detectors. It provides installation/service personnel with feedback on the detector loop installation and the detector configuration setup. This information is used to verify that a loop detector installation is working correctly. Loop detector setup and loop fault analysis with a mobile device avoids access issues and poor visibility of fault-condition displays.

The diagnostic unit attaches to the front of any LC20 loop detector and acquires data from the detector via an optic link. The corresponding diagnostics app supplied free for iOS- or Android-based mobile devices is used to communicate with the LC20 and display the acquired data. Convenient recording and display of settings and measurement data improves fault diagnosis and avoids erroneous data records.

**Dimensions**

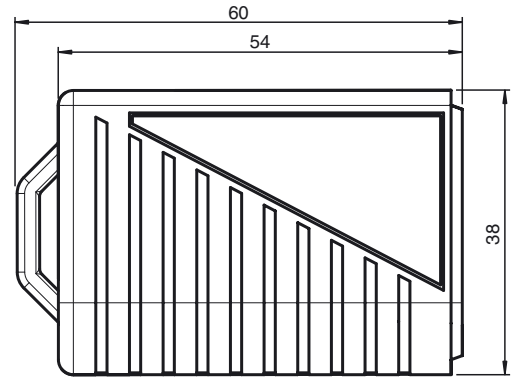
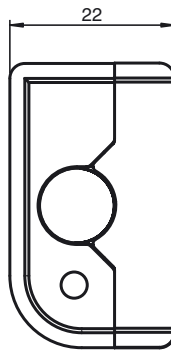

**Indicators/operating means**

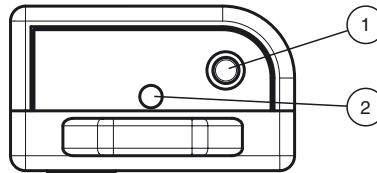

Pos. No.	Operating Elements
1	Button PWR
2	LED

Release date: 2019-07-24 09:03 Date of issue: 2019-08-26 70100682\_eng.xml

## Technical data

### General specifications

Function principle	Inductive loop
Marking	CE
Operating frequency	2.4 GHz (ISM band)

### Indicators/operating means

Function indicator	1 x two-colored LED (red and green) , red flashing: ready for connecting via Bluetooth , green flashing: connected via Bluetooth
--------------------	--

### Electrical specifications

Operating duration	Battery life (standby): $\geq 1250$ days Battery life (continuous operation): $\geq 17$ hours
Power supply	battery operated 1 x 3 V , 240 mAh coin cell battery (CR2032)

### Interface

Interface type	Bluetooth dongle
Physical	Bluetooth v4.0 Detection range $\leq 17$ m

### Directive conformity

Radio and telecommunication terminal equipment	2014/53/EU
--	------------

### System requirements

Operating system	iOs v8.0 or higher , Android v4.4 or higher
------------------	---

### Ambient conditions

Ambient temperature	-5 ... 80 °C (23 ... 176 °F)
Storage temperature	-20 ... 80 °C (-4 ... 176 °F)

### Mechanical specifications

Mass	30 g including CR2032 coin cell battery
------	---

## "LC20-DT" Diagnostic App

The diagnostic app is available free of charge for mobile iOS or Android devices. In the Google Play Store or in the App Store look for "LC20-DT" in order to download it.

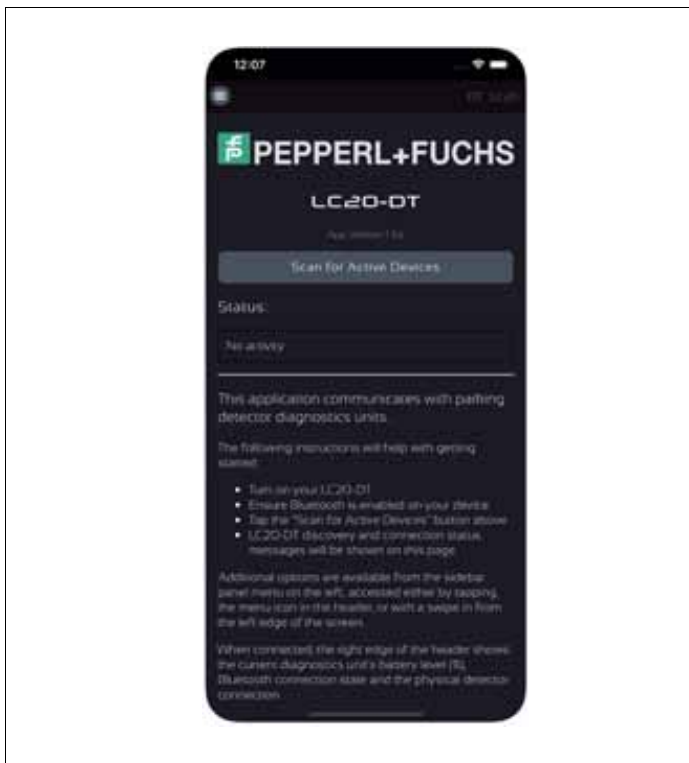

When installed on a suitable mobile device, the diagnostic app receives collected data via its Bluetooth link.

In return, the app displays the following technical information on the loop detector under examination:

1. Loop excitation frequency
2. Loop frequency drift
3. Minimum/maximum level detection
4. Detector DIP Switch Configuration

Service personnel can also use the app to create a report, officially deregister a site, or send it for expert analysis in the event of a suspected failure

## Typical applications

- Park barrier control
- Safety loop
- Arming control
- Motorized gates and doors
- Industrial control systems

## Detection area

