



BUILT-IN FUSE BASE FOR CYLINDRICAL FUSES SIZE
14X51MM 50A,
1POLE+N

Similar to image

Technical data:

Design of the electrical connection		Other
Taille de la cartouche fusible		14x51 mm
Type of mounting		others
Number of poles		1

Certificates/approvals:

General Product Approval

Declaration of Conformity



Further information:

Information- and Downloadcenter (Catalogs, Brochures,...)

<http://www.siemens.com/lowvoltage/catalogs>

Industry Mall (Online ordering system)

<http://www.siemens.com/lowvoltage/mall>

Service&Support (Manuals, Certificates, Characteristics, FAQs,...)

<http://support.automation.siemens.com/WWW/view/en/3NW7151/all>

Image database (product images, 2D dimension drawings, 3D models, device circuit diagrams, ...)

http://www.automation.siemens.com/bilddb/cax_en.aspx?mlfb=3NW7151

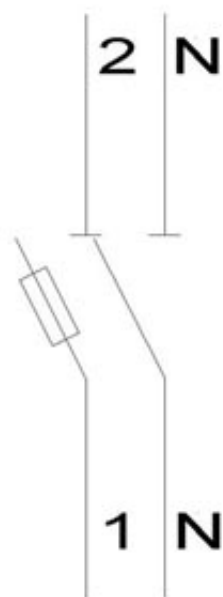
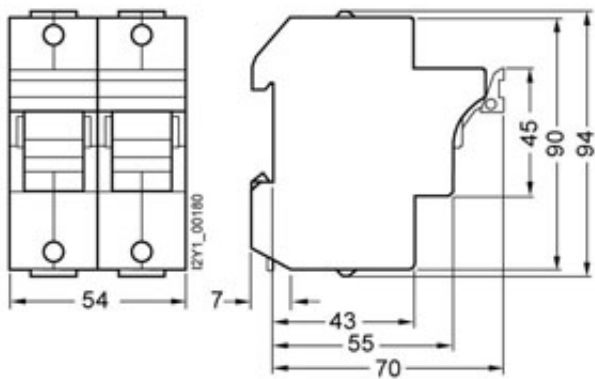

last change:

Feb 4, 2013