



BUILT-IN FUSE BASE WITH SIGNAL DETECTOR FOR CYLINDRICAL FUSES SIZE 8.5X31.5MM 20A, 3-POLE

Similar to image

**Technical data:**

<b>Design of the electrical connection</b>		Other
<b>Taille de la cartouche fusible</b>		others
<b>Type of mounting</b>		others
<b>Number of poles</b>		3

**Certificates/approvals:**

General Product Approval



GOST

**Further information:**

**Information- and Downloadcenter (Catalogs, Brochures,...)**

<http://www.siemens.com/lowvoltage/catalogs>

**Industry Mall (Online ordering system)**

<http://www.siemens.com/lowvoltage/mall>

**Service&Support (Manuals, Certificates, Characteristics, FAQs,...)**

<http://support.automation.siemens.com/WWW/view/en/3NW7334/all>

**Image database (product images, 2D dimension drawings, 3D models, device circuit diagrams, ...)**

[http://www.automation.siemens.com/bilddb/cax\\_en.aspx?mlfb=3NW7334](http://www.automation.siemens.com/bilddb/cax_en.aspx?mlfb=3NW7334)

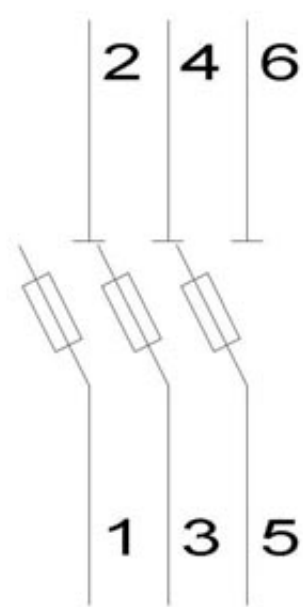
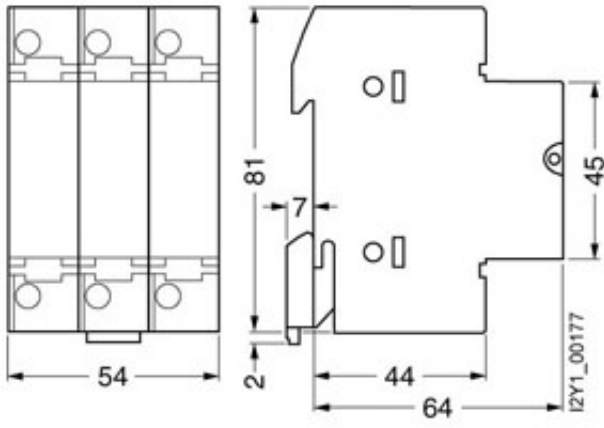

last change:

Feb 4, 2013