

EXTENSION BLOCK 3FOLD,  
CONNECTION MAIN CIRCUIT: SCREW TERMINAL,  
3 SLOTS FOR COMPACT LOAD FEEDERS

General technical data:		
<b>product brand name</b>		SIRIUS
<b>Product designation</b>		3-expansion block
<b>Protection class IP</b>		IP20
<b>Degree of pollution</b>		3
<b>Number of slots</b> • for compact feeder		3
<b>Installation altitude / at a height over sea level</b> • maximum	m	2,000
<b>Ambient temperature</b> • during transport • during storage • during operating	°C	-55 ... +80 °C -55 ... +80 °C -20 ... +60
<b>Resistance against vibration</b>		f = 4 to 5.8 Hz; d = 15 mm; f = 5.8 to 500 Hz; a = 2 m / s <sup>2</sup> 10 cycles
<b>Resistance against shock</b>		Semi-sinusoidal a = 6 m/s <sup>2</sup> at 10 ms; 3 pos. and 3 neg. Shock in all axes
<b>Reference code</b> • according to DIN EN 61346-2 • according to DIN 40719 extended according to IEC 204-2 / according to IEC 750		K K

Main circuit:		
<b>Operating current / at 400 V / for AC</b> • rated value	A	63
<b>Operating voltage / at AC-3 / rated value</b> • maximum	V	690
Installation/mounting/dimensions:		
<b>Mounting type</b>		screw and snap-on mounting
<b>Width</b>	mm	135
<b>Height</b>	mm	197
<b>Depth</b>	mm	100
Connections:		
<b>Design of the electrical connection</b> • for main current circuit		screw-type terminals
<b>Design of screw-type connection</b> • for main contacts		M3
<b>Wire stripping length / for main contacts</b>	mm	10
<b>Tightening torque / for main contacts</b> • with screw-type terminals	N·m	2 ... 2.5
<b>Conductor cross-section that can be connected / for main contacts / for motor outgoing line</b> • unifilar • stranded wire • finely stranded • with conductor end p	mm <sup>2</sup> mm <sup>2</sup> mm <sup>2</sup>	1.5 ... 10 1.5 ... 10 1.5 ... 6
<b>AWG number / as coded connectable conductor cross section / for main contacts</b> • for motor outgoing line		14 ... 8
<b>Type of the connectable conductor cross-section / for main contacts / for motor outgoing line</b> • solid • stranded • stranded wire • with conductor end processing		2x (1.5 ... 6 mm <sup>2</sup> ), 1x (1.5 ... 10 mm <sup>2</sup> ) 2x (1.5 ... 6 mm <sup>2</sup> ), 1x (1.5 ... 10 mm <sup>2</sup> ) 2 x (1.5 ... 6) mm <sup>2</sup>
<b>Type of the connectable conductor cross-section / for AWG-conductors / for main contacts</b> • for motor outgoing line		2 x (16 ... 10), 1 x (16 ... 8)

General Product Approval

EMC



Shipping Approval



other

[Declaration of Conformity](#)

[other](#)

[Environmental Confirmations](#)

Safety:

Protection against electrical shock

finger-safe

Further information:

Information- and Downloadcenter (Catalogs, Brochures,...)

<http://www.siemens.com/industrial-controls/catalogs>

Industry Mall (Online ordering system)

<http://www.siemens.com/industrial-controls/mall>

CAX-Online-Generator

<http://www.siemens.com/cax>

Service&Support (Manuals, Certificates, Characteristics, FAQs,...)

<http://support.automation.siemens.com/WWW/view/en/3RA6823-0AB/all>

Image database (product images, 2D dimension drawings, 3D models, device circuit diagrams, ...)

[http://www.automation.siemens.com/bilddb/cax\\_en.aspx?mlfb=3RA6823-0AB](http://www.automation.siemens.com/bilddb/cax_en.aspx?mlfb=3RA6823-0AB)

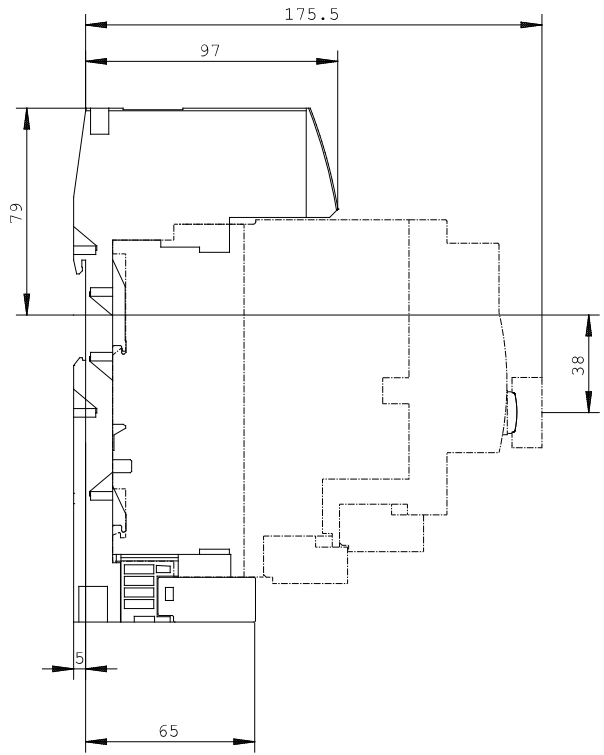
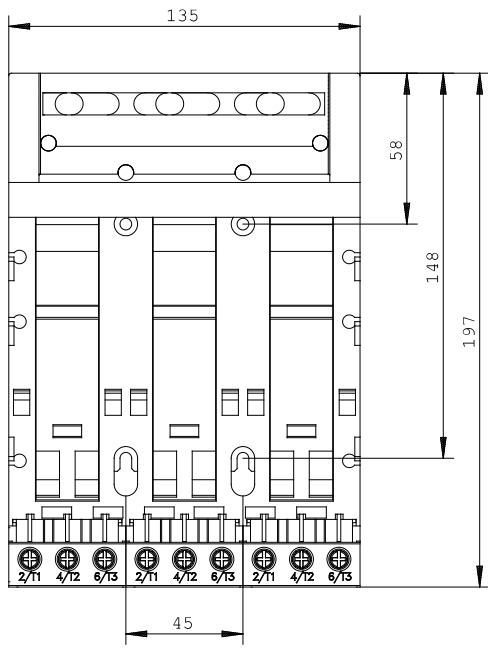

last change:

Jul 7, 2014