



TIME RELAY, ON-DELAY, 1 SEMICONDUCTOR,  
4 RANGES (1,4,32,256 NO),  
AC/DC 24...66 V, 2-WIRE,

General technical data:		
product brand name		SIRIUS
Product designation		timing relay
Protection class IP / of the terminal		IP20
mounting position		any
Product function		
<ul style="list-style-type: none"> <li>at the relay outputs / changeover delayed/without delay</li> </ul>		No
Product component / semi-conductor output		Yes
Product extension / optional / remote control		No
Product extension / strictly required / remote control		No
Installation altitude / at a height over sea level / maximum	m	2,000
Ambient temperature		
<ul style="list-style-type: none"> <li>during storage</li> </ul>	°C	-40 ... +85
<ul style="list-style-type: none"> <li>during operating</li> </ul>	°C	-25 ... +60
<ul style="list-style-type: none"> <li>during transport</li> </ul>	°C	-40 ... +85
Relative humidity		
<ul style="list-style-type: none"> <li>during operating phase</li> </ul>	%	15 ... 70
Conductor-bound parasitic coupling BURST / according to IEC 61000-4-4		2 kV network connection / 1 kV control connection
Conductor-bound parasitic coupling conductor-earth SURGE / according to IEC 61000-4-5		2 kV

<b>Conductor-bound parasitic coupling conductor-conductor SURGE / according to IEC 61000-4-5</b>		1 kV
<b>Electrostatic discharge / according to IEC 61000-4-2</b>		4 kV contact discharge / 8 kV air discharge
<b>Field-bound parasitic coupling / according to IEC 61000-4-3</b>		10 V/m
<b>Impulse voltage resistance / rated value</b>	V	4,000
<b>Active power loss / total / typical</b>	W	1
<b>Reference code / according to DIN 40719 extended according to IEC 204-2 / according to IEC 750</b>		K
<b>Reference code / according to DIN EN 61346-2</b>		K
<b>Category / according to EN 954-1</b>		none
<b>Protection against electrical shock</b>		finger-safe

#### Switching Function:

<b>Switching function</b>		
• slow-operating		Yes
• making pulse contact		No
• relapse delayed		No
• with control signal		
• additive ON delay		No
• passing break contact		No
• OFF delay		No
• slow-operating/instantaneous contact		No
• with control signal		
• OFF delay/instantaneous		No
• ON delay/OFF delay/instantaneous		No
• making pulse contact/instantaneous contact		No
• with control signal		
• passing break contact/instantaneous		No
• pulse-shaping/instantaneous		No
<b>Adjustable time</b>	s	0.05 ... 240

#### Control circuit/ Control:

<b>Voltage type / of control feed voltage</b>		AC/DC
<b>Control supply voltage frequency</b>		
• 1	Hz	50 ... 60
<b>Control supply voltage</b>		
• 1		
• at 50 Hz		
• for AC	V	24 ... 66
• at 60 Hz		
• for AC	V	24 ... 66

• for DC	V	24 ... 66
<b>Operating range factor control supply voltage rated value</b>		
• at 50 Hz		
• for AC		0.85 ... 1.1
• at 60 Hz		
• for AC		0.85 ... 1.1
• for DC		0.8 ... 1.1

#### Auxiliary circuit:

<b>Operating current / of auxiliary contacts</b>		
• at DC-13		
• minimum	A	0.01
• maximum	A	0.6
• for AC-140		
• maximum	A	0.01
• maximum	A	0.6
<b>Number of NC contacts / delayed switching</b>		0
<b>Number of NC contacts / non-delayed</b>		0
<b>Number of NO contacts / delayed switching</b>		1
<b>Number of NO contacts / non-delayed</b>		0
<b>Number of change-over switches / delayed switching</b>		0
<b>Number of change-over switches / non-delayed</b>		0

#### Short-circuit:

<b>Design of the fuse link / for short-circuit protection of the auxiliary switch / required</b>		fuse gL/gG: 4 A
<b>Mounting type</b>		screw and snap-on mounting onto 35 mm standard mounting rail

#### Installation/ mounting/ dimensions:

<b>Width</b>	mm	22.5
<b>Height</b>	mm	83
<b>Depth</b>	mm	91
<b>Distance, to be maintained, to the ranks assembly</b>		
• upwards	mm	0
• forwards	mm	0
• sideways	mm	0
• backwards	mm	0
• downwards	mm	0
<b>Distance, to be maintained, to earthed part</b>		
• backwards	mm	0
• sideways	mm	0

• upwards	mm	0
• forwards	mm	0
• downwards	mm	0
<b>Distance, to be maintained, conductive elements</b>		
• downwards	mm	0
• backwards	mm	0
• sideways	mm	0
• forwards	mm	0
• upwards	mm	0

#### Connections/ terminals:

##### Design of the electrical connection

- for auxiliary and control current circuit

screw-type terminals

##### General Product Approval

##### Declaration of Conformity

##### Test Certificates



[Special Test Certificate](#)

CSA

UL

EG-Konf.

##### Shipping Approval



BUREAU  
VERITAS

DNV

LRS

PRS

RINA

RMRS

##### other

[Confirmation](#)

[other](#)

[Environmental Confirmations](#)

#### Further information:

##### Information- and Downloadcenter (Catalogs, Brochures,...)

<http://www.siemens.com/industrial-controls/catalogs>

##### Industry Mall (Online ordering system)

<http://www.siemens.com/industrial-controls/mall>

##### Cax online generator

<http://www.siemens.com/cax>

##### Service&Support (Manuals, Certificates, Characteristics, FAQs,...)

<http://support.automation.siemens.com/WW/view/en/3RP1527-1EC30/all>

##### Image database (product images, 2D dimension drawings, 3D models, device circuit diagrams, ...)

[http://www.automation.siemens.com/bilddb/cax\\_en.aspx?mlfb=3RP1527-1EC30](http://www.automation.siemens.com/bilddb/cax_en.aspx?mlfb=3RP1527-1EC30)

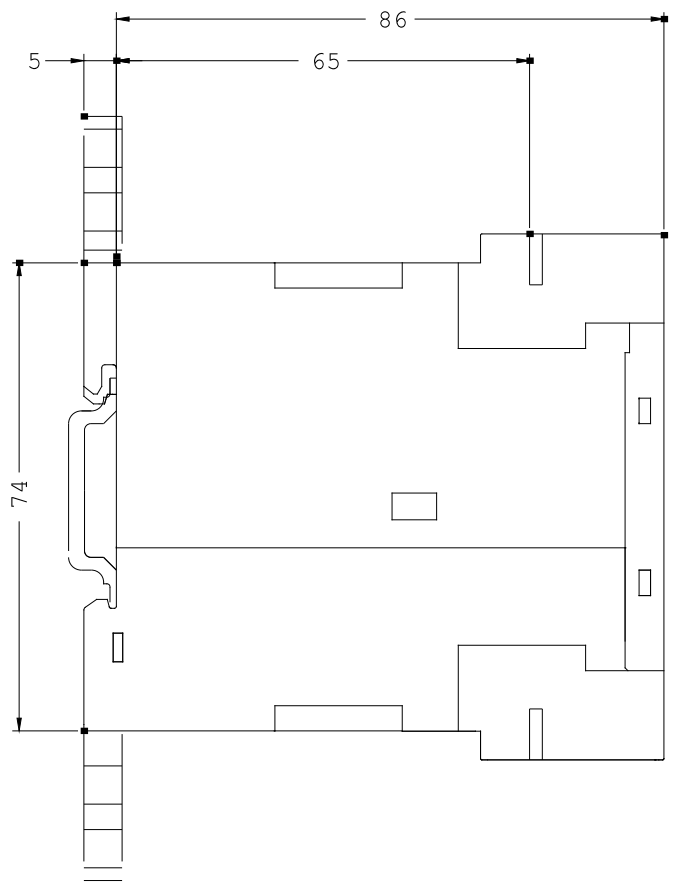
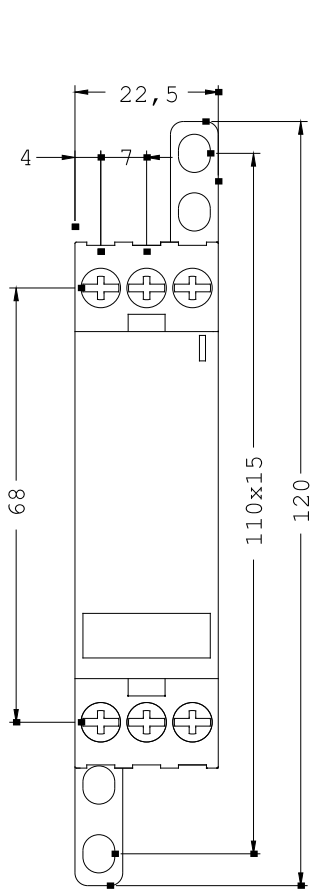

last change:

Jul 28, 2014