



CONTACTOR,  
25HP 460/575V AC 480V 60HZ 3-POLE,  
SIZE S2 SCREW CONNECTION NEMA SIZE 2

#### General technical data:

<b>product brand name</b>		SIRIUS
<b>Size of the contactor</b>		S2
<b>Protection class IP / on the front</b>		IP20
<b>Degree of pollution</b>		3
<b>Installation altitude / at a height over sea level / maximum</b>	m	2,000
<b>Ambient temperature / during operating</b>	°C	-25 ... +60
<b>Mechanical operating cycles as operating time</b>		
<ul style="list-style-type: none"> <li>• of the contactor / typical</li> </ul>		10,000,000
<ul style="list-style-type: none"> <li>• of the contactor with added auxiliary switch block / typical</li> </ul>		10,000,000
<ul style="list-style-type: none"> <li>• of the contactor with added electronics-compatible auxiliary switch block / typical</li> </ul>		5,000,000

#### Main circuit:

<b>Number of NC contacts / for main contacts</b>		0
<b>Number of NO contacts / for main contacts</b>		3
<b>Operating current</b>		
<ul style="list-style-type: none"> <li>• at AC-1 / at 400 V <ul style="list-style-type: none"> <li>• at 40 °C ambient temperature / rated value</li> </ul> </li> </ul>	A	60
<ul style="list-style-type: none"> <li>• at AC-3 / at 400 V / rated value</li> </ul>	A	50
<ul style="list-style-type: none"> <li>• at AC-4 / at 400 V / rated value</li> </ul>	A	41

<ul style="list-style-type: none"> <li>with 1 current path / at DC-1 <ul style="list-style-type: none"> <li>at 24 V / rated value</li> <li>at 110 V / rated value</li> </ul> </li> </ul>	A	55
	A	4.5
<ul style="list-style-type: none"> <li>with 2 current paths in series / at DC-1 <ul style="list-style-type: none"> <li>at 24 V / rated value</li> <li>at 110 V / rated value</li> </ul> </li> </ul>	A	55
	A	25
<ul style="list-style-type: none"> <li>with 3 current paths in series / at DC-1 <ul style="list-style-type: none"> <li>at 24 V / rated value</li> <li>at 110 V / rated value</li> </ul> </li> </ul>	A	55
	A	55
<ul style="list-style-type: none"> <li>with 1 current path / at DC-3 / at DC-5 <ul style="list-style-type: none"> <li>at 24 V / rated value</li> <li>at 110 V / rated value</li> </ul> </li> </ul>	A	35
	A	2.5
<ul style="list-style-type: none"> <li>with 2 current paths in series / at DC-3 / at DC-5 <ul style="list-style-type: none"> <li>at 24 V / rated value</li> <li>at 110 V / rated value</li> </ul> </li> </ul>	A	55
	A	25
<ul style="list-style-type: none"> <li>with 3 current paths in series / at DC-3 / at DC-5 <ul style="list-style-type: none"> <li>at 24 V / rated value</li> <li>at 110 V / rated value</li> </ul> </li> </ul>	A	55
	A	55
<b>Service power</b>		
<ul style="list-style-type: none"> <li>at AC-2 / at 400 V / rated value</li> </ul>	kW	22
<ul style="list-style-type: none"> <li>at AC-3 / at 400 V / rated value</li> </ul>	kW	22
<ul style="list-style-type: none"> <li>at AC-4 / at 400 V / rated value</li> </ul>	W	22,000

Control circuit:		
<b>Voltage type / of control feed voltage</b>		AC
<b>Operating range factor control supply voltage rated value / of the magnet coil</b>		
<ul style="list-style-type: none"> <li>at 60 Hz</li> <li>for AC</li> </ul>		0.8 ... 1.1
<b>Apparent pull-in power / of the solenoid / for AC</b>	V·A	166
<b>Apparent holding power / of the solenoid / for AC</b>	V·A	12.6
<b>Inductive power factor / with the pull-in power of the coil</b>		0.71
<b>Inductive power factor / with the pull-in power of the coil</b>		0.37

Auxiliary circuit:		
<b>Contact reliability / of the auxiliary contacts</b>		1 faulty switching per 100 million (17 V, 1 mA)
<b>Number of NC contacts / for auxiliary contacts / instantaneous switching</b>		0
<b>Number of NO contacts / for auxiliary contacts / instantaneous switching</b>		0

### Short-circuit:

<b>Design of the fuse link</b>	• for short-circuit protection of the auxiliary switch / required	fuse gL/gG: 10 A
	• for short-circuit protection of the main circuit	fuse gL/gG: 160 A
	• with type of assignment 1 / required	fuse gL/gG: 80 A
	• at type of coordination 2 / required	

#### Installation/mounting/dimensions:

<b>Mounting type</b>		screw and snap-on mounting onto 35 mm standard mounting rail according to DIN EN 50022
<b>series installation</b>		Yes
<b>Width</b>	mm	55
<b>Height</b>	mm	112
<b>Depth</b>	mm	115
<b>Distance, to be maintained, to earthed part / sideways</b>	mm	6

#### Connection type:

<b>Design of the electrical connection</b>	• for main current circuit	screw-type terminals
	• for auxiliary and control current circuit	screw-type terminals
<b>Type of the connectable conductor cross-section</b>	• for main contacts	
	• solid	2x (0.75 ... 16 mm <sup>2</sup> )
	• stranded	2x (0.75 ... 25 mm <sup>2</sup> )
	• finely stranded	
	• with conductor end processing	2x (0.75 ... 16 mm <sup>2</sup> )
	• without conductor final cutting	2x (0.75 ... 16 mm <sup>2</sup> )
	• for AWG conductors / for main contacts	2x (18 ... 2)
	• for auxiliary contacts	
• solid	2x (0.5 ... 1.5 mm <sup>2</sup> ), 2x (0.75 ... 2.5 mm <sup>2</sup> ), max. 2x (0.75 ... 4 mm <sup>2</sup> )	
• finely stranded		
• with conductor end processing	2x (0.5 ... 1.5 mm <sup>2</sup> ), 2x (0.75 ... 2.5 mm <sup>2</sup> )	
• for AWG conductors / for auxiliary contacts	2x (20 ... 16), 2x (18 ... 14), 1x 12	

#### Certificates/approvals:

<b>General Product Approval</b>	<b>Functional Safety / Safety of Machinery</b>	<b>Declaration of Conformity</b>	<b>Test Certificates</b>
---------------------------------	--	----------------------------------	--------------------------



[Type Examination](#)



EG-Konf.

[Special Test Certificate](#)

[Type Test Certificates/Test Report](#)

### Shipping Approval



ABS



BUREAU  
VERITAS



DNV



GL



LRS



RINA

### Shipping Approval

other



RMRS

[Confirmation](#)

[other](#)

[Environmental Confirmations](#)

### Further information:

#### Information- and Downloadcenter (Catalogs, Brochures,...)

<http://www.siemens.com/industrial-controls/catalogs>

#### Industry Mall (Online ordering system)

<http://www.siemens.com/industrial-controls/mall>

#### Cax online generator:

<http://www.siemens.com/cax>

#### Service&Support (Manuals, Certificates, Characteristics, FAQs,...)

<http://support.automation.siemens.com/WW/view/en/3RT1036-1AV60-0UA0/all>

#### Image database (product images, 2D dimension drawings, 3D models, device circuit diagrams, ...)

[http://www.automation.siemens.com/bilddb/cax\\_en.aspx?mlfb=3RT1036-1AV60-0UA0](http://www.automation.siemens.com/bilddb/cax_en.aspx?mlfb=3RT1036-1AV60-0UA0)

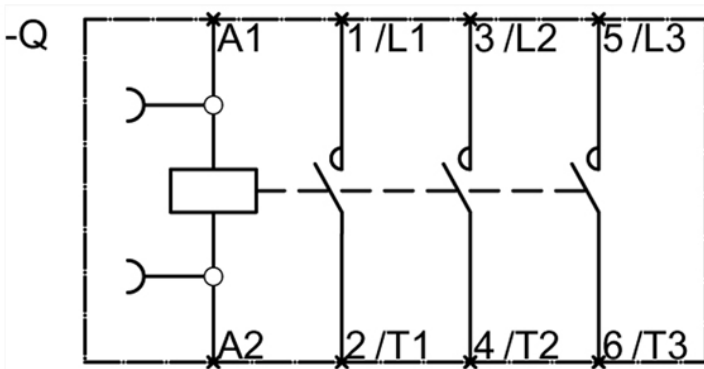
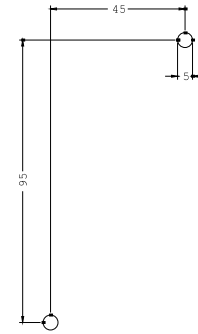
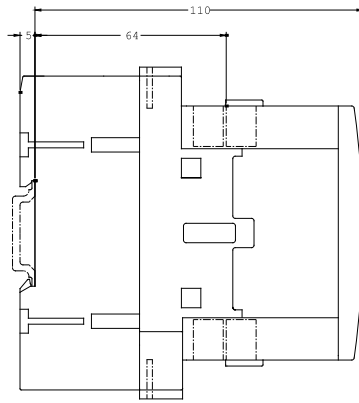
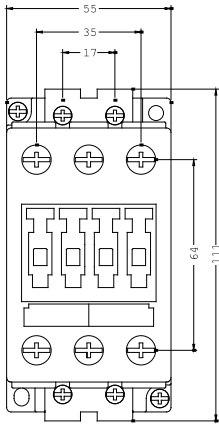

last change:

Jul 28, 2014