



SOLID-STATE TWO-WIRE TIME RELAY SETTING RANGE  
0.5 S...10 S,  
AC/DC 24...66 V, ON-DELAY,  
WITH VARISTOR FOR MOUNTING ONTO CONTACTORS  
SIZE S0...S3

### General technical data:

<b>product brand name</b>		SIRIUS
<b>Product designation</b>		timing relay
<b>Design of the product</b>		slow-operating
<b>Type of voltage</b>		AC
<b>Size of the contactor / can be combined / company-specific</b>		S0 ... S3
<b>Product function</b>		
• star-delta circuit		No
• at the relay outputs / changeover delayed/without delay		No
<b>Product component / semi-conductor output</b>		Yes
<b>Product extension / optional / remote control</b>		No
<b>Product extension / strictly required / remote control</b>		No
<b>Adjustable time</b>	s	0.5 ... 10
<b>Ambient temperature</b>		
• during operating	°C	-25 ... +60
<b>Reference code</b>		
• according to DIN 40719 extended according to IEC 204-2 / according to IEC 750		K
• according to DIN EN 61346-2		K

### Switching Function:

<b>Switching function</b>		
• slow-operating		Yes
• making pulse contact		No
• firmly clocked beginning with pulse		No
• firmly clocked beginning with pause		No
• relapse delayed		No
• variably clocked start with impulse		No
• impuls variably clocked start with pause		No
• with control signal		
• additive ON delay		No
• passing break contact		No
• OFF delay		No
• without control signal / OFF delay		No

### Auxiliary circuit:

<b>Supply voltage frequency / for auxiliary and control current circuit</b>		
• rated value	Hz	50 ... 60
<b>Supply voltage / strictly required / auxiliary voltage</b>		No
<b>Control supply voltage</b>		
• at 50 Hz / at AC		
• rated value	V	24 ... 66
• at 60 Hz / at AC		
• rated value	V	24 ... 66

### Installation/mounting/dimensions:

<b>Width</b>	mm	45
<b>Height</b>	mm	26
<b>Depth</b>	mm	50

### Connections:

<b>Design of the electrical connection</b>		
• jumper socket		No
• for auxiliary and control current circuit		screw-type terminals

### Certificates/approvals:

<b>General Product Approval</b>	<b>EMC</b>	<b>Functional Safety / Safety of Machinery</b>
---------------------------------	------------	--



CCC



CSA



UL



C-TICK

[Type Examination](#)

**Declaration of Conformity**

**Test Certificates**



EG-Konf.

[Special Test Certificate](#)

**Shipping Approval**



ABS



BUREAU  
VERITAS



DNV



GL



LRS



PRS

**Shipping Approval**

**other**



RINA



RMRS

[Confirmation](#)

[Declaration of Conformity](#)

[other](#)

[Environmental Confirmations](#)

**Further information:**

**Information- and Downloadcenter (Catalogs, Brochures,...)**

<http://www.siemens.com/industrial-controls/catalogs>

**Industry Mall (Online ordering system)**

<http://www.siemens.com/industrial-controls/mall>

**CAX-Online-Generator**

<http://www.siemens.com/cax>

**Service&Support (Manuals, Certificates, Characteristics, FAQs,...)**

<http://support.automation.siemens.com/WW/view/en/3RT1926-2CG21/all>

**Image database (product images, 2D dimension drawings, 3D models, device circuit diagrams, ...)**

[http://www.automation.siemens.com/bilddb/cax\\_en.aspx?mlfb=3RT1926-2CG21](http://www.automation.siemens.com/bilddb/cax_en.aspx?mlfb=3RT1926-2CG21)

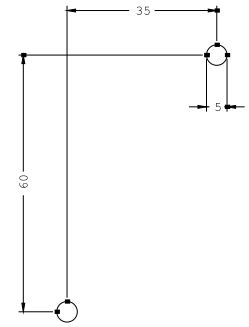
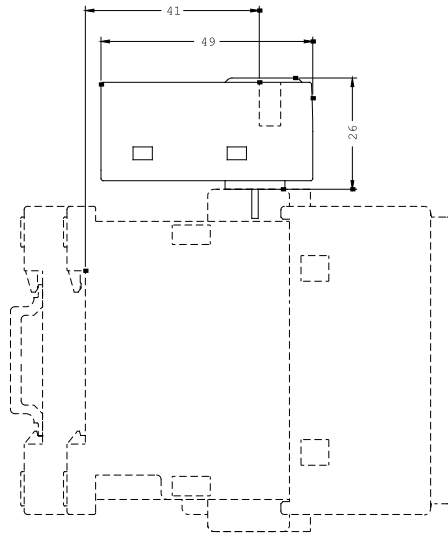
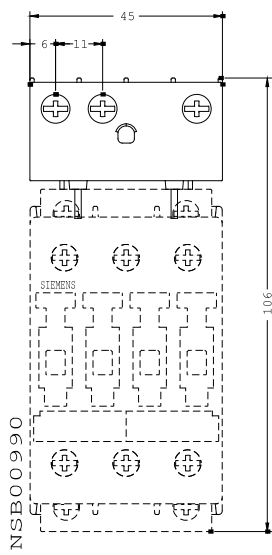

last change:

Jun 16, 2014