



ELECTRONIC TIME RELAY WITH SEMICONDUCTOR OUTPUT,
 TIME RANGE 5...100S, 24...66 V AC/DC,
 OFF DELAY,
 W. VARISTOR WITH SCREW TERMINAL FOR CONTACTORS SIZE S0...S3

General technical data:		
product brand name		SIRIUS
Product designation		timing relay
Design of the product		off-delayed with auxiliary voltage
Type of voltage		AC
Size of the contactor / can be combined / company-specific		S0 ... S3
Product function		
<ul style="list-style-type: none"> star-delta circuit 		No
<ul style="list-style-type: none"> at the relay outputs / changeover delayed/without delay 		No
Product component / semi-conductor output		Yes
Product extension / optional / remote control		No
Product extension / strictly required / remote control		No
Adjustable time	s	5 ... 100
Ambient temperature		
<ul style="list-style-type: none"> during operating 	°C	-25 ... +60
Reference code		
<ul style="list-style-type: none"> according to DIN 40719 extended according to IEC 204-2 / according to IEC 750 		K
<ul style="list-style-type: none"> according to DIN EN 61346-2 		K

Switching Function:

Switching function		
• slow-operating		No
• making pulse contact		No
• firmly clocked beginning with pulse		No
• firmly clocked beginning with pause		No
• relapse delayed		Yes
• variably clocked start with impulse		No
• impuls variably clocked start with pause		No
• with control signal		
• additive ON delay		No
• passing break contact		No
• OFF delay		Yes
• without control signal / OFF delay		No

Auxiliary circuit:

Supply voltage frequency / for auxiliary and control current circuit		
• rated value	Hz	50 ... 60
Supply voltage / strictly required / auxiliary voltage		Yes
Control supply voltage		
• at 50 Hz / at AC		
• rated value	V	24 ... 66
• at 60 Hz / at AC		
• rated value	V	24 ... 66

Installation/mounting/dimensions:

Width	mm	45
Height	mm	26
Depth	mm	50

Connections:

Design of the electrical connection		
• jumper socket		No
• for auxiliary and control current circuit		screw-type terminals

Certificates/approvals:

General Product Approval	EMC	Functional Safety / Safety of Machinery
---------------------------------	------------	------------------------------------------------



CCC



CSA



UL



C-TICK

[Type Examination](#)

Declaration of Conformity

Test Certificates



EG-Konf.

[Special Test Certificate](#)

Shipping Approval



ABS



BUREAU
VERITAS



DNV



GL



LRS



PRS

Shipping Approval

other



RINA



RMRS

[Confirmation](#)

[Declaration of Conformity](#)

[other](#)

[Environmental Confirmations](#)

Further information:

Information- and Downloadcenter (Catalogs, Brochures,...)

<http://www.siemens.com/industrial-controls/catalogs>

Industry Mall (Online ordering system)

<http://www.siemens.com/industrial-controls/mall>

CAX-Online-Generator

<http://www.siemens.com/cax>

Service&Support (Manuals, Certificates, Characteristics, FAQs,...)

<http://support.automation.siemens.com/WW/view/en/3RT1926-2DG31/all>

Image database (product images, 2D dimension drawings, 3D models, device circuit diagrams, ...)

http://www.automation.siemens.com/bilddb/cax_en.aspx?mlfb=3RT1926-2DG31

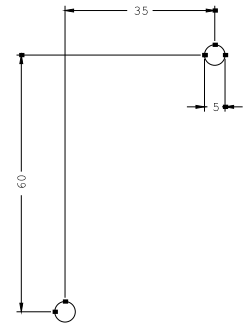
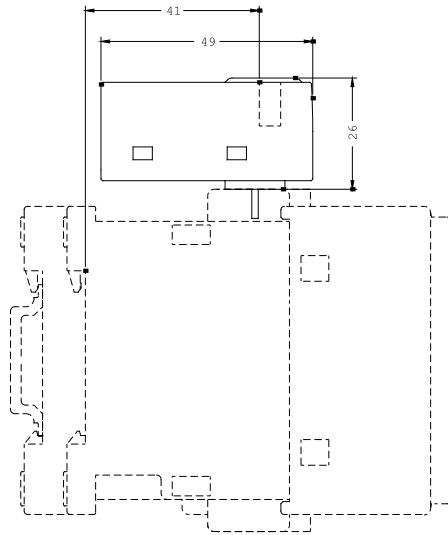
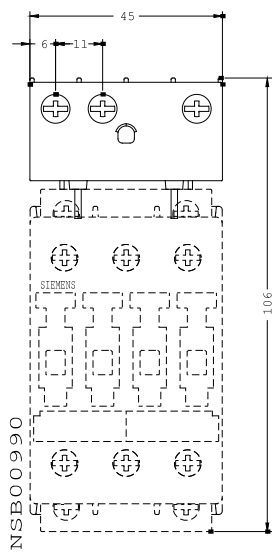

last change:

Jun 16, 2014