



CIRCUIT-BREAKER SZ S00,  
FOR MOTOR PROTECTION, CLASS 10,  
A-REL. 0.7...1A, N-RELEASE 13A,  
SCREW CONNECTION,  
STANDARD SW. CAPACITY,  
W. TRANSVERSE AUX. SWITCH 1NO+1NC

**General technical data:**

|  |    |                      |
|--|----|----------------------|
| <b>product brand name</b>                              |    | SIRIUS               |
| <b>product designation</b>                             |    | 3RV2 circuit breaker |
| <b>Size of the circuit-breaker</b>                     |    | S00                  |
| <b>Number of poles / for main current circuit</b>      |    | 3                    |
| <b>Product function</b>                                |    |                      |
| • removable terminal for auxiliary and control circuit |    | No                   |
| • overload protection                                  |    | Yes                  |
| • phase disturbance recognition                        |    | Yes                  |
| • short-circuit to earth recognition                   |    | No                   |
| <b>Product component</b>                               |    |                      |
| • auxiliary switch                                     |    | Yes                  |
| • undervoltage release mechanism                       |    | No                   |
| • trip indicator                                       |    | No                   |
| <b>Product extension</b>                               |    |                      |
| • auxiliary switch                                     |    | Yes                  |
| • optional / motor drive                               |    | No                   |
| <b>Impulse voltage resistance / rated value</b>        | kV | 6                    |
| <b>Protection class IP / on the front</b>              |    | IP20                 |
| <b>Protection against electrical shock</b>             |    | finger-safe          |

|   |    |             |
|---|----|-------------|
| <b>Installation altitude / at a height over sea level / maximum</b> | m  | 2,000       |
| <b>Resistance against shock</b>                                     |    | 25g / 11 ms |
| <b>Ambient temperature</b>  |    |             |
| • during transport  | °C | -50 ... +80 |
| • during storage  | °C | -50 ... +80 |
| • during operating  | °C | -20 ... +60 |
| <b>Active power loss / total / typical</b>                          | W  | 5.1         |

#### Main circuit:

|   |     |         |
|---|-----|---------|
| <b>Operating voltage / rated value</b>  | V   | 690     |
| <b>Service power / at AC-3</b>  |     |         |
| • at 400 V / rated value  | W   | 250     |
| • at 500 V / rated value  | W   | 370     |
| • at 690 V / rated value  | W   | 550     |
| <b>Operational current / at AC-3 / at 400 V / rated value</b>                         | A   | 1       |
| <b>Mechanical operating cycles as operating time / of the main contacts / typical</b> |     | 100,000 |
| <b>Frequency of operation / at AC-3 / according to IEC 60947-6-2</b>                  | 1/h | 15      |

#### Auxiliary circuit:

|  |   |   |
|--|---|---|
| <b>Design of the auxiliary switch</b>  |   | transverse  |
| <b>Number of change-over switches / for auxiliary contacts</b>                                   |   | 0   |
| <b>Mechanical operating cycles as operating time / of the auxiliary contacts / typical</b>       |   | 100,000   |
| <b>Design of the fuse link / for short-circuit protection of the auxiliary switch / required</b> |   | Fuse gL/gG: 10 A, miniature circuit breaker C 6 A (short-circuit current $I_k < 400$ A) |
| <b>Operating current / of the auxiliary contacts / at AC-15 / at 24 V</b>                        | A | 2   |
| <b>Operating current / of the auxiliary contacts</b>   |   |   |
| • at AC-15   |   |   |
| • at 230 V   | A | 0.5   |
| • at DC-13   |   |   |
| • at 24 V  | A | 1   |
| • at 60 V  | A | 0.15  |

#### Protection function:

|  |   |           |
|--|---|-----------|
| <b>Trip class</b>  |   | CLASS 10  |
| <b>Adjustable response current / of the current-dependent overload release</b> | A | 0.7 ... 1 |
| <b>Breaking capacity limit short-circuit current (<math>I_{cu}</math>)</b>     |   |           |
| • at 400 V / rated value   | A | 100,000   |
| • at 500 V / rated value   | A | 100,000   |
| • at 690 V / rated value   | A | 100,000   |

**Safety:****Proportion of dangerous failures**

- with high demand rate / according to SN 31920
- with low demand rate / according to SN 31920

|   |    |
|---|----|
| % | 40 |
| % | 40 |

**Failure rate (FIT value) / with low demand rate / according to SN 31920**

|     |    |
|-----|----|
| FIT | 50 |
|-----|----|

**B10 value / with high demand rate / according to SN 31920**

|  |        |
|--|--------|
|  | 50,000 |
|--|--------|

**T1 value / for proof test interval or service life / according to IEC 61508**

|   |    |
|---|----|
| a | 10 |
|---|----|

**Installation/mounting/dimensions:****Type of mounting**

|  |  |
|--|--|
|  | screw and snap-on mounting onto 35 mm standard mounting rail according to DIN EN 60715 |
|--|--|

**mounting position**

|  |     |
|--|-----|
|  | any |
|--|-----|

**Depth**

|    |    |
|----|----|
| mm | 96 |
|----|----|

**Height**

|    |    |
|----|----|
| mm | 97 |
|----|----|

**Width**

|    |    |
|----|----|
| mm | 45 |
|----|----|

**Connections:****Arrangement of electrical connectors / for main current circuit**

|  |                |
|--|----------------|
|  | Top and bottom |
|--|----------------|

**Design of the electrical connection**

- for main current circuit
- for auxiliary and control current circuit

|  |                      |
|--|----------------------|
|  | screw-type terminals |
|  | screw-type terminals |

**Type of the connectable conductor cross-section**

- for main contacts
  - solid
  - finely stranded
    - with conductor end processing
- for AWG conductors / for main contacts
- for auxiliary contacts
  - solid
  - finely stranded
    - with conductor end processing
- for AWG conductors / for auxiliary contacts

|  |   |
|--|---|
|  | 2x (0.75 ... 2.5 mm <sup>2</sup> ), 2x 4 mm <sup>2</sup>              |
|  | 2x (0.5 ... 1.5 mm <sup>2</sup> ), 2x (0.75 ... 2.5 mm <sup>2</sup> ) |
|  | 2x (18 ... 14), 2x 12   |
|  | 2x (0.5 ... 1.5 mm <sup>2</sup> ), 2x (0.75 ... 2.5 mm <sup>2</sup> ) |
|  | 2x (0.5 ... 1.5 mm <sup>2</sup> ), 2x (0.75 ... 2.5 mm <sup>2</sup> ) |
|  | 2x (20 ... 16), 2x (18 ... 14)  |

**UL/CSA ratings:****yielded mechanical performance (hp)**

- for three-phase squirrel cage motors
  - at 575/600 V / rated value

|    |     |
|----|-----|
| hp | 0.5 |
|----|-----|

**Operating current (FLA) / for three-phase squirrel cage motors**

- at 600 V / rated value

|   |     |
|---|-----|
| A | 0.9 |
|---|-----|

Contact rating designation / for auxiliary contacts / according to UL

C300 / R300

Certificates/approvals:

General Product Approval

For use in hazardous locations

Declaration of Conformity

Test Certificates



[Special Test Certificate](#)

[Type Test Certificates/Test Report](#)

Shipping Approval

other



[other](#)

Further information:

Information- and Downloadcenter (Catalogs, Brochures,...)

<http://www.siemens.com/industrial-controls/catalogs>

Industry Mall (Online ordering system)

<http://www.siemens.com/industrial-controls/mall>

Cax online generator:

<http://www.siemens.com/cax>

Service&Support (Manuals, Certificates, Characteristics, FAQs,...)

<http://support.automation.siemens.com/WW/view/en/3RV2011-0JA15-ZX95/all>

Image database (product images, 2D dimension drawings, 3D models, device circuit diagrams, ...)

[http://www.automation.siemens.com/bilddb/cax\\_en.aspx?mlfb=3RV2011-0JA15-ZX95](http://www.automation.siemens.com/bilddb/cax_en.aspx?mlfb=3RV2011-0JA15-ZX95)

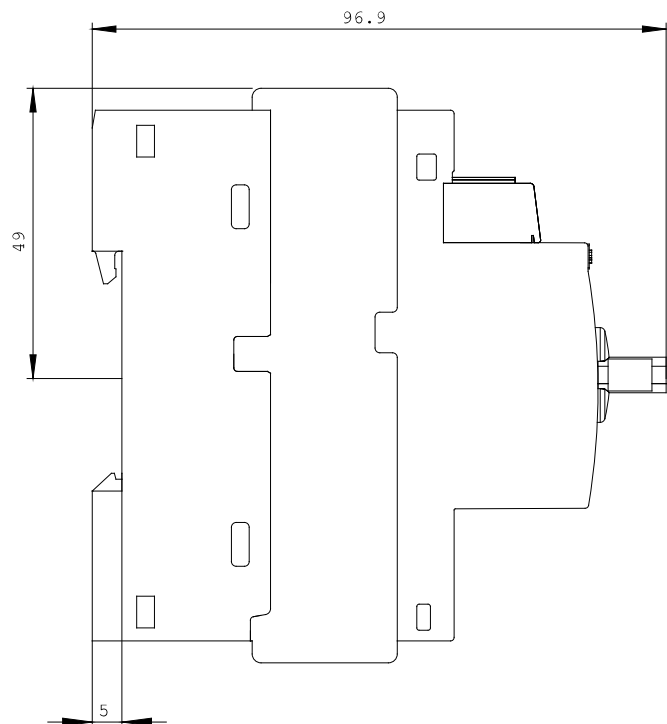
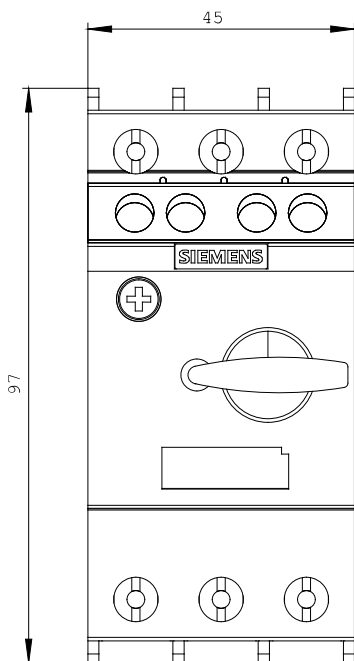

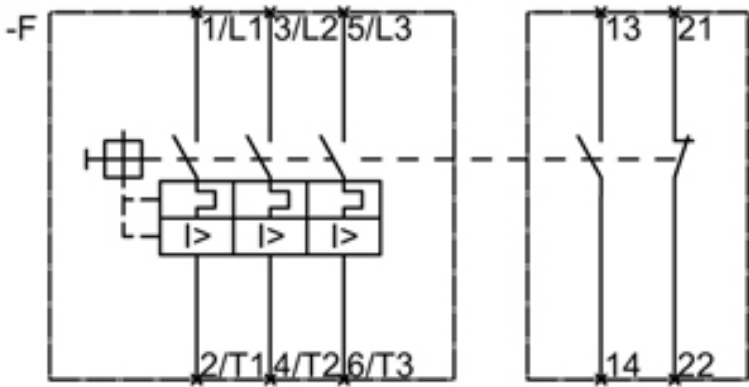

last change:

Feb 14, 2013