



CIRCUIT-BREAKER SZ S00,
FOR PLANT PROTECTION,
WITH APPROBATION CIRCUIT-BREAKER UL 489. CSA
C22.2 NO.5-02. A-RELEASE 1.25 A,
N-RELEASE 16 A, SCREW CONNECTION,
STANDARD SW. CAPACITY

General technical data:	
product brand name	SIRIUS
Product designation	3RV2 circuit breaker
Size of the circuit-breaker	S00
Number of poles / for main current circuit	3
Product function	
• short circuit protection	Yes
• overload protection	Yes
• phase disturbance recognition	No
• plant protection	Yes
• motor protection	Yes
• motor protection with relais overload functionality	No
• starter protection	No
• transformer protection	No
• disconnecter functionality	Yes
• main control switches with supply disconnect function and EM-STOP switches	No
Design of the operating mechanism	selector switch
Product component	
• auxiliary switch	No
• undervoltage release mechanism	No

• trip indicator		No
Product extension		
• auxiliary switch		Yes
• optional / motor drive		No
Insulation voltage / with degree of pollution 3 / rated value	V	690
Impulse voltage resistance / rated value	kV	6
Protection class IP		
• of the terminal		IP20
• on the front		IP20
Protection against electrical shock		finger-safe
Installation altitude / at a height over sea level / maximum	m	2,000
Relative humidity		
• during operating phase	%	10 ... 95
Ambient temperature		
• during transport	°C	-50 ... +80
• during storage	°C	-50 ... +80
• during operating	°C	-20 ... +60
Shock resistance / according to IEC 60068-2-27		25g / 11 ms
Usage category		
• according to IEC 60947-4-1		AC-3
Active power loss / total / typical	W	5.4

Main circuit:

Operating voltage / rated value	V	690
Voltage type / for main circuit		AC/DC
Operating frequency		
• rated value	Hz	50 ... 60

Protective and monitoring functions:

Varification of suitability / ATEX		No
Design of the overload circuit breaker		thermal
Design of the short-circuit trip		magnetic
Operational short-circuit current breaking capacity (Ics) / with AC		
• at 240 V / rated value	kA	100
• at 400 V / rated value	kA	100
• at 500 V / rated value	kA	100
• at 690 V / rated value	kA	100
Breaking capacity maximum short-circuit current (Icu)		
• at 240 V / for AC / rated value	kA	100

<ul style="list-style-type: none"> • at 400 V / for AC / rated value • at 500 V / for AC / rated value • at 690 V / for AC / rated value 	kA	100
	kA	100
	kA	100
Design of fuse insert / for IT network / for short-circuit protection of the main circuit <ul style="list-style-type: none"> • at 500 V • at 690 V 		gL/gG 16 A gL/gG 16 A
Breaking capacity short-circuit current (I_{cn}) <ul style="list-style-type: none"> • with 1 current path / at 150 V / for DC / rated value • with 2 current paths in series / at 300 V / for DC / rated value • with 3 current paths in series / at 450 V / for DC / rated value 	kA	10
	kA	10
	kA	10

Installation/ mounting/ dimensions:

Mounting type		screw and snap-on mounting onto 35 mm standard mounting rail according to DIN EN 60715
mounting position		any
Depth	mm	97
Height	mm	144
Width	mm	45

Connections/ terminals:

Arrangement of electrical connectors / for main current circuit		Top and bottom
Design of the electrical connection / for main current circuit		screw-type terminals
Type of the connectable conductor cross-section <ul style="list-style-type: none"> • for main contacts <ul style="list-style-type: none"> • solid or multi-stranded • finely stranded <ul style="list-style-type: none"> • with conductor end processing • for AWG conductors / for main contacts 		1 ... 10 mm ² , max. 2x 10 mm ² 1 ... 16 mm ² , max. 6 + 16 mm ² 2x 14

UL/CSA ratings:

Operating voltage / according to UL 60947 / rated value	V	600
Breaking capacity limit short-circuit current (I_{cu}) / at 480 AC Y/277 V / according to UL 489 / rated value	A	65,000

Certificates/ approvals:

General Product Approval**Declaration of Conformity**

CCC



CSA



UL



EG-Konf.

Test Certificates[Special Test Certificate](#)[Type Test Certificates/Test Report](#)**Shipping Approval**

ABS

BUREAU
VERITAS

GL



LRS



PRS



RINA

Shipping Approval**other**

RMRS

[Confirmation](#)

VDE

[other](#)[Environmental Confirmations](#)**Further information:****Information- and Downloadcenter (Catalogs, Brochures,...)**<http://www.siemens.com/industrial-controls/catalogs>**Industry Mall (Online ordering system)**<http://www.siemens.com/industrymall>**Cax online generator**<http://www.siemens.com/cax>**Service&Support (Manuals, Certificates, Characteristics, FAQs,...)**<http://support.automation.siemens.com/WW/view/en/3RV2711-0KD10/all>**Image database (product images, 2D dimension drawings, 3D models, device circuit diagrams, ...)**http://www.automation.siemens.com/bilddb/cax_en.aspx?mlfb=3RV2711-0KD10

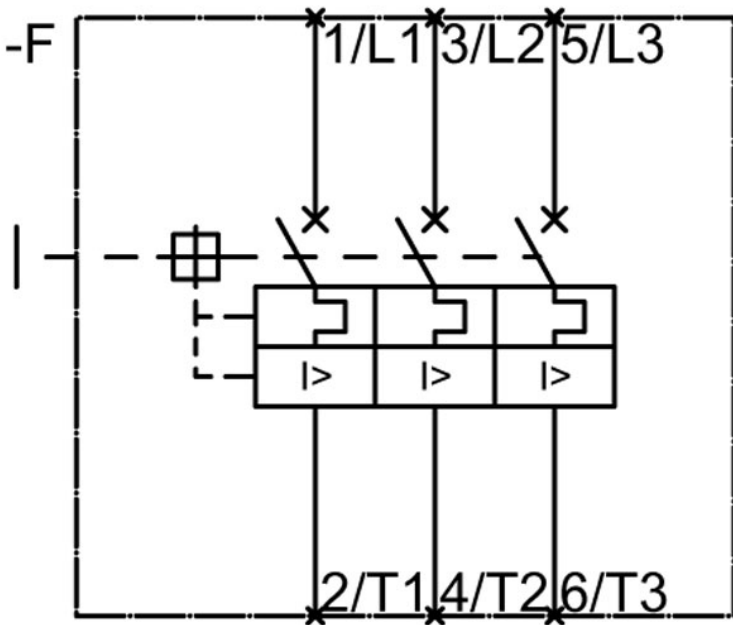
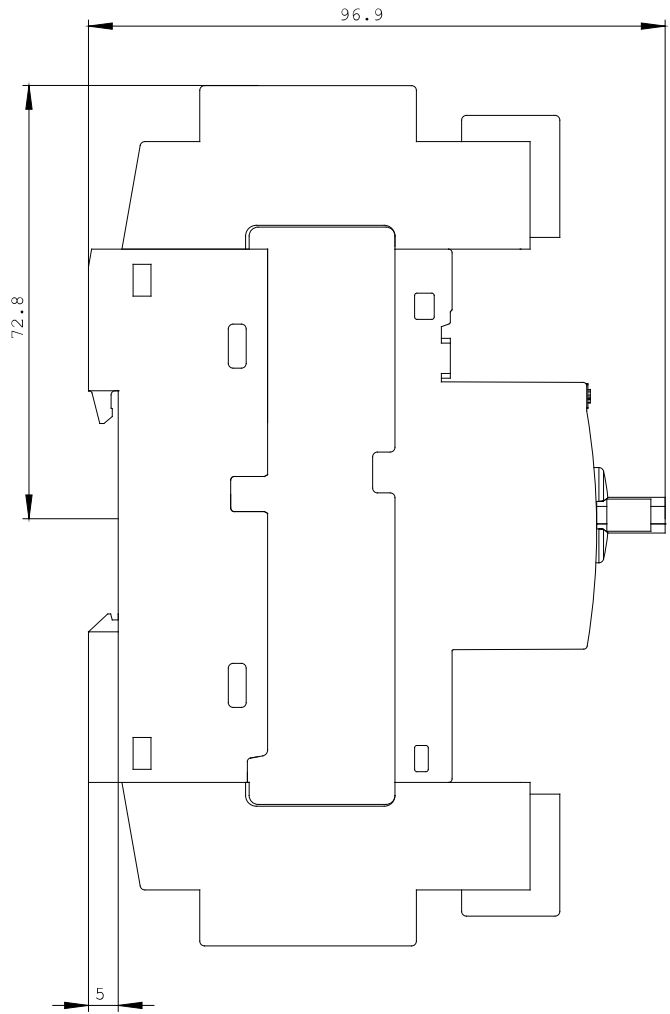
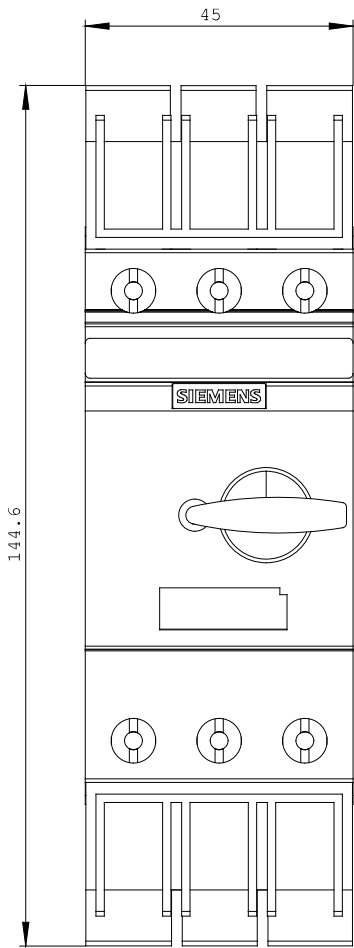

last change:

Aug 4, 2014