



CIRCUIT-BREAKER SZ S00,  
FOR TRANSFORMER PROTECTION,  
WITH APPROBATION CIRCUIT-BREAKER UL 489. CSA  
C22.2 NO.5-02. A-RELEASE 0.2 A,  
N-RELEASE 4.2 A, SCREW CONNECTION,  
STANDARD SW. CAPACITY

**General technical data:**

<b>product brand name</b>		SIRIUS
<b>Product designation</b>		3RV2 circuit breaker
<b>Size of the circuit-breaker</b>		S00
<b>Number of poles / for main current circuit</b>		3
<b>Product function</b>		
• short circuit protection		Yes
• overload protection		Yes
• phase disturbance recognition		No
• plant protection		No
• motor protection		No
• motor protection with relais overload functionality		No
• starter protection		No
• transformer protection		Yes
• disconnecter functionality		Yes
• main control switches with supply disconnect function and EM-STOP switches		No
<b>Design of the operating mechanism</b>		selector switch
<b>Product component</b>		
• auxiliary switch		No
• undervoltage release mechanism		No

• trip indicator		No
<b>Product extension</b>		
• auxiliary switch		Yes
• optional / motor drive		No
<b>Insulation voltage / with degree of pollution 3 / rated value</b>	V	690
<b>Impulse voltage resistance / rated value</b>	kV	6
<b>Protection class IP</b>		
• of the terminal		IP20
• on the front		IP20
<b>Protection against electrical shock</b>		finger-safe
<b>Installation altitude / at a height over sea level / maximum</b>	m	2,000
<b>Relative humidity</b>		
• during operating phase	%	10 ... 95
<b>Ambient temperature</b>		
• during transport	°C	-50 ... +80
• during storage	°C	-50 ... +80
• during operating	°C	-20 ... +60
<b>Shock resistance / according to IEC 60068-2-27</b>		25g / 11 ms
<b>Active power loss / total / typical</b>	W	5.3

#### Main circuit:

<b>Operating voltage / rated value</b>	V	690
<b>Voltage type / for main circuit</b>		AC/DC
<b>Operating frequency</b>		
• rated value	Hz	50 ... 60

#### Protective and monitoring functions:

<b>Varification of suitability / ATEX</b>		No
<b>Design of the overload circuit breaker</b>		thermal
<b>Adjustable response current / of the current-dependent overload release</b>	A	0.2 ... 0.2
<b>Design of the short-circuit trip</b>		magnetic
<b>Operational short-circuit current breaking capacity (Ics) / with AC</b>		
• at 240 V / rated value	kA	100
• at 400 V / rated value	kA	100
• at 500 V / rated value	kA	100
• at 690 V / rated value	kA	100
<b>Breaking capacity maximum short-circuit current (Icu)</b>		
• at 240 V / for AC / rated value	kA	100
• at 400 V / for AC / rated value	kA	100

• at 500 V / for AC / rated value	kA	100
• at 690 V / for AC / rated value	kA	100
<b>Breaking capacity short-circuit current (I<sub>cn</sub>)</b>		
• with 1 current path / at 150 V / for DC / rated value	kA	10
• with 2 current paths in series / at 300 V / for DC / rated value	kA	10
• with 3 current paths in series / at 450 V / for DC / rated value	kA	10

Installation/ mounting/ dimensions:		
<b>Mounting type</b>		screw and snap-on mounting onto 35 mm standard mounting rail according to DIN EN 60715
<b>mounting position</b>		any
<b>Depth</b>	mm	97
<b>Height</b>	mm	144
<b>Width</b>	mm	45

Connections/ terminals:		
<b>Arrangement of electrical connectors / for main current circuit</b>		Top and bottom
<b>Design of the electrical connection / for main current circuit</b>		screw-type terminals
<b>Type of the connectable conductor cross-section</b>		
• for main contacts		
• solid or multi-stranded		1 ... 10 mm <sup>2</sup> , max. 2x 10 mm <sup>2</sup>
• finely stranded		
• with conductor end processing		1 ... 16 mm <sup>2</sup> , max. 6 + 16 mm <sup>2</sup>
• for AWG conductors / for main contacts		2x 14

UL/CSA ratings:		
<b>Operating voltage / according to UL 60947 / rated value</b>	V	600
<b>Breaking capacity limit short-circuit current (I<sub>cu</sub>) / at 480 AC Y/277 V / according to UL 489 / rated value</b>	A	65,000

**Certificates/ approvals:**

**General Product Approval****Declaration of Conformity****Test Certificates**[Special Test Certificate](#)[Type Test Certificates/Test Report](#)**Shipping Approval**

ABS

BUREAU  
VERITAS

GL

LRS

PRS

RINA

**Shipping Approval**

other

[Confirmation](#)[other](#)[Environmental Confirmations](#)

RMRS

VDE

**Further information:****Information- and Downloadcenter (Catalogs, Brochures,...)**<http://www.siemens.com/industrial-controls/catalogs>**Industry Mall (Online ordering system)**<http://www.siemens.com/industrymall>**Cax online generator**<http://www.siemens.com/cax>**Service&Support (Manuals, Certificates, Characteristics, FAQs,...)**<http://support.automation.siemens.com/WW/view/en/3RV2811-0BD10/all>**Image database (product images, 2D dimension drawings, 3D models, device circuit diagrams, ...)**[http://www.automation.siemens.com/bilddb/cax\\_en.aspx?mlfb=3RV2811-0BD10](http://www.automation.siemens.com/bilddb/cax_en.aspx?mlfb=3RV2811-0BD10)

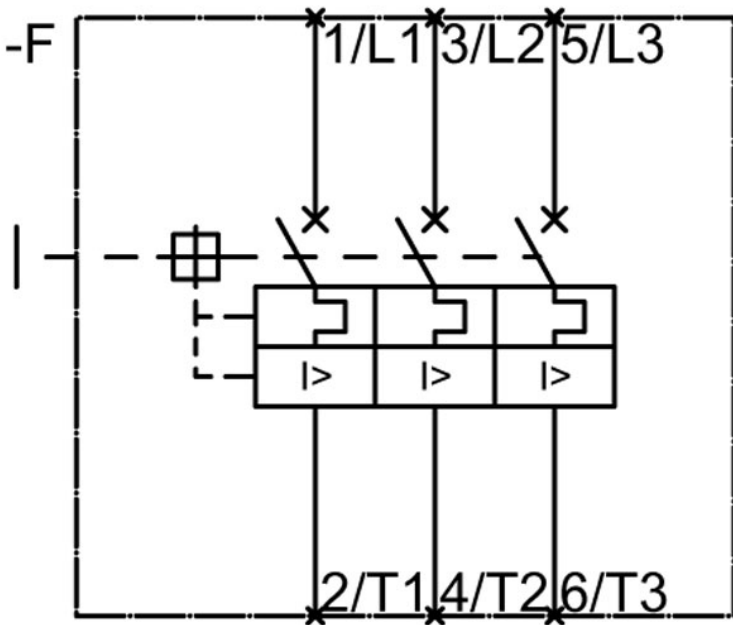
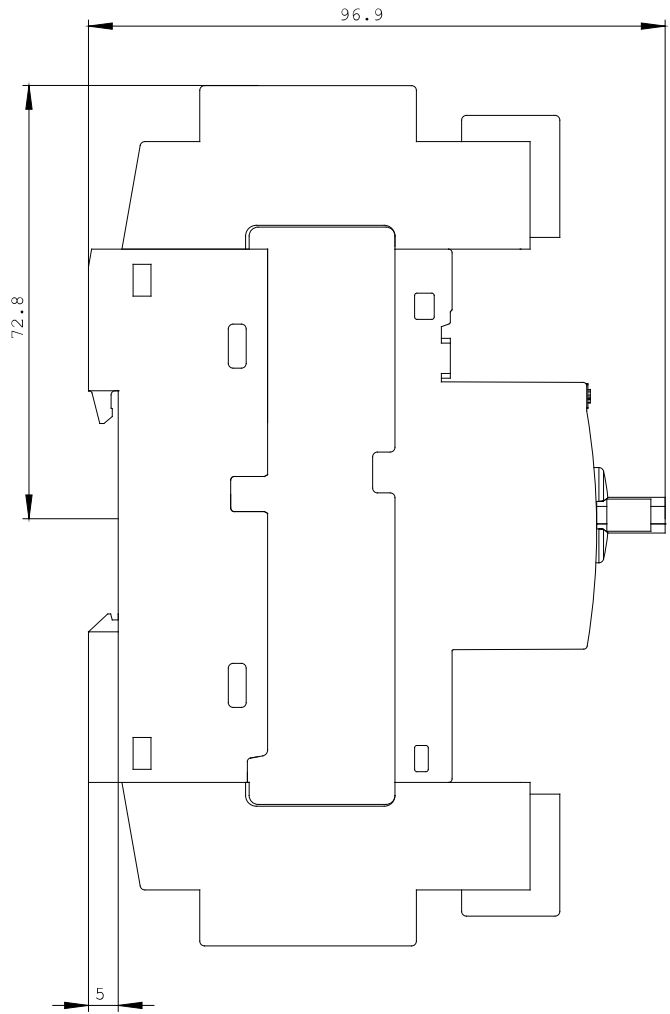
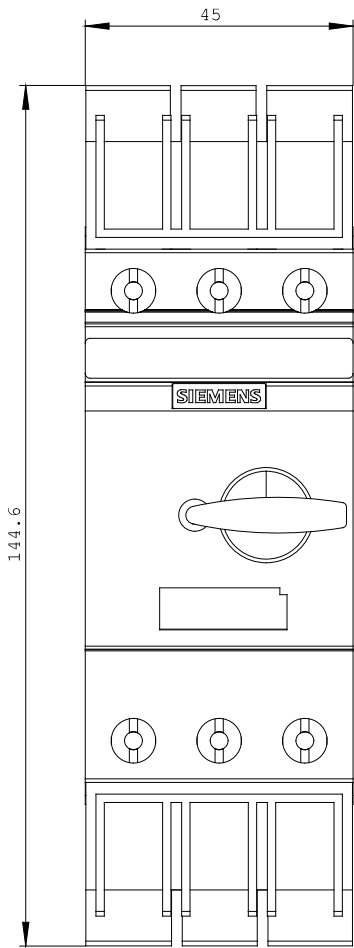

last change:

Jul 28, 2014