



SIRIUS SOFT STARTER, VALUES AT 500V, 40DEG., STANDARD: 615A, 400KW, INSIDE-DELTA CIRCUIT 3: 1065A, 710KW, 400-600V AC, 230V AC, SCREW TERMINALS

General details:

product brand name		SIRIUS
Product equipment		
• integrated bridging contact system		Yes
• thyristors		Yes
Product function		
• intrinsic device protection		Yes
• motor overload protection		Yes
• evaluation of thermal resistor motor protection		Yes
• reset external		Yes
• adjustable current limitation		Yes
• inside-delta circuit		Yes
Product component / outlet for enine brake		Yes
Item designation		
• according to DIN EN 61346-2		Q
• according to DIN 40719 extendable after IEC 204-2 / according to IEC 750		G

Power Electronics:

product designation		soft starters for high feature applications
Operating current		

• at 40 °C / rated value	A	615
• at 50 °C / rated value	A	551
• at 60 °C / rated value	A	489
• for three-phase servomotors / at 3-phase root switching		
• at 40 °C / rated value	A	1,065
• at 50 °C / rated value	A	954
• at 60 °C / rated value	A	847
Emitted mechanical power / for three-phase servomotors		
• at 400 V / at standard switching / at 40 °C		
• rated value	W	355,000
• at 500 V / at standard switching / at 40 °C		
• rated value	W	400,000
• at 400 V / at 3-phase root switching / at 40 °C		
• rated value	W	630,000
• at 500 V / at 3-phase root switching / at 40 °C		
• rated value	W	710,000
Operating frequency		
• rated value	Hz	50 ... 60
Relative negative tolerance / of the operating frequency	%	-10
Relative positive tolerance / of the operating frequency	%	10
Operating voltage / with standard circuit / rated value	V	400 ... 600
Relative negative tolerance / of the operating voltage / with standard circuit	%	-15
Relative positive tolerance / of the operating voltage / with standard circuit	%	10
Operating voltage / at 3-phase root switching / rated value	V	400 ... 600
Relative negative tolerance / of the operating voltage / with inside-delta circuit	%	-15
Relative positive tolerance / of the operating voltage / with inside-delta circuit	%	10
Minimum load in % of I_M	%	8
Adjustable rated current / of the motor / for motor overload protection / minimum	A	123
Continuous operating current in % of I_e / at 40°C	%	115
Active power loss / at operating current / at 40°C / during operating phase / typical	W	186
Control electronics:		
Type of voltage / of the controlled supply voltage		AC
Control supply voltage frequency / 1 / rated value	Hz	50
Control supply voltage frequency / 2 / rated value	Hz	60

Relative negative tolerance / of the control supply voltage frequency	%	-10
Relative positive tolerance / of the control supply voltage frequency	%	10
Control supply voltage / 1		
• at 50 Hz / for AC	V	230
• at 60 Hz / for AC	V	230
Relative negative tolerance / of the control supply voltage / at 60 Hz / for AC	%	-15
Relative positive tolerance / of the control supply voltage / at 60 Hz / for AC	%	10
Type of display / for fault signal		Display

Mechanical design:		
Width	mm	510
Height	mm	640
Depth	mm	290
Type of mounting		screw fixing
mounting position		bei senkrechter Montageebene +/-90° drehbar, bei senkrechter Montageebene +/- 22,5° nach vorne und hinten kippbar
Distance, to be maintained, to the ranks assembly		
• upwards	mm	100
• sideways	mm	5
• downwards	mm	75
Installation altitude / at a height over sea level	m	5,000
Cable length / maximum	m	500
Number of poles / for main current circuit		3

Electrical connections:		
Design of the electrical connection		
• for main current circuit		busbar connection
• for auxiliary and control current circuit		screw-type terminals
Number of NC contacts / for auxiliary contacts		0
Number of NO contacts / for auxiliary contacts		3
Number of change-over switches / for auxiliary contacts		1
Type of the connectable conductor cross-section / for DIN cable lug / for main contacts		
• finely stranded		50 ... 240 mm ²
• stranded		70 ... 240 mm ²
Type of the connectable conductor cross-section		
• for AWG conductors / for main contacts		2/0 ... 500 kcmil
Type of the connectable conductor cross-section		

- for auxiliary contacts
 - solid
 - finely stranded / with conductor end processing
- for AWG conductors / for auxiliary contacts
 - finely stranded / with wire end proc

	2x (0.5 ... 2.5 mm ²)
	2x (0.5 ... 1.5 mm ²)
	2x (20 ... 14)
	2x (20 ... 16)

Ambient conditions:

Ambient temperature

- during operating
- during storage

/ °C	60
°C	-25 ... +80

Derating temperature

°C	40
----	----

Protection class IP

IP00

Certificates/approvals:

General Product Approval

EMC

Shipping Approval



CCC



CSA



GOST



UL



C-TICK



LRS

other

[Declaration of Conformity](#)

[Environmental Confirmations](#)

UL/CSA ratings

yielded mechanical performance (hp) / for three-phase squirrel cage motors

- at 460/480 V / at standard circuit
 - at 50 °C / rated value
- at 575/600 V / at standard circuit
 - at 50 °C / rated value
- at 460/480 V / at inside-delta circuit / at 50 °C / rated value
- at 575/600 V / at inside-delta circuit / at 50 °C / rated value

hp	450
hp	600
hp	850
hp	1,050

Contact rating designation / for auxiliary contacts / according to UL

B300 / R300

Further information:

Information- and Downloadcenter (Catalogs, Brochures,...)

<http://www.siemens.com/industrial-controls/catalogs>

Industry Mall (Online ordering system)

<http://www.siemens.com/industrial-controls/mall>

CAx-Online-Generator

<http://www.siemens.com/cax>

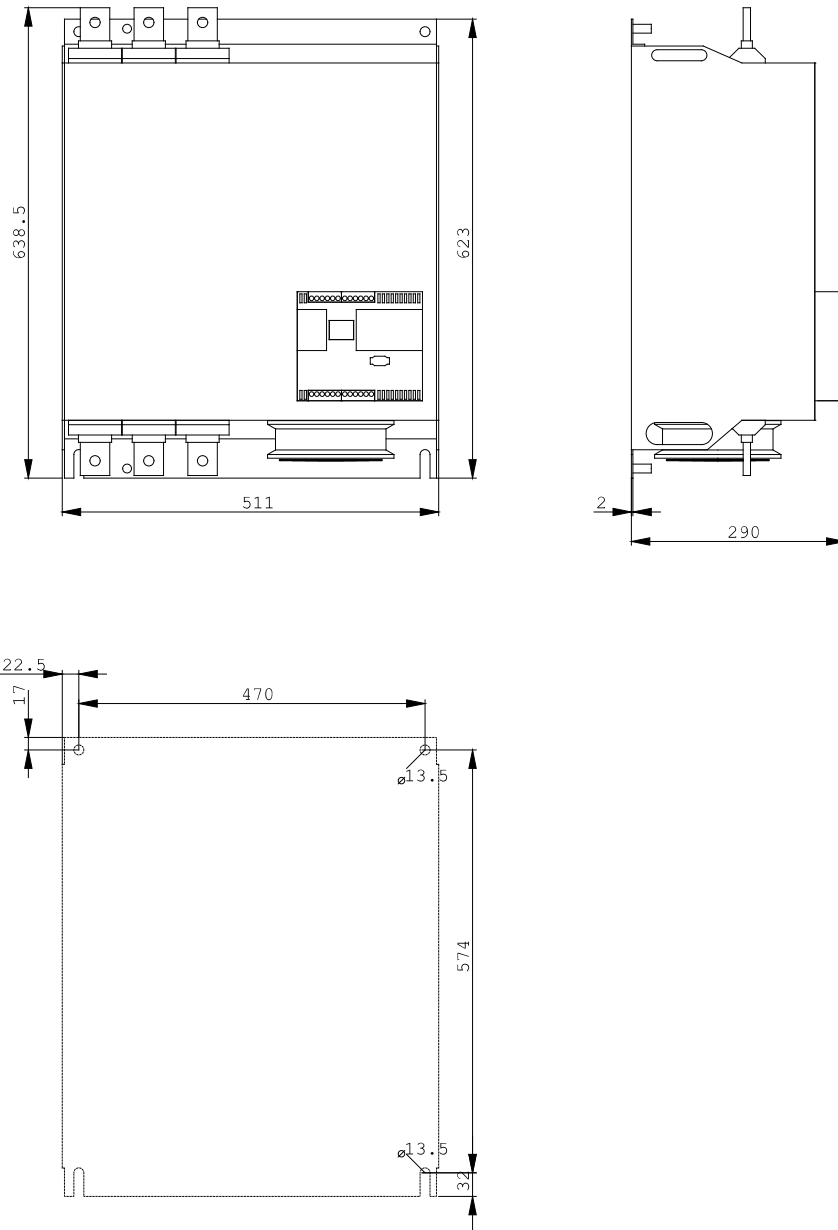

last change:

Feb 7, 2013