

COMPONENT FOR ENCLOSURE,
22MM LAMP HOLDER BA 9S WITH INTEGRATED
VOLTAGE REDUCER WITH LAMP 130V,
3SX1731 RATED VOLTAGE 230/240V AC SCREW
TERMINAL CLEAR

Contact block / lampholder		
product designation		lampholder
Number of NC contacts / for auxiliary contacts		0
Number of NO contacts / for auxiliary contacts		0
Number of change-over switches / for auxiliary contacts		0
Product function / positive opening		No
Number of lampholders		1
Execution of the mounting		BA 9s
Nature of fluorescent material		filament lamp
Design of the electrical connection		screw-type terminals

General technical details:		
Degree of pollution		class 3
Design of the fuse link / for short-circuit protection of the auxiliary switch / with type of assignment 1 / required		gG / Dz 10 A
Type of voltage / of the supply voltage / of the fluorescent material		AC
Supply voltage / 1 / of the fluorescent material		
<ul style="list-style-type: none"> at 60 Hz / for AC / rated value 	V	130
<ul style="list-style-type: none"> at 50 Hz / for AC / rated value 	V	130
Type of voltage / of the operating voltage		AC/DC
Item designation		
<ul style="list-style-type: none"> according to DIN EN 61346-2 		P
<ul style="list-style-type: none"> according to DIN 40719 extendable after IEC 204-2 / according to IEC 750 		H
Ambient temperature		
<ul style="list-style-type: none"> during operating 	°C	-25 ... +60
<ul style="list-style-type: none"> during storage 	°C	-25 ... +80
protection class IP		
<ul style="list-style-type: none"> of the terminal 		IP20
<ul style="list-style-type: none"> of the housing 		IP40
Suitability for integration		front element

• pressure selection button		Yes
• front element		Yes
• suspension switch		Yes
• suspension pushbutton		Yes
Insulation voltage / rated value	V	250
Impulse voltage resistance / rated value	kV	4
Tightening torque / for auxiliary contacts / with screw-type terminals	N·m	0.8
Product component		
• fluorescent materials		Yes
• diode		No
• lamp transformer		No
• series resistance		Yes
Type of mounting		floor mounting

Connections:

Type of the connectable conductor cross-section

- for auxiliary contacts / solid
- for auxiliary contacts / solid / with conductor end processing
- for auxiliary contacts / finely stranded / with conductor end processing
- for AWG conductors / for auxiliary contacts

2x (1 ... 1.5 mm²)
2x (0.5 ... 0.75 mm²)
2x (0.5 ... 1.5 mm²)
2x (18 ... 14)

Certificates/approvals:

General Product Approval



CCC



CSA



GOST



UL

other

[Confirmation](#)

[Environmental Confirmations](#)

Further information:

Information- and Downloadcenter (Catalogs, Brochures,...)

<http://www.siemens.com/industrial-controls/catalogs>

Industry Mall (Online ordering system)

<http://www.siemens.com/industrial-controls/mall>

Cax online generator:

<http://www.siemens.com/cax>

Service&Support (Manuals, Certificates, Characteristics, FAQs,...)

<http://support.automation.siemens.com/WW/view/en/3SB3420-1C/all>

Image database (product images, 2D dimension drawings, 3D models, device circuit diagrams, ...)

http://www.automation.siemens.com/bilddb/cax_en.aspx?mlfb=3SB3420-1C

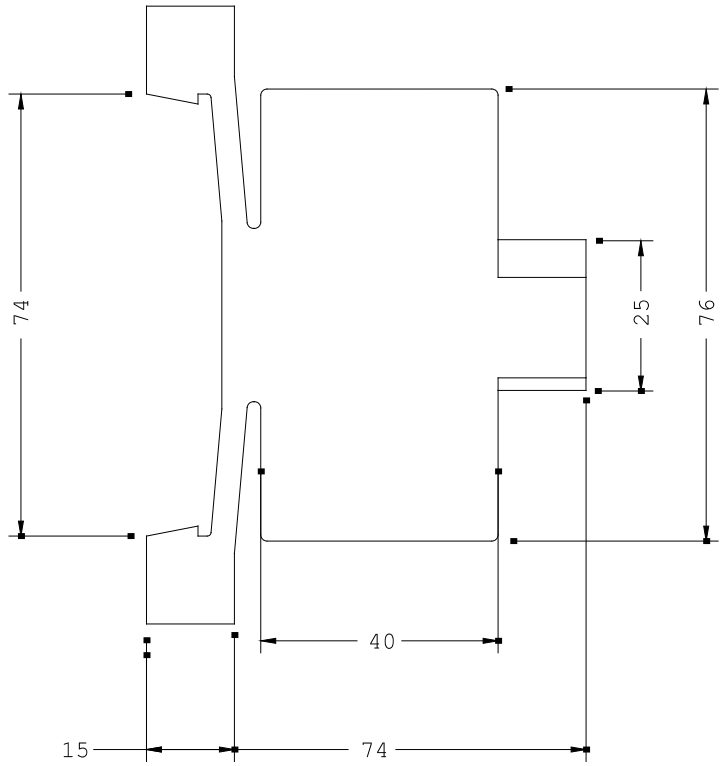
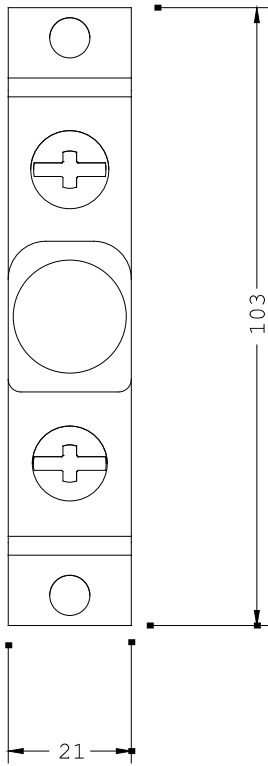

last change:

Jan 21, 2013