



SAFETY POSITION SWITCHES WITH SOLENOID INTERLOCKING LOCK. FORCE 2600N;5 APPR. DIR. METAL HOUSING,3X(M20X1.5) MAGNETIC FIELD LOCKED, MAGNET VOLTAGE 115V AC, MONITOR. OF ACTUATOR 2NC/1NO, MONITOR. OF MAGNET 2NC/1NO LEDS YELLOW/GREEN

General technical details:

| | | |
|--|---|---------|
| Explosion protection category for dust | | none |
| Supply voltage | | |
| • of the magnet coil | V | 115 |
| Type of voltage / of the supply voltage | | |
| • of the optional LED display | | AC |
| Relative ON period | | |
| • of the magnet coil | % | 100 |
| Recorded real power | | |
| • of the magnet coil | W | 3.5 |
| Insulation voltage | | |
| • rated value | V | 250 |
| Degree of pollution | | class 3 |
| Thermal current | A | 6 |
| Operating current | | |
| • at AC-15 | | |
| • at 24 V / rated value | A | 6 |
| • at 125 V / rated value | A | 3 |
| • at 230 V / rated value | A | 1.5 |
| • at DC-13 | | |

| | | |
|---|-----|--------------------------|
| <ul style="list-style-type: none"> • at 24 V / rated value | A | 3 |
| <ul style="list-style-type: none"> • at 125 V / rated value | A | 0.55 |
| <ul style="list-style-type: none"> • at 230 V / rated value | A | 0.27 |
| Continuous current | | |
| <ul style="list-style-type: none"> • of the slow DIAZED fuse link | A | 6 |
| <ul style="list-style-type: none"> • of the quick DIAZED fuse link | A | 10 |
| <ul style="list-style-type: none"> • of the C characteristic circuit breaker | A | 0.5 |
| Mechanical operating cycles as operating time / typical | | 1,000,000 |
| Electrical operating cycles as operating time | | |
| <ul style="list-style-type: none"> • with contactor 3RH11, 3RT1016, 3RT1017, 3RT1024, 3RT1025, 3RT1026 / typical | | 1,000,000 |
| Electrical operating cycles in one hour | | |
| <ul style="list-style-type: none"> • with contactor 3RH11, 3RT1016, 3RT1017, 3RT1024, 3RT1025, 3RT1026 | | 6,000 |
| Repeat accuracy | mm | 0.05 |
| Design of the contact element | | slow-action contacts |
| Number of NC contacts | | |
| <ul style="list-style-type: none"> • for the position surveillance of the locking element | | 2 |
| Number of NC contacts | | |
| <ul style="list-style-type: none"> • for the position surveillance of the activation element | | 2 |
| Number of NO contacts | | |
| <ul style="list-style-type: none"> • for the position surveillance of the locking element | | 1 |
| Number of NO contacts | | |
| <ul style="list-style-type: none"> • for the position surveillance of the activation element | | 1 |
| Design of the switching function | | positive opening |
| Resistance against vibration | | 0.35 mm / 5g |
| Resistance against shock | | 30g / 11 ms |
| Ambient temperature | | |
| <ul style="list-style-type: none"> • during operating | °C | -25 ... +60 |
| <ul style="list-style-type: none"> • during storage | °C | -40 ... +80 |
| Width of the sensor | mm | 54 |
| Material | | |
| <ul style="list-style-type: none"> • of the enclosure | | metal |
| Material / of the housing / of the switch head | | metal |
| Design of the operating mechanism | | 5 directions of approach |
| Actuating speed | m/s | 0.4 ... 1.5 |
| Minimum actuating force | N | 30 |
| Protection class IP | | IP66/IP67 |
| mounting position | | any |
| Cable gland version | | 3 x (M20 x 1.5) |

| | | |
|---|---|----------------------|
| Design of the electrical connection | | screw-type terminals |
| Item designation | | |
| <ul style="list-style-type: none"> • according to DIN 40719 extendable after IEC 204-2 / according to IEC 750 • according to DIN EN 61346-2 | S | |
| | B | |

Certificates/approvals:

| | | |
|---------------------------------|--|----------------------------------|
| General Product Approval | Functional Safety / Safety of Machinery | Declaration of Conformity |
|---------------------------------|--|----------------------------------|



CCC



GOST



UL



VDE



VDE



EG-Konf.

other

[Confirmation](#)

Further information:

Information- and Downloadcenter (Catalogs, Brochures,...)

<http://www.siemens.com/industrial-controls/catalogs>

Industry Mall (Online ordering system)

<http://www.siemens.com/industrial-controls/mall>

Cax online generator:

<http://www.siemens.com/cax>

Service&Support (Manuals, Certificates, Characteristics, FAQs,...)

<http://support.automation.siemens.com/WW/view/en/3SE5312-2SB12/all>

Image database (product images, 2D dimension drawings, 3D models, device circuit diagrams, ...)

http://www.automation.siemens.com/bilddb/cax_en.aspx?mlfb=3SE5312-2SB12

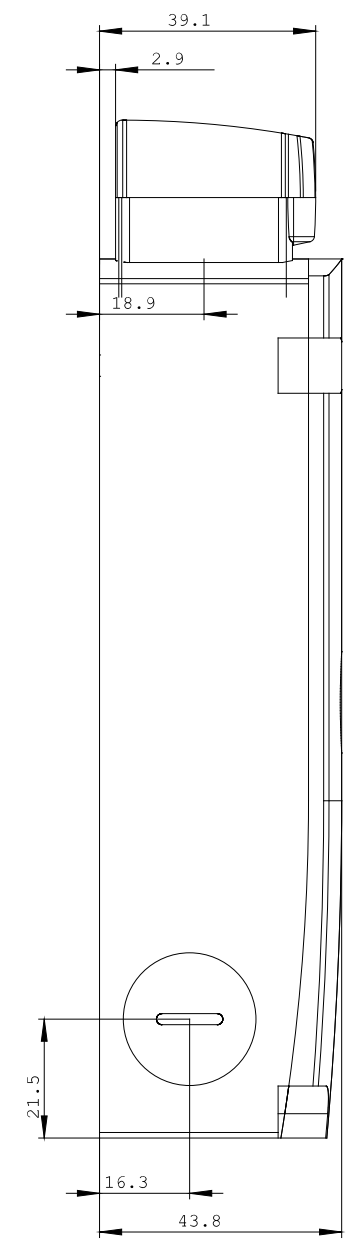
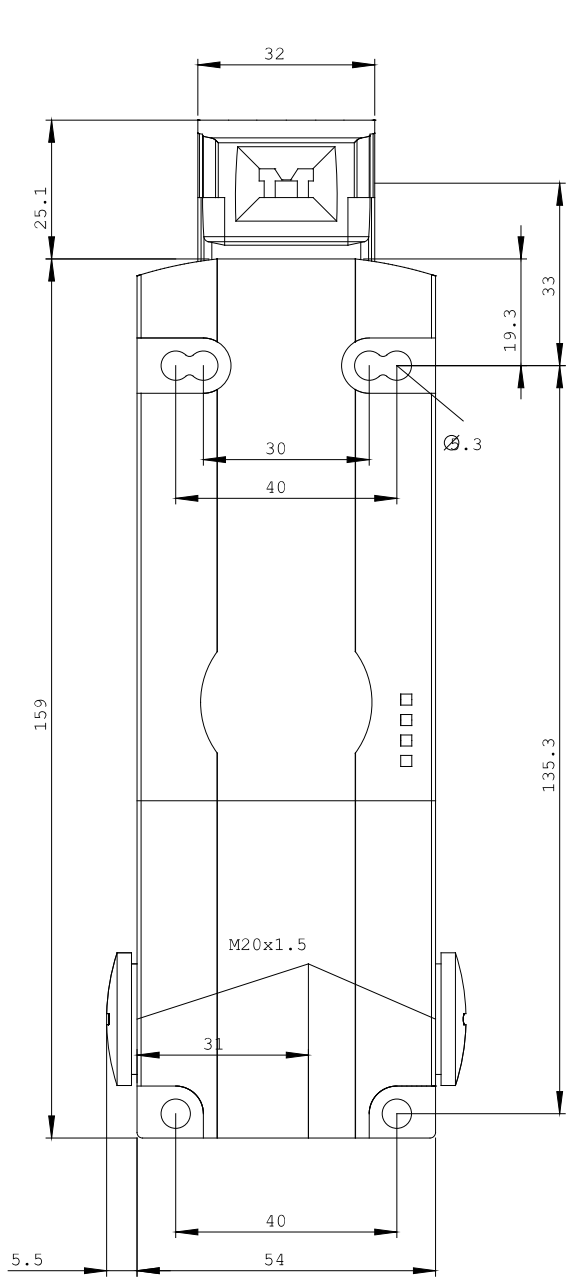

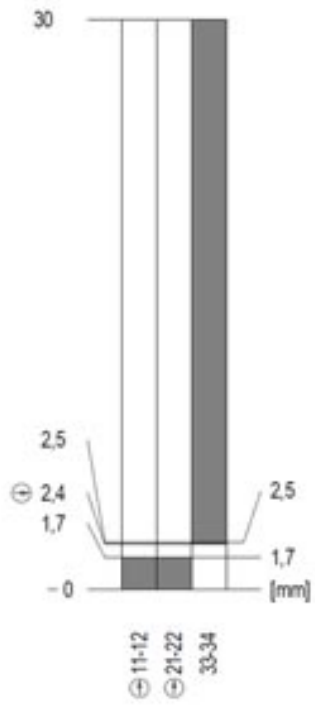

last change:

Jan 21, 2013