



CONTACTOR RELAY 55E EN 50 011 5NO+5NC,  
SCREW TERMINALS DC OPERATION DC SOLENOID  
SYSTEM DC 180V

General details:		
<b>Size of the contactor</b>		0
<b>Ambient temperature</b>		
• during operating	°C	-25 ... +55
<b>Protection class IP / on the front</b>		IP20
<b>Reference code</b>		
• according to DIN 40719 extended according to IEC 204-2 / according to IEC 750		K
• according to DIN EN 61346-2		K
• according to DIN EN 81346-2		K
Control circuit:		
<b>Voltage type / of control feed voltage</b>		DC
<b>Control supply voltage</b>		
• for DC / rated value	V	180
Auxiliary circuit:		
<b>Operating current / at AC-15</b>		
• at 230 V / rated value	A	10
• at 400 V / rated value	A	6
<b>Identification number and letter for switching elements</b>		55 E

<b>Number of NC contacts / for auxiliary contacts</b>	5
• lagging switching	0
• delayed switching	0
• asynchronous switching	0
<b>Number of NO contacts / for auxiliary contacts</b>	5
• leading switching	0
• delayed switching	0
• asynchronous switching	0
<b>Number of changeover contacts / for auxiliary contacts</b>	0

#### Connection type:

**Design of the electrical connection / for auxiliary and control current circuit**

screw-type terminals

#### Mechanical design:

**Mounting type**

screw and snap-on mounting onto 35 mm standard mounting rail according to DIN EN 50022

**Width**

mm 55

**Height**

mm 78

**Depth**

mm 135

#### Certificates/approvals:

**General Product Approval**

**Functional Safety / Safety of Machinery**



[Type Examination](#)

#### Test Certificates

[other](#)

[Special Test Certificate](#)

[Type Test Certificates/Test Report](#)

#### Shipping Approval



[other](#)

[Declaration of Conformity](#)

[other](#)

[Environmental Confirmations](#)

#### Safety:

**Protection against electrical shock**

finger-safe

**B10 value / with high demand rate**

• according to SN 31920

1,000,000

• note

With 0.3 x I<sub>e</sub>

T1 value / for proof test interval or service life / according to IEC 61508

a

20

**Further information:**

**Information- and Downloadcenter (Catalogs, Brochures,...)**

<http://www.siemens.com/industrial-controls/catalogs>

**Industry Mall (Online ordering system)**

<http://www.siemens.com/industrial-controls/mall>

**Cax online generator**

<http://www.siemens.com/cax>

**Service&Support (Manuals, Certificates, Characteristics, FAQs,...)**

<http://support.automation.siemens.com/WW/view/en/3TH4355-0BK4/all>

**Image database (product images, 2D dimension drawings, 3D models, device circuit diagrams, ...)**

[http://www.automation.siemens.com/bilddb/cax\\_en.aspx?mlfb=3TH4355-0BK4](http://www.automation.siemens.com/bilddb/cax_en.aspx?mlfb=3TH4355-0BK4)

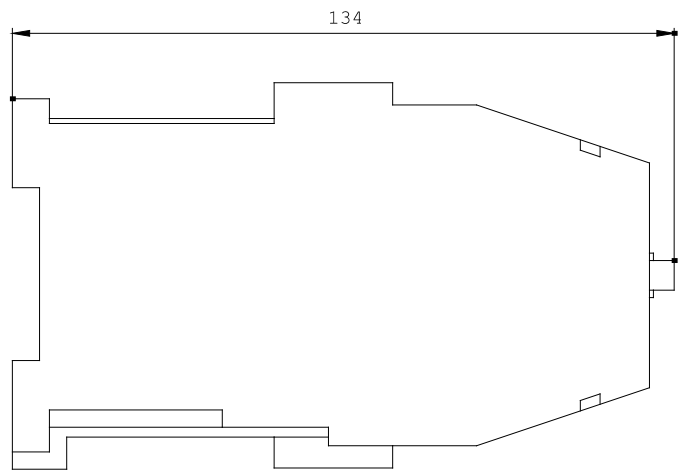
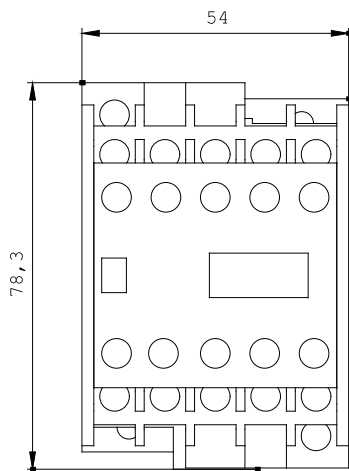

\W9.4444;  
\W9.25; 3TH439

**last change:**

Jun 16, 2014