

RESIDUAL CURRENT TRANSFORMER FOR RESIDUAL CURRENT MONITORING . .



Figure similar

General technical data:	
product brand name	SIRIUS
Product designation	Residual current transformer for fault current monitoring
Product feature Touch protection	Yes
Type of electrical connection at output	screw-type terminals
Operating voltage Rated value maximum	690 V
Continuous current per phase maximum	400 A
Fault current at input Rated value	40 A
Surge voltage resistance Rated value	6 kV
Equipment marking acc. to DIN EN 81346-2	B
Equipment marking acc. to DIN 40719 extended according to IEC 204-2 acc. to IEC 750	T
Equipment marking acc. to DIN EN 61346-2	B

Connections/ Terminals:	
Type of connectable conductor cross-section	
<ul style="list-style-type: none"> • solid • finely stranded <li style="padding-left: 20px;">— with core end processing • for AWG conductors 	<p>1x (0.5 ... 2.5 mm²)</p> <p>1x (0.5 ... 1.5 mm²)</p>

— solid

1x (20 ... 13)





Ambient conditions:

Ambient temperature	
• during transport	-25 ... +60 °C
• during operation	-25 ... +60 °C
• during storage	-40 ... +85 °C
Relative humidity during operation	95 %
Installation altitude at height above sea level	2 000 m

Installation/ mounting/ dimensions:

Diameter of feed through opening	110 mm
Width	163 mm
Height	64 mm
Depth	169 mm
mounting position	standing, on horizontal mounting surface
Mounting type	screw fixing
Tightening torque with screw-type terminals	0.5 ... 0.6 N·m
Tightening torque [lbf·in] with screw-type terminals	4.4 ... 5.3 lbf·in

Certificates/ approvals:

General Product Approval	Declaration of Conformity	Test Certificates
 CCC	 EAC	 UL
	 EG-Konf.	spezielle Prüfbescheinigung <u>n</u>

Further information

Information- and Downloadcenter (Catalogs, Brochures,...)

<http://www.siemens.com/industrial-controls/catalogs>

Industry Mall (Online ordering system)

<http://www.siemens.com/industrymall>

Cax online generator

<http://support.automation.siemens.com/WW/CAXorder/default.aspx?lang=en&mlfb=3UL23051A>

Service&Support (Manuals, Certificates, Characteristics, FAQs,...)

<https://support.industry.siemens.com/cs/ww/en/ps/3UL23051A>

Image database (product images, 2D dimension drawings, 3D models, device circuit diagrams, EPLAN macros, ...)

http://www.automation.siemens.com/bilddb/cax_de.aspx?mlfb=3UL23051A&lang=en

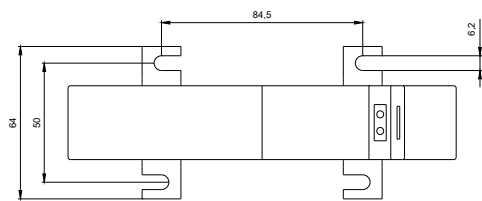
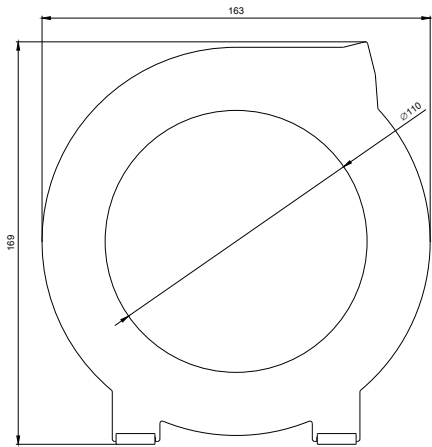

3UL2305-1A_ALL

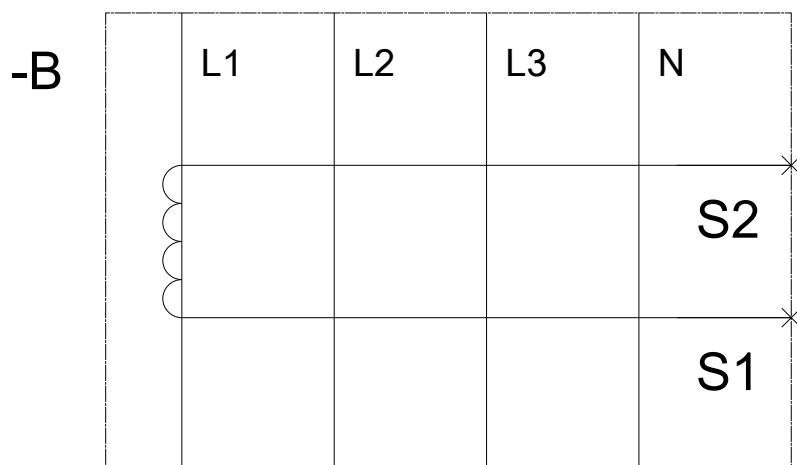

last modified:

17.07.2015