



SIGNALLING COLUMN SIREN ELEMENT,
MULTI-FUNCTION DIFFERENT SOUNDS SETTABLE 230V
AC

General technical details:		
product brand name		SIRIUS
product designation		signaling columns element, acoustic
Type of voltage		
<ul style="list-style-type: none"> of the supply voltage of the acoustic signal element 		AC
Consumed current / for rated value of supply voltage	mA	16
Supply voltage / 1 / of the acoustic signal element		
<ul style="list-style-type: none"> at 50 Hz / for AC / rated value at 60 Hz / for AC / rated value 	V	230
	V	230
Design of the acoustic signal type		continuous tone / pulse tone
Loudness level	dB	100
Item designation		
<ul style="list-style-type: none"> according to DIN 40719 extendable after IEC 204-2 / according to IEC 750 according to DIN EN 61346-2 		H
		P

Mechanical design:		
Color / of the housing		black
External diameter / of the signal column element	mm	70

Ambient conditions:

Ambient temperature • during operating	°C	-20 ... +50
Protection class IP		IP65
Product function / adjustable acoustic signal		Yes
Depth	mm	70
Height	mm	56
Width	mm	70

Certificates/approvals:

General Product Approval	EMC	Declaration of Conformity	Shipping Approval	
 GOST	 UL	 C-TICK	 EG-Konf.	 DNV

Further information:

Information- and Downloadcenter (Catalogs, Brochures,...)

<http://www.siemens.com/industrial-controls/catalogs>

Industry Mall (Online ordering system)

<http://www.siemens.com/industrial-controls/mall>

Cax online generator:

<http://www.siemens.com/cax>

Service&Support (Manuals, Certificates, Characteristics, FAQs,...)

<http://support.automation.siemens.com/WW/view/en/8WD4450-0EA2/all>

Image database (product images, 2D dimension drawings, 3D models, device circuit diagrams, ...)

http://www.automation.siemens.com/bilddb/cax_en.aspx?mlfb=8WD4450-0EA2

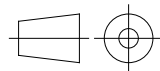
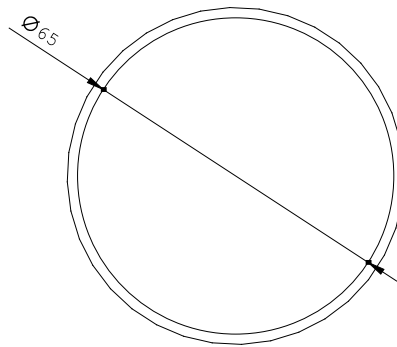
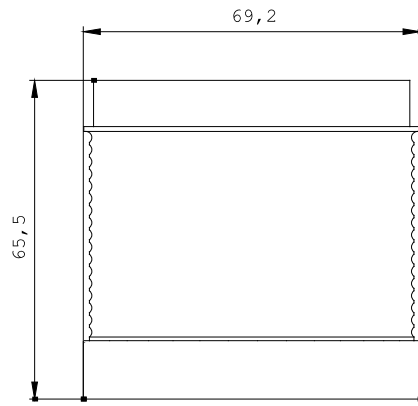

\W9.4444;
\W6.8333; 8WD44...-

last change:

Jan 23, 2013