

BUILT-IN LUMINAIRE FLASHLIGHT, 24V, RED



| General technical details: | | |
|--|----|------------|
| product designation | | flash lamp |
| Consumed current | mA | 125 |
| Type of voltage | | |
| • of the operating voltage | | AC/DC |
| • of the supply voltage / of the fluorescent material | | AC/DC |
| Operating frequency | | |
| • 1 / rated value | Hz | 50 |
| Operating voltage | | |
| • 1 / for DC / rated value | V | 24 |
| • 1 / at 50 Hz / for AC / rated value | V | 24 |
| Supply voltage / 1 / of the fluorescent material | | |
| • at 50 Hz / for AC / rated value | V | 24 |
| • for DC / rated value | V | 24 |
| Item designation | | |
| • according to DIN 40719 extendable after IEC 204-2 / according to IEC 750 | | H |
| • according to DIN EN 61346-2 | | P |

| Mechanical design: | | |
|--|--|-----|
| Product component / fluorescent materials | | Yes |

| | | |
|--|----|--------------|
| Type of mounting | | screw fixing |
| Material / of the enclosure | | thermoplast |
| Color / of the lens | | red |
| External diameter / of the signal column element | mm | 70 |

Lamp:

| | | |
|--------------------------------|----|------------------------------------|
| Design of the light | | lights with integrated flash lamps |
| Nature of fluorescent material | | flash light |
| Flash frequency | Hz | 1 |

Ambient conditions:

| | | |
|---------------------|----|-------------|
| Ambient temperature | | |
| • during operating | °C | -20 ... +50 |
| Protection class IP | | IP65 |
| Depth | mm | 75 |
| Height | mm | 96.5 |
| Width | mm | 75 |

Certificates/approvals:

General Product Approval

EMC

Declaration of Conformity



Further information:

Information- and Downloadcenter (Catalogs, Brochures,...)

<http://www.siemens.com/industrial-controls/catalogs>

Industry Mall (Online ordering system)

<http://www.siemens.com/industrial-controls/mall>

CAX-Online-Generator

<http://www.siemens.com/cax>

Service&Support (Manuals, Certificates, Characteristics, FAQs,...)

<http://support.automation.siemens.com/WW/view/en/8WD5320-0CB/all>

Image database (product images, 2D dimension drawings, 3D models, device circuit diagrams, ...)

http://www.automation.siemens.com/bilddb/cax_en.aspx?mlfb=8WD5320-0CB

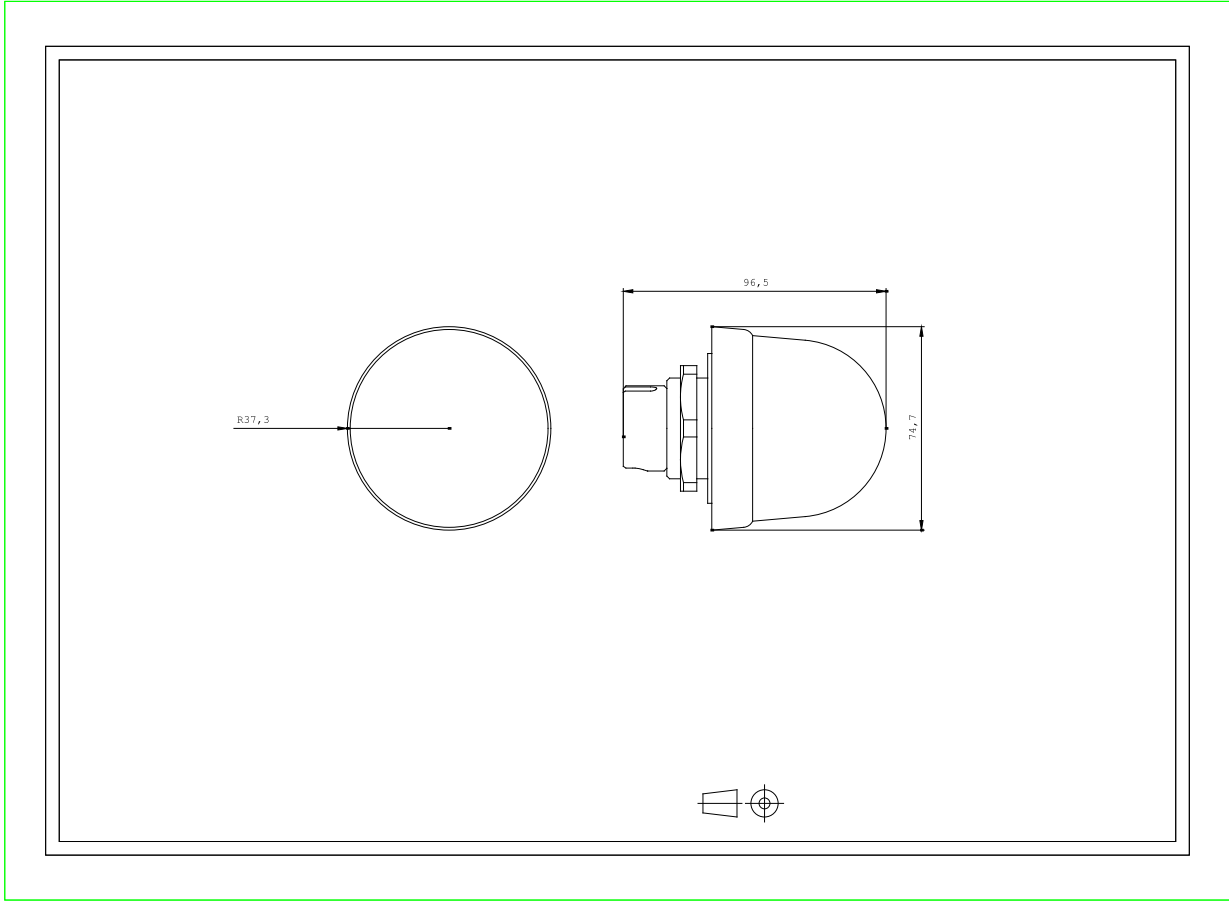

last change:

Jan 23, 2013